

Owner CONFER, BRIAN A. & OSLER, KATARINA E.
Address 2056 W 87 ST
 CLEVELAND, OH. 44102
Land Use (5100) R - 1-FAMILY PLATTED LOT
Legal Description 13 TAYLORPK 0078 ALL
Neighborhood Code 02113

SKETCH

MAP VIEW

Map Image

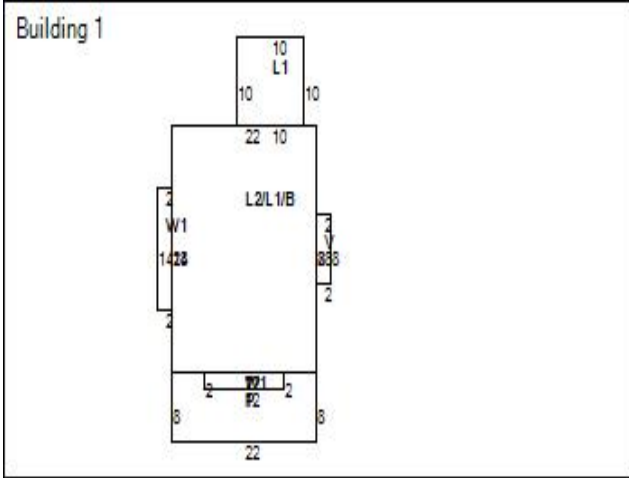

BUILDING INFORMATION

Building Record Number	1	Occupancy	1-FAMILY	Story Height	2
Style	COLONIAL	Year Built	1914	Exterior Walls	COMP-SIDING
Condition	AVERAGE	Construction Quality	C+ / AVERAGE+	Roof Type	GABLE
Roof Material	ASPH-SHINGLE	Heat Type	FORCED-AIR	Air Conditioning	NONE
Attic Type	UNFINISHED	Basement Type	BASEMENT	Basement Square Feet	616
Basement Finished	No	Rooms	6	Bedrooms	3
Bathrooms (Full/Half)	1/0	Garage Type	DETACHED	Garage Capacity	1
Year Garage Built	1914	Garage Size	280	Living Area Basement	
Living Area 1	767	Living Area 2	516	Living Area Upper	
Living Area Total	1,383	Floor Location		Party Wall	

LAND

VALUATION

Code	Frontage	Depth	Acreage	Sq Ft
PRM	35	118	0.1	4,130

2021 Values	Taxable Market Value	Exempt Market Value	Abated Market Value	Assessed Taxable Value
Land Value	\$12,600	\$0	\$0	\$4,410
Building Value	\$64,900	\$0	\$0	\$22,720
Total Value	\$77,500	\$0	\$0	\$27,130
Land Use	5100			SINGLE FAMILY DWELLING

PERMITS

IMPROVEMENTS

Tax Year	Reason	Tax Change	Exempt Change	Percent Complete	Reinspect	Notes
----------	--------	------------	---------------	------------------	-----------	-------

Type	Description	Size	Height Depth
------	-------------	------	--------------

SALES

Date	Buyer	Seller	Price
10/26/2017	CONFER, BRIAN A. & OSLER, KATARINA E.	Capps, Samuel J & Jennifer L	\$67,000
9/3/2003	Capps, Samuel J & Jennifer L	Pullin Theresa	\$79,900
5/25/1977	Pullin Theresa	Pullin Edw & Theresa	\$0
1/1/1975	Pullin Edw & Theresa		\$0

Taxes

2021 Taxes	Charges	Payments	Balance Due
Tax Balance Summary	\$2,638.01	\$2,638.01	\$0.00