

Miami County, Ohio - Property Record Card

Parcel: L32-050700

Card: 1

GENERAL PARCEL INFORMATION

Owner HENSLEY CAROLYN S
 Property Address 3440 CALUMET RD
 Mailing Address 3440 CALUMET RD
 LUDLOW FALLS OH 45339
 Land Use 511 - SINGLE FAMILY DWLG UNPLAT 0-09
 Legal Acreage 10.59
 Legal Description 5-6-9 TR 11 & PT TR 18 SW PT NE & SE PT NW

NOTES

[[CARD 001]] | SMDA#: L32-UN009 -014-00

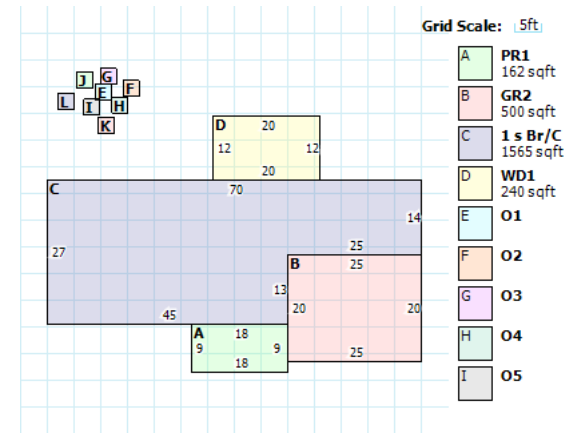

VALUATION

	Appraised	Assessed
Land Value	\$89,000.00	\$31,150.00
Improvements Value	\$131,700.00	\$46,100.00
CAUV Value	\$37,090.00	\$12,980.00
Taxable Value	\$59,080.00	

RESIDENTIAL

Building Style	CONVENTIONAL	Full Baths	2
Year Built	1972	Half Baths	0
Stories	1	Basement	CRAWL
Finished Area	1565	Finished Basement Area	0
First Floor Area	1565	Heating	BASE
Half Floor Area	0	Cooling	CENTRAL
Upper Floor Area	0	Exterior Wall	BRICK
Rooms	6	Attic	NONE
Bedrooms	3	Number of Fireplace Openings	0
Family Rooms	0	Number of Fireplace Stacks	0

LAND

Land Type	Acreage	Depth	Frontage	Depth	Value
A0 - Row	0.09	0	0	0	0
A3 - Residual	9.5	0	0	100	64980
AH - Homesite	1	0	0	100	24000

ADDITIONS

Description	Area	Year Built	Value
PR1 - Porch Frame - Open	162	0	\$4,770.00
GR2 - Garage Brick	500	0	\$13,660.00
WD1 - Wood Deck	240	0	\$3,410.00

IMPROVEMENTS

Description	Year Built	Dimension	Area	Value
Flat Barn Typical	1975	50x30	1500	\$9,300.00
Utility Shed	1950	20x12	240	\$1,300.00
Implement Shed	1950	24x22	528	\$2,400.00
Mtl Pole Barn	1950	48x30	1440	\$1,800.00
Mtl Pole Barn	1950	40x20	800	\$1,100.00
Fr Pole Barn 3	1950	18x12	216	\$600.00
Frame Lean to	1950	50x18	900	\$1,900.00
Utility Shed	1950	20x10	200	\$1,100.00

AGRICULTURAL

Land Type	Land Usage	Soil Type	Acres
C - C	C - Crop	MPA	2.5
C - C	C - Crop	RDA	6
C - C	C - Crop	MNA	1
O - O	O - Other		0.09

SALES

Date	Buyer	Seller	Price
5/24/1996	HENSLEY CAROLYN S	HENSLEY CHAS W	0
1/1/1990	HENSLEY CHAS W	Unknown	0

COMMERCIAL

Grid Scale: 5ft

A	PR1 162 sqft
B	GR2 500 sqft
C	1 s Br/C 1565 sqft
D	WD1 240 sqft
E	O1
F	O2
G	O3
H	O4
I	O5
J	O6
K	O7
L	O8

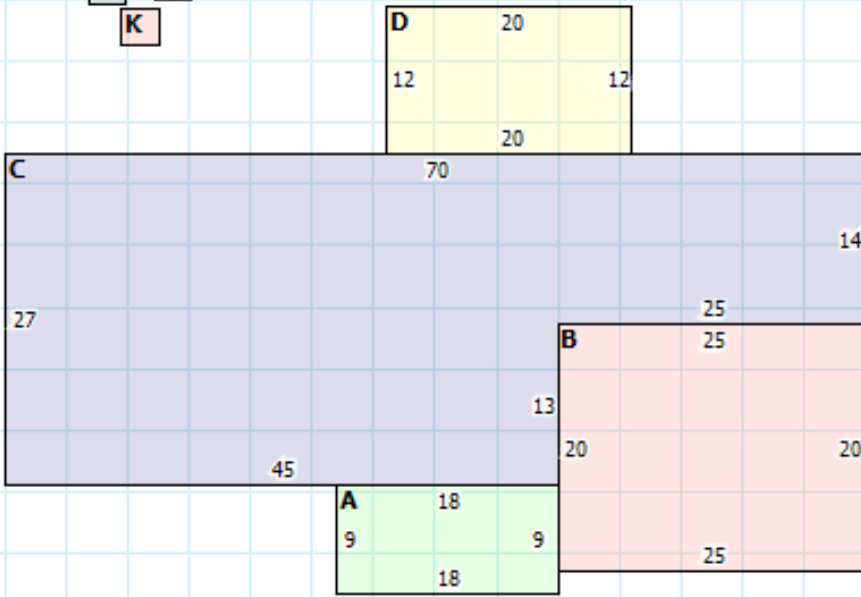

BA3	Basement Extension	PR2	Porch-Enclosed-Frame/Equal
BL1	Balcony	PR3	Porch-Open-Masonry
BZ1	Breezeway-Open	PR4	Porch-Enclosed-Masonry
BZ2	Breezeway-Closed	PR5	Portico
CP1	Carport	PR6	Open Screen Porch
CY1	Canopy-Frame Metal	PT1	Patio
CY2	Canopy-Metal	PT2	Patio-Brick
CY3	Canopy Over Patio	PT3	Patio-Stone
CY4	Canopy Over Stoop	PT4	Redwood Patio
CY5	RFX	SH1	Shed-Frame/Equal
CY6	RFX/Patio	SH2	Shed-Masonry
CY7	RFX/MS	SP1	Indoor Pool
GH1	Greenhouse	ST1	Stoop Masonry
GR1	Garage-Frame/Equal	WD1	Wood Deck
GR2	Garage-Brick	O1	Outbuilding 1
GR3	Garage-Stone	O2	Outbuilding 2
GR4	Garage-Basement	O3	Outbuilding 3
GR5	Garage-Integral	O4	Outbuilding 4
GR6	Shop	O5	Outbuilding 5
GZ1	Gazebo		
PR1	Porch-Open-Frame/Equal		