

Owner ADAMS. SHARON D
Address 12829 LITTLETON RD
 GARFIELD HEIGHTS, OH. 44125
Land Use (5100) R - 1-FAMILY PLATTED LOT
Legal Description 2 HUBER#1 0413 ALL
Neighborhood Code 09206

SKETCH

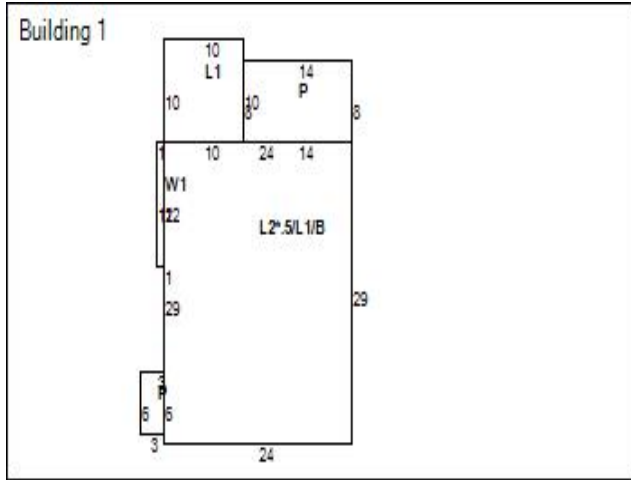

MAP VIEW



BUILDING INFORMATION

Building Record Number	1	Occupancy	1-FAMILY	Story Height	1.5
Style	CAPE COD	Year Built	1949	Exterior Walls	ALUM/VINYL
Condition	AVERAGE	Construction Quality	C / AVERAGE	Roof Type	GABLE
Roof Material	ASPH-SHINGLE	Heat Type	FORCED-AIR	Air Conditioning	NONE
Attic Type	NONE	Basement Type	BASEMENT	Basement Square Feet	696
Basement Finished	N/A	Rooms	5	Bedrooms	3
Bathrooms (Full/Half)	1/0	Garage Type	DETACHED	Garage Capacity	1
Year Garage Built	1949	Garage Size	280	Living Area Basement	
Living Area 1	808	Living Area 2	348	Living Area Upper	
Living Area Total	1,156	Floor Location		Party Wall	

LAND

Code	Frontage	Depth	Acreage	Sq Ft
PRM	40	120	0.11	4,800

VALUATION

2021 Values	Taxable Market Value	Exempt Market Value	Abated Market Value	Assessed Taxable Value
Land Value	\$16,500	\$0	\$0	\$5,780
Building Value	\$63,900	\$0	\$0	\$22,370
Total Value	\$80,400	\$0	\$0	\$28,150
Land Use	5100			SINGLE FAMILY DWELLING

PERMITS

Tax Year	Reason	Tax Change	Exempt Change	Percent Complete	Reinspect	Notes
----------	--------	------------	---------------	------------------	-----------	-------

IMPROVEMENTS

Type	Description	Size	Height Depth
------	-------------	------	--------------

SALES

Date	Buyer	Seller	Price
6/30/2006	ADAMS. SHARON D	Garcia, Fred J.	\$112,500
9/22/2000	Garcia, Fred J.	Kressierer, Matthew F.	\$91,500
10/1/1997	Kressierer, Matthew F.	Selig, Dawn	\$80,000
5/20/1994	Selig, Dawn	Zimlich, Brian A	\$66,000
11/15/1988	Zimlich, Brian A	Gottliebowski Eileen S	\$54,900
11/20/1984	Gottliebowski Eileen S	Gottliebowski Richard Jr	\$0
10/30/1979	Gottliebowski Richard Jr	Glivar Rudolph A& Marilyn T	\$49,000
1/1/1975	Glivar Rudolph A& Marilyn T		\$0

Taxes

2021 Taxes	Charges	Payments	Balance Due
Tax Balance Summary	\$3,255.06	\$3,255.06	\$0.00