

Ottawa County, Ohio - Property Record Card

Parcel: 0190846618645000 Card: 1

Owner HAAR JERALD A & MELODY A TRUSTEES
Address 613 RICE
Land Use (510) R - SINGLE FAMILY DWELLING, PLATTED LOT
Class RESIDENTIAL
Legal Description W PT SE SE
Tax Mailing Name HAAR JERALD A & MELODY A
Tax Mailing Address 19030 ST RT 105, ELMORE OH 43416-9792

MAP



SKETCH

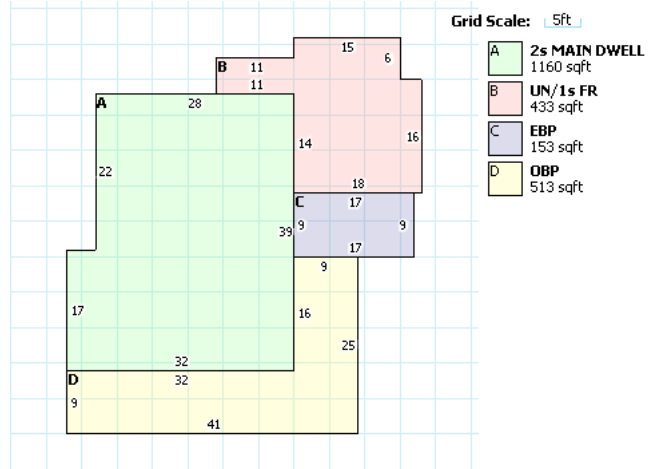

RESIDENTIAL

Building Style		FullBaths	2
Sq.Ft.	2753	Half Baths	1
Year Built	1944	Basement	FULL
Stories	2	Basement Area	0
Exterial Wall	ALUMINUM/VINYL	Rec Room Area	0
Rooms	8	Heat Fuel Type	GAS
Bedrooms	5	Heat/Cool	CENTRAL
Family Rooms	0	Attic	NONE
Fireplace Openings(Stacks)	0(0)	Trim	0

LAND

Code	Frontage	Depth	Acreage	SqFt	Value
1	161	130	N/A	N/A	\$26,610.0

VALUATION

	Appraised	Assessed
Land Value	\$26,610.00	\$9,310.00
Building Value	\$120,800.00	\$42,280.00
Total Value	\$147,410.00	\$51,590.00
CAUV Value	\$0.00	
Taxable Value	\$51,590.00	

PERMITS

IMPROVEMENTS

Card	Description	Year Built	Dimensions	Value
1	RG1 - FRAME	1958	31x32	\$1,800.00

SALES

Date	Buyer	Seller	Price	Validity
3/4/2005	HAAR JERALD A & MELODY A	HAAR JERALD A & MELODY A ETAL	\$0.00	UNVALIDATED
4/19/2001	HAAR JERALD A & MELODY A ETAL	HAAR THEODORE L.E.	\$0.00	UNVALIDATED
3/30/2001	HAAR THEODORE L.E.	HAAR THEODORE L.E.	\$0.00	UNVALIDATED
10/29/1999	HAAR THEODORE L.E.	HAAR THEODORE L.E.	\$0.00	UNVALIDATED
1/23/1998	HAAR THEODORE L.E.	HAAR THEODORE	\$0.00	UNVALIDATED