

Parcel ID: 78-52557

KATIE MOLINE - LUCAS COUNTY AUDITOR

RESIDENTIAL/AGRICULTURAL

Owner: OILER HARLEY F
3450 WILFORD DR

Card 1 of 1
Assr #: 30214019

Market Area: 2013R
DTE #: 00180 - SYLVANIA TWP.-SYLVANIA CSD

Tax Year: 2025
LUC: 510 - 1FAM-PLAT

GENERAL INFORMATION

Topo: Spec Use: 510-1 Family-Plat
Street: 1 - Paved Traffic: 6-Resside
Utilities: 23 - City Water / Septic Sewer Corner Lot: No
Legal: HILTON FARMS LOT 29



7852557 1/4/2024



ADMINISTRATIVE

DATE	SOURCE	ENTRY	ADMIN	DATA ENTRY	REVIEWER
10/06/11	3-Other	5-Doorhang	269-Revaluation	920	290
10/06/11		0-Missing	269-Revaluation	920	290

LAND INFORMATION

TYPE	CODE	FRONT	DEPTH	SQFT	AC	INFL1	INFL2
1	01-Residential Land	100	244	24,400	.5601	1-None	1-None

Total SF: 24,400 Total AC: .5601

PERMITS

DATE	TAXYR	PERMIT #	PURPOSE	STATUS	% COMP
------	-------	----------	---------	--------	--------

SALES/TRANSFER HISTORY

DATE	CONV #	# OF PARCELS	DEED	VALIDITY	TYPE	PRICE
11/02/99		1	QC	X - Exempt Transfe	2 - Land & Building	

CONDO COMPLEX

COMPLEX #	COMPLEX NAME	YR DECLARED	# BLDGS	# UNITS
-----------	--------------	-------------	---------	---------

VALUE HISTORY

2025			2024			2023			2022			2021			2020			2019		
CLASS		R	CLASS		R	CLASS		R	CLASS		R	CLASS		R	CLASS		R	CLASS		R
100%	L	41,800	100%	L	41,800	100%	L	33,100	100%	L	33,100	100%	L	33,100	100%	L	33,700	100%	L	33,700
	B	113,400		B	113,400		B	77,000		B	77,000		B	77,000		B	73,000		B	73,000
	T	155,200		T	155,200		T	110,100		T	110,100		T	110,100		T	106,700		T	106,700
35%	L	14,630	35%	L	14,630	35%	L	11,590	35%	L	11,590	35%	L	11,590	35%	L	11,800	35%	L	11,800
	B	39,690		B	39,690		B	26,950		B	26,950		B	26,950		B	25,550		B	25,550
	T	54,320		T	54,320		T	38,540		T	38,540		T	38,540		T	37,350		T	37,350

Parcel ID: 78-52557

KATIE MOLINE - LUCAS COUNTY AUDITOR

RESIDENTIAL/AGRICULTURAL

Owner: OILER HARLEY F
3450 WILFORD DR

Card 1 of 1
Assr #: 30214019

Market Area: 2013R
DTE #: 00180 - SYLVANIA TWP.-SYLVANIA CSD

Tax Year: 2025
LUC: 510 - 1FAM-PLAT

DWELLING INFORMATION

Occupancy: 2 - Onfam Style: 3 - Ranch
Main SH: 1 - One Story Max SH: 1 - One Story
Attic: 1 - None Grade: 15 - C-
Basement: 2 - Crawl Condition: AV - Av
Construction: 3 - Metal/Vinyl TLA: 1394
Fin Basement: 0 Year Built: 1956 Eff Yr:
Pct Complete: 100 Remodel Year: Type: 0 - None

CONDO INFORMATION

Complex #: Condo Type:
Unit #: Level:
View:

INTERIOR CHARACTERISTICS

Bedrooms: 3 Full Baths: 1
Total Rooms: 6 Half Baths: 1
HVAC: C - Forced Air Heat W/C Additional Fixtures: 0
WB Fire Places: 1
Gas Fire Places:
Stacks: 1

DWELLING CALCULATIONS

Effective Year: Adjusted Base: 102505 Dwelling RCN: 117254
% Good: Plumbing: 0 Total RCN: 117254
% Good Override: Basement: 0 RCN/SF: 84.11
C & D: Heating: 0 Base RCNLD: 78560
C & D Factor: Attic: 0 Additions RCNLD: 22300
Functional: Other Features: 0 Total RCNLD: 78560
Reason: Dwelling Subtotal: 127450 RCNLD/SF: 56.36
Economic: Base RCN: 117254 Pct Complete: 100
Reason: Local Multiplier: 1 Dwelling Factor: 1.333
Dwelling Value: 104720
Roll Pct: 100 Condo Base Value:
Roll Value: 104720 Condo Adj Value:

OUTBUILDINGS & YARD ITEMS

LINE	CONDO	CODE	AREA	CONDITION	YEAR BUILT	OBY VALUE
1		SD1 - Shed - R	140	3-Av	1980	1,300

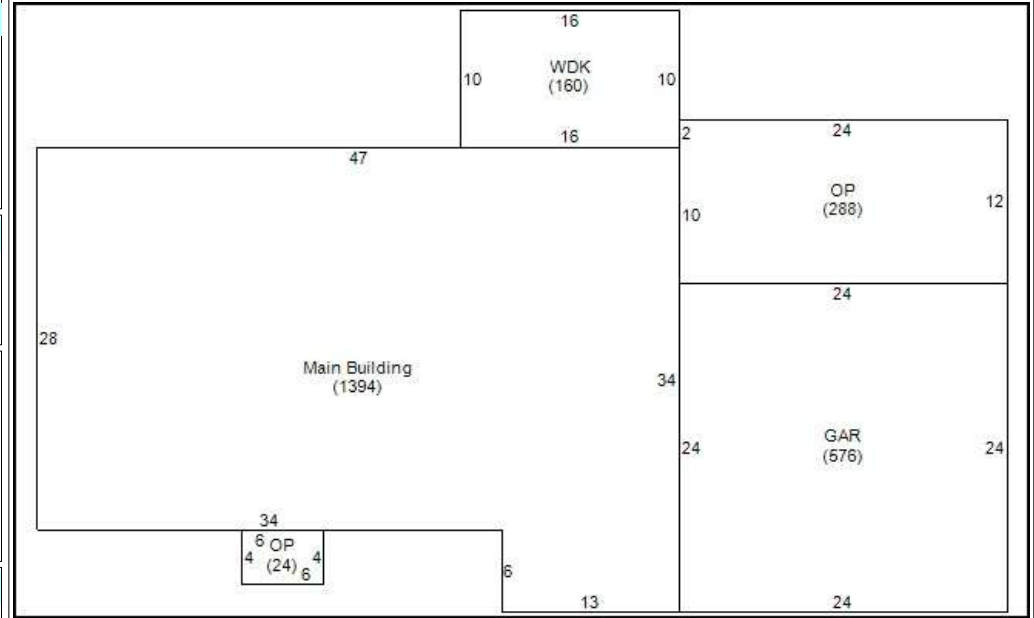

DWELLING ADDITIONS

LINE	LOWER	FIRST	SECOND	THIRD	AREA	YR BUILT
0					1,394	
1		40-GAR			576	
2		30-OP			288	
3		35-WDK			160	
4		30-OP			24	

MEMORANDUM