

OCCUPANCY
 SF DU TR
 CONVERSION
BUILDING TYPE
 MOBILE HOME
 BI/TR LEVEL
 MOD/MAN

EXTERIOR
 WOOD
 STUCCO
 ALM/VYNL
 CONC BLK
 METAL
 BRICK
 STONE

ROOFING
 METAL
 SLT/TLE
 SHINGLES
 SHAKES
 COMPOSITE

ROOF TYPE
 GABLE
 HIP
 GAMBREL
 MANSARD
 FLAT

FLOORS B 1 2 3 U
 CONCRETE
 WOOD
 TILE/COMPO
 CARPET

INT. FINISH B 1 2 3 U
 PLASTER/DW
 PANELING
 UNFINISHED

ACCOMMODATIONS
 # OF ROOMS 5
 BEDROOMS 3
 FIREPLACES
 HEAT & AC B 1 2 3 U

NO HEAT
 CTRL HEAT
 HW/STEAM
 ELECTRIC
 HEAT PUMP
 FLR/WALL
 STVE/SPCE
 GEOTHERMAL
 OUTSIDE
 CTRL A/C
 PLUMBING BASE

X FULL BATH
 X HALF BATH
 X FIXTURES

FLOOR	AREA	CONST	VALUE
1	1080	BRK	144,160
BSMT	840		8,400
SUBTOTAL			152,560
MULTI-FAMILY #	0		0
BUILDING TYPE	100%		0
BSMT FINISH	0 S.F.		0
FIREPLACE #	0		0
HEATING	0 S.F.		0
AIR COND	1,080 S.F.		1,620
PLUMBING #	0		0
GARAGES & CARPORTS			2,780
EXTRA FEATURES			3,700
SUBTOTAL			160,660
GRADE FACTOR			100 %
UNADJUSTED VALUE			194,400
FACTOR			100 %

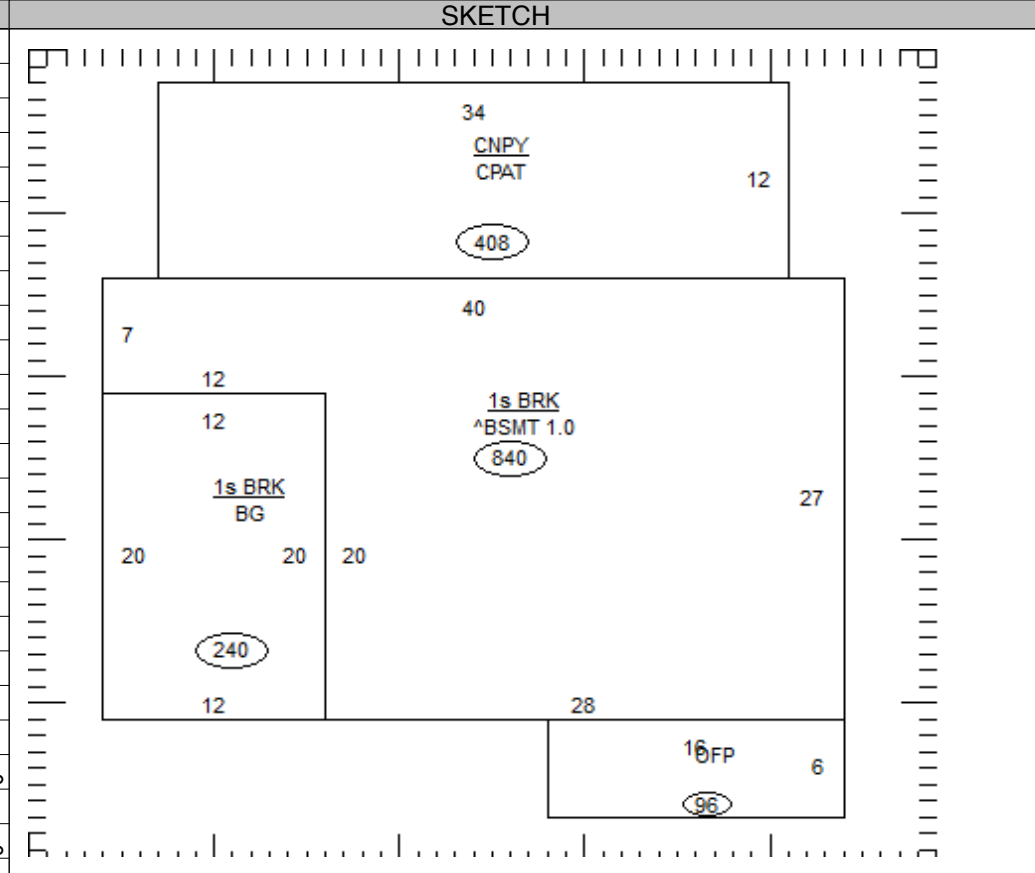

OCCUPANCY	ST.HT	SIZE	AREA	GRADE	PRICE	AGE	REMD	CND	UNADJ VAL	PHYS	PHYS VAL	FUNC	TRUE VAL
DWELLING	1	SK	1,080	C		1957		A	194,400	66	66,100		66,100
1													
2													
3													
4													
5													
6													
7													
8													
9													
10													
11													

07-07976-000 TOTAL 66,100

COMMENTS

(96SF OFP=\$1,150),(408SF CNPY=\$1,630),(408SF CPAT=\$920),(240SF BG=\$2,780)