



**Carri L Brown, PhD, MBA, CGFM**  
 FAIRFIELD COUNTY AUDITOR | FAIRFIELD COUNTY, OH

**Summary**

**Parcel Number** 0010012203  
**Location Address** 6832 CRUMLEY RD SW  
 LANCASTER OH 43130  
**Legal Description** R 20 T 13 S 12 SW  
 (Note: Not to be used on legal documents.)  
**Property Class** R - RESIDENTIAL  
**Land Use** (511) R - SINGLE FAMILY, O-9.999 AC  
**Neighborhood** 00053000  
**Legal Acres** 4.29  
**City** UNINCORPORATED  
**Township** AMANDA TOWNSHIP  
**School District** AMANDA-CLEARCREEK L.S.D  
**Owner Occupancy Credit** YES  
**Homestead Reduction** NO

[View Map](#)

**Owner**

**Owner**  
[CAIN DONALD L](#)  
 & NATASHA N SURV  
 6832 CRUMLEY RD  
 LANCASTER OH 43130  
**Tax Mailing Address**  
 CAIN DONALD L  
 & NATASHA N SURV  
 6832 CRUMLEY RD  
 LANCASTER OH 43130

**Valuation**

**Tax Year 2022 Certified Valuation**

Tax Year	2022
Land Value	\$72,540.00
Building Value	\$358,690.00
<b>Total Value (Appraised 100%)</b>	<b>\$431,230.00</b>
Land Value	\$25,390.00
Building Value	\$125,540.00
<b>Total Value (Assessed 35%)</b>	<b>\$150,930.00</b>
Land CAUV Value	\$0.00
Taxable Value	\$150,930.00

**Valuation History**

Tax Year	Appraised Land Value	Appraised Building Value	Appraised Total Value	Assessed Land Value	Assessed Building Value	Assessed Total Value	CAUV	Taxable Value
2022	\$72,540	\$358,690	\$431,230	\$25,390	\$125,540	\$150,930	\$0	\$150,930
2021	\$58,030	\$226,880	\$284,910	\$20,310	\$79,410	\$99,720	\$0	\$99,720
2020	\$58,030	\$226,880	\$284,910	\$20,310	\$79,410	\$99,720	\$0	\$99,720
2019	\$58,030	\$226,880	\$284,910	\$20,310	\$79,410	\$99,720	\$0	\$99,720
2018	\$46,100	\$184,720	\$230,820	\$16,140	\$64,650	\$80,790	\$0	\$80,790
2017	\$46,100	\$184,720	\$230,820	\$16,140	\$64,650	\$80,790	\$0	\$80,790
2016	\$46,100	\$184,720	\$230,820	\$16,140	\$64,650	\$80,790	\$0	\$80,790
2015	\$40,870	\$176,340	\$217,210	\$14,300	\$61,720	\$76,020	\$0	\$76,020
2014	\$40,870	\$176,340	\$217,210	\$14,300	\$61,720	\$76,020	\$0	\$76,020
2013	\$40,870	\$158,720	\$199,590	\$14,300	\$55,550	\$69,850	\$0	\$69,850
2012	\$44,250	\$0	\$44,250	\$15,490	\$0	\$15,490	\$0	\$15,490
2011	\$9,460	\$0	\$9,460	\$690	\$0	\$690	\$1,970	\$690
2010	\$12,330	\$0	\$12,330	\$760	\$0	\$760	\$2,180	\$760

**Land**

Description	Acres	Effective Lot Size	Square Feet	Value
Undeveloped/Residual	3.2900	0 x 0	143,312	\$28,790
Homesite	1.0000	0 x 0	43,560	\$43,750

Total Acres:  
4.2900  
Total Land-Value:  
\$72,540

**Dwellings**

Card	1	Condition	AV
Stories	1	Exterior Wall	ALUM/VINYL
Year Built	2012	Heat	AIR CONDITIONING
Total Rooms	5	Heating Fuel Type	GAS
Bedrooms	3	Attic	PT-FIN
Full Baths	2	Basement	FULL
Half Baths	1	Fireplace Openings	0
Total Living Area	1920	WBFP Stacks	0
Ground Floor Area	960	Prefab Fireplace	0
Rec Room Area	0	Unfinished Area	0
Brick/Stone Trim Area	0	Finished Basement Area	0
Grade	C+	Year Remodeled	0
Style	LOG		

**Sales**

Transfer Date	Sale Date	Seller	Buyer	Sale Price
	3/9/2012	GENESIS LAND DEVELOPMENT LLC	CAIN DONALD L	\$49,900
	8/3/2010	BEITZEL LAND COMPANY INC	GENESIS LAND DEVELOPMENT LLC	\$0
	8/3/2010	GENESIS LAND DEVELOPMENT LLC	BEITZEL LAND COMPANY INC	\$0
	5/8/2008	BEITZEL LAND COMPANY INC	GENESIS LAND DEVELOPMENT LLC	\$0
	5/7/2008	GENESIS LAND DEVELOPMENT LLC	BEITZEL LAND COMPANY INC	\$0

**Permits**

Date	Number	Amount	Purpose
08/22/2012	1082	\$0	DWG

**Tax History**

Taxes Shown below HAVE BEEN certified by Fairfield County Auditor

Tax Year (click for detail)	Prior Charges	Full Year Total	Payments	Half Year Due	Full Year Due
<a href="#">2022 Pay 2023</a>	\$0.00	\$14,058.75	\$9,045.15	\$2,506.80	\$5,013.60
<a href="#">2021 Pay 2022</a>	\$4,858.02	\$9,045.15	\$0.00	\$6,851.89	
<a href="#">2020 Pay 2021</a>	\$0.00	\$4,325.16	\$0.00	\$2,059.60	
<a href="#">2019 Pay 2020</a>	\$0.00	\$3,772.28	\$3,772.28	\$0.00	
<a href="#">2018 Pay 2019</a>	\$0.00	\$3,120.82	\$3,120.82	\$0.00	

**Levies**

No Levy Information To Display At This Time

**Payments**

Date	Amount
11/29/2022	(\$9,045.15)

Sketches

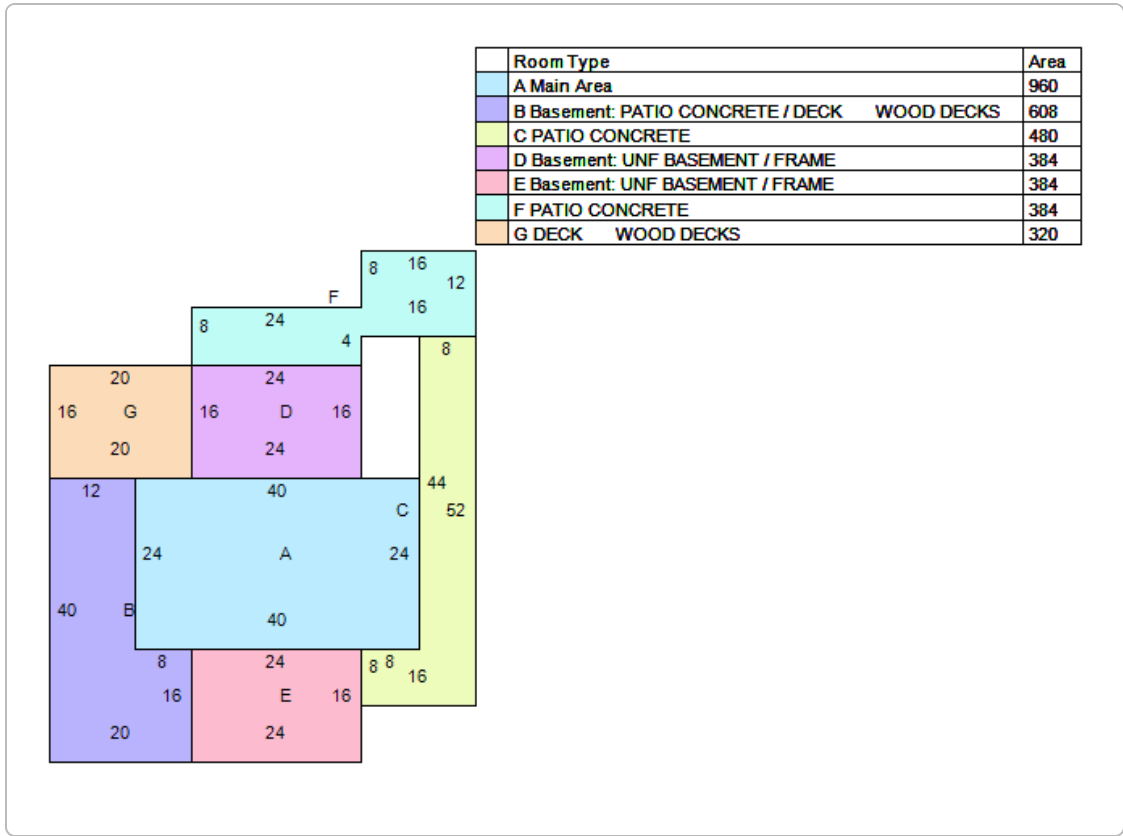

Tax Bill

Please note: The URL to make tax payments has changed. We are working on getting the Treasurer link updated in the Tax Bill but in the mean time, please go to <https://www.co.fairfield.oh.us/TREASURER/>

Tax Bill

Property Card

Property Card

Pay Your Taxes Online

Pay Taxes

Please verify exact amounts with the Treasurer's Office at (740) 652-7140

No data available for the following modules: Soils, Commercial Improvement Information, Interior/Exterior Information, Improvements, Other Features, Special Assessments, Photos.

The information provided by Fairfield County is provided 'as is' and for reference only. The user expressly agrees that the use of Fairfield County's web site is at the user's sole risk. Fairfield County does not warrant that the service will be uninterrupted or error free. Any information published on this server could contain technical inaccuracies or typographical errors. Changes may be made periodically to the tax laws, administrative rules, tax releases and similar materials...

User Privacy Policy  
GDPR Privacy Notice

Last Data Upload: 1/20/2023, 8:02:37 AM

Version 2.3.241

