

Parcel: 24-00134.000

Year: 2022

CINDI HENRY

Belmont County Auditor | Belmont County, Ohio



SUMMARY

Table with 4 columns: Deeded Name, Owner, Taxpayer, and various property details like Tax District, School District, Location, etc.

VALUE

Table with 3 columns: District, Land Use, Appraised, Assessed, and Taxable values for Land, Improvement, and Total.

CURRENT CHARGES

Table with 5 columns: Full Rate, Effective Rate, Qualifying Rate, and a breakdown of charges (Tax, Special, Penalty, Total, Paid, Due).

FUTURE CHARGES

Table with 3 columns: Type, Description, and Amount for Special Assessments.

TRANSFER HISTORY

Table with 7 columns: Date, Buyer/Seller, Conveyance, Deed Type, Sales Amount, Valid, and # of Properties.

LAND

Table with 4 columns: Type, Dimensions, Description, and Value for FR-FRONT LOT.

DWELLING

Table with 6 columns: Card 1, Style, Stories, Rec Room Area, Finished Basement, Rooms, Bed Rooms, and other fixtures with their respective values.

OTHER IMPROVEMENT

Table with 9 columns: Card Type, Year Built, Year Remodeled, Condition, Dimensions, Description, Size, and Value for DCBG-DETACHED CONCRETE BLOCK GARAGE and UTILITY-MISCELLANEOUS BUILDING.

SKETCH

Card 1

ID	Description	Size	Floor	Floor Area (ft <sup>2</sup> )	Living Area (ft <sup>2</sup> )
A	2SFR/B (2 STORY FRAME / BASEMENT)	552	Basement	650	0
B	OFF	98	First Floor	649	649
C	PATIO	112	Full Upper Floor	552	552
D	1SFR/OH	8	Total	1,851	1,201
E	B (BASEMENT)	98			
F	1SFR/C (1 STORY FRAME / CRAWL)	62			
G	1SFR/C (1 STORY FRAME / CRAWL)	35			
1	UTILITY-MISCELLANEOUS BUILDING	440			
2	DCBG-DETACHED CONCRETE BLOCK GARAGE	440			

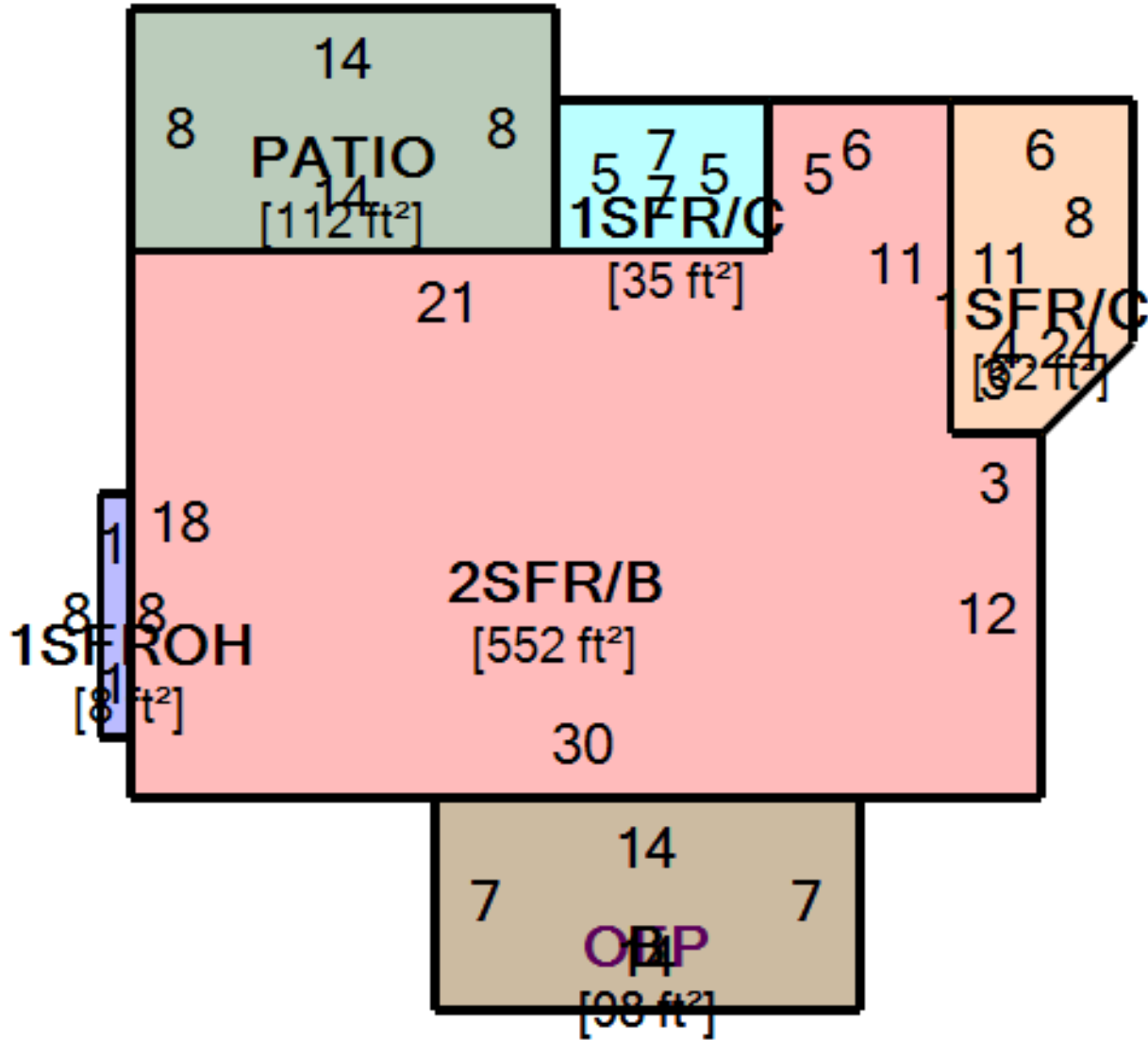

2 1