



Cuyahoga County, Ohio - Property Summary Report

Parcel: 722-22-049



Owner SIEGEL, HOWARD.
Address 2539 CHARNEY RD
 UNIVERSITY HEIGHTS, OH. 44118
Land Use (5100) R - 1-FAMILY PLATTED LOT
Legal Description 15 RTRLD#33 0273 ALL
Neighborhood Code 12307

SKETCH

MAP VIEW

Map Image

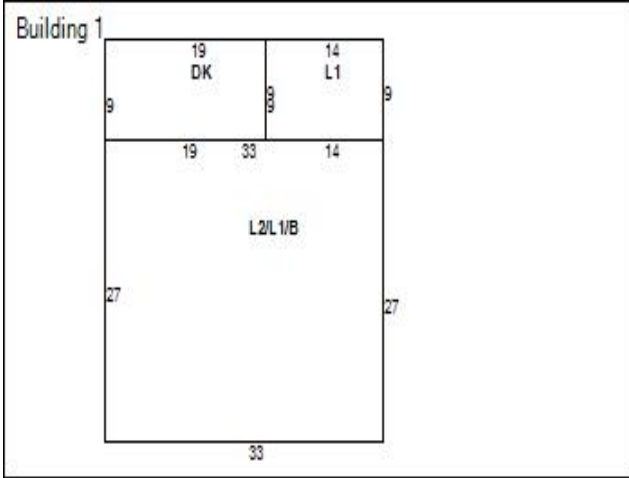

BUILDING INFORMATION

Building Record Number	1	Occupancy	1-FAMILY	Story Height	2
Style	COLONIAL	Year Built	1956	Exterior Walls	BRICK
Condition	AVERAGE	Construction Quality	B+ / GOOD+	Roof Type	GABLE
Roof Material	ASPH-SHINGLE	Heat Type	FORCED-AIR	Air Conditioning	CENTRAL
Attic Type	NONE	Basement Type	BASEMENT	Basement Square Feet	891
Basement Finished	N/A	Rooms	7	Bedrooms	3
Bathrooms (Full/Half)	1/1	Garage Type	DETACHED	Garage Capacity	2
Year Garage Built	2012	Garage Size	400	Living Area Basement	
Living Area 1	1,017	Living Area 2	891	Living Area Upper	
Living Area Total	1,908	Floor Location		Party Wall	

LAND

VALUATION

Code	Frontage	Depth	Acreage	Sq Ft
PRM	50	150	0.17	7,500

2021 Values	Taxable Market Value	Exempt Market Value	Abated Market Value	Assessed Taxable Value
Land Value	\$40,400	\$0	\$0	\$14,140
Building Value	\$161,700	\$0	\$0	\$56,600
Total Value	\$202,100	\$0	\$0	\$70,740
Land Use	5100			SINGLE FAMILY DWELLING

PERMITS

IMPROVEMENTS

Tax Year	Reason	Tax Change	Exempt Change	Percent Complete	Reinspect	Notes
2013	30 - New Construction	\$	\$	100%	No	OLD GARAGE RAZED / NEW GARAGE COMPLETED AS OF 1-1-13 NO VALUE ADDED

Type	Description	Size	Height	Depth
------	-------------	------	--------	-------

SALES

Date	Buyer	Seller	Price
6/12/2001	Siegel, Howard.	Siegel, Howard B	\$0
5/8/1998	Siegel, Howard B	Weimer, Susan F.	\$159,900
4/29/1992	Weimer, Susan F.	Weimer Susan F	\$85,500
9/29/1989	Weimer Susan F	Block Lisa K....	\$107,500
4/14/1988	Block Lisa K....	Block Robert E	\$0
8/24/1984	Block Robert E	Burck Donald R & T S	\$87,000
1/1/1975	Burck Donald R & T S		\$0

Taxes

2021 Taxes	Charges	Payments	Balance Due
Tax Balance Summary	\$49,685.31	\$.00	\$49,685.31