

Parcel: 7502048
 HARRIS MICHAEL A & LYNN M

153RD S of WINCHESTER ST NE
 3125 BEECHWOOD AVE - ALLIANCE 44601

21/1377/PS

① ②

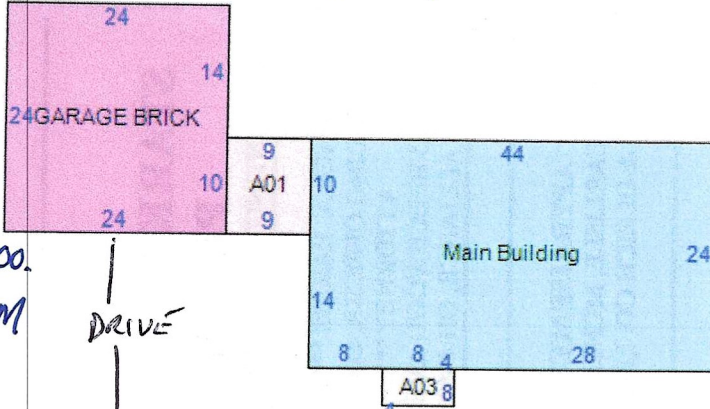

9/27/07 sold for 108,000.
 #1481081-25 DOM

DRIVE

Item	Area
Main Building	1056
GARAGE BRICK - GB:GARAGE BRICK	576
② PERSONAL P - 920:PERSONAL PROPERTY BLDG	8'x8' = 64
PORCH, COVER BR - PB:PORCH, COVERED BRICK	32
① BARN, FLAT - 102:BARN, FLAT	24'x24' = 576
BREEZE, ENCL BR - ZB:BREEZEWAY, ENCLOSED BRICK	90

RESTRICTED REPORT FOR STARK CO. SHERIFF Inspection Date: 2/10/22
 TYPE OF AREA: RESIDENTIAL: Urban Suburban Rural COMMERCIAL: Prime Secondary Nighborhood
 INDUSTRIAL: Heavy Light Park CA- 2-14 141 TB-
 Inspected By: JW- DB-150 PO- CA- 141 TB-
 Mfg(s): \$ 98,000. REFI AVM: Lo 134 Mid 151 HI 168 % (65) APPRAISED VALUE: (16) = 135 \$ 149,000.00
 RE-APPRAISAL DATA: Reason: NEW: Date / / Amount: \$

S of ENSTON ST NE - N of BEECH ST

Printed on Thursday, February 10, 2022, at 4:38:05 PM EST

Card 1
 Stories 1
 Construction 2 - BRICK
 Style 1 - RANCH
 Square Feet 1,056
 Year Built 1952
 Effective Year 1952
 Year Remodeled FURNACE + H2O HEATER / VINYL WINDOWS
 % Complete LAND 100
 Dwelling Value 1.48 AC = \$38,000. + \$70,100. + \$7,500. OUTBILLS = \$ 115,600.00
 Physical Condition 3 - AVERAGE
 CDU AV - AVERAGE / FAIR+
 Bedrooms 3
 Basement 1 - FULL
 Basement Quality 0 - NONE
 Rec Room 0
 Finished Basement 0
 Full Baths 1
 Half Baths 0
 Central Air 0 - No AC
 Heating Fuel Type 1 - GAS

Hi TRAFFIC
 NO STREET PARKING

21/1377/PS

U-B-C