

Ashtabula County, Ohio - Property Record Card

Parcel: 090210000800 Card: 1

Owner **IMRIE MARY**
 Address **4293 CREEK**
 Land Use **(511)**
 Class **RESIDENTIAL**
 Legal Description **SEC 3-8 N**
 Range Township Section **0-PY-0**

MAP

SKETCH

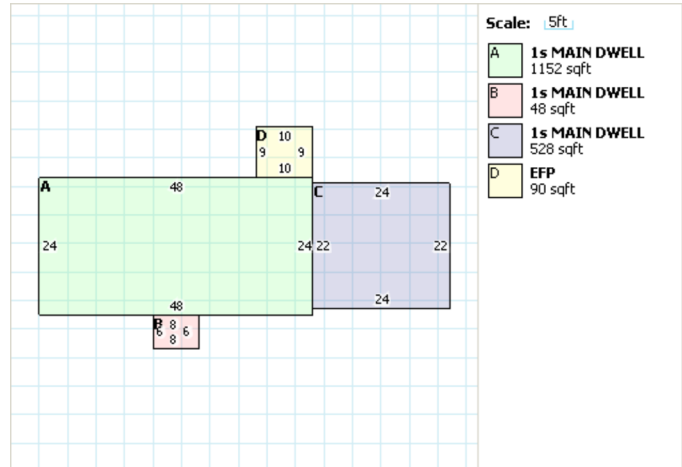

RESIDENTIAL

Building Style		FullBaths	1
Sq.Ft.	1152	Half Baths	0
Year Built	1981	Basement	FULL BASEMENT
Stories	1	Basement Area	0
Exterial Wall	WOOD/ALUM	Rec Room Area	0
Rooms	5	Heat Fuel Type	
Bedrooms	3	Heat/Cool	HEAT PUMP
Family Rooms	0	Attic	NONE
Fireplace Openings(Stacks)	0(0)	Trim	0

LAND

Code	Frontage	Depth	Acreage	SqFt	Value
0	0	0	0.22	N/A	\$0.00
S	0	0	3.41	N/A	\$11,500.00
H	0	0	1	N/A	\$3,380.00

VALUATION

	Appraised	Assessed
Land Value	\$14,900.00	\$5,220.00
Building Value	\$81,500.00	\$28,530.00
Total Value	\$96,400.00	\$33,750.00
CAUV Value	\$0.00	
Taxable Value	\$33,750.00	

PERMITS

IMPROVEMENTS

Card	Description	Year Built	Dimensions	Value
1	01	1993	14x22	\$3,900.00
1	01	1974	24x32	\$1,500.00
1	04	1990	8x10	\$0.00

SALES

Date	Buyer	Seller	Price	Validity
2/24/2004	IMRIE MARY	DOYLE JACQUELINE I	\$122,000.00	U NOT VALIDATED
6/28/2000	DOYLE JACQUELINE I	DOYLE HUBERT C	\$0.00	I ERROR IN