



Summary

Parcel Number **J39-610-220306003000**
 Map Number 610-2203
 Location Address 105 HIGH ST
 Acres 0.1517
 Legal Description INLOT 150 LESS 7 1/2' R/W
 (Note: Not to be used on legal documents.)
 Land Use 510 - Single family Dwlg
 (Note: Land Use is for valuation purposes only. Consult the local jurisdiction for zoning and legal use.)
 Neighborhood 01402 - Haskins
 City Haskins Village
 Township Middleton Township
 School District Otsego LSD
 Homestead Reduction: No
 Owner Occupancy Credit: Yes
 Foreclosure No
 Board of Revision No

Owners

Owner NOHLE DAWN MARIE
 Tax Payer Address NOHLE DAWN MARIE
 PO BOX 69
 HASKINS OH 43525

Valuation

Assessed Year	2021	2020	2019	2018	2017
Land Value	\$19,900	\$19,900	\$19,900	\$19,900	\$19,900
CAUV Value	\$0	\$0	\$0	\$0	\$0
Improvements Value	\$31,700	\$31,700	\$27,300	\$27,300	\$27,300
Total Value (Appraised 100%)	\$51,600	\$51,600	\$47,200	\$47,200	\$47,200
Land Value	\$6,970	\$6,970	\$6,970	\$6,970	\$6,970
CAUV Value	\$0	\$0	\$0	\$0	\$0
Improvements Value	\$11,100	\$11,100	\$9,560	\$9,560	\$9,560
Total Value (Assessed 35%)	\$18,070	\$18,070	\$16,530	\$16,530	\$16,530

Land

Land Type	Calculated Acres	Actual Frontage	Effective Frontage	Depth	Depth Factor	Base Rate	Unit Rate	Adjusted Rate	Appraised Value (100%)
L1 - Regular Lot	0.1517	56	56	118	89%	400	400	356	\$19,940
Total	0.1517								\$19,940

Dwellings

Card	1	Exterior Wall	Frame/Siding
Number of Stories	1.5	Heating	Base
Style	Conventional	Cooling	Central
Year Built	1900	Basement	Crawl
Year Remodeled	1991	Attic	None
Rooms	5	Finished Living Area	734
Bedrooms	2	First Floor Area	504
Full Baths	1	Upper Floor Area	0
Half Baths	0	Half Floor Area	230
Family Rooms	0	Finished Basement Area	0
Dining Rooms	0	Total Basement Area	0
Basement Garages	0	Attic Area	0
Condition	Fair	Fireplace Openings	0
Fireplace Stacks	0		

Additions

Card 1

Addition Code	Description	Base Area	Year Built
WD1	Wood Deck	120	0
PR2	Porch Frame - Enclosed	100	0

Improvements

Card 1

Improvement Code	Description	Length	Width	Total Area	Year Built	Appraised Value (100%)
X	Shed - No Value	10	8	80	1900	\$0
Total						\$0

Sales

Sale Date	Sale Price	Seller	Buyer	No. Of Properties	Land Only Sale	Deed Type	Conveyance Number
12/15/2004	\$67,000	PETERS MIRANDA L MCMAHAN JUDITH	NOHLE DAWN MARIE	1	N	1	2897
2/25/2003	\$52,530	DEVRIENDT JANET	PETERS MIRANDA L MCMAHAN JUDITH	1	N	1	288
12/30/1988	\$0		DEVRIENDT JANET	1	N		1442

Recent Sales In Area

Sale date range:

From:

03/18/2019

To:

03/18/2022

Sales by Neighborhood

1500

Feet



Sales by Distance

Tax History

Delinquent payments made after the fall due date will still show due in the year they were originally assessed. If paid, payment will show in the next tax year.

Detail:

Tax Year	Type	Category	Description	Amount
2021 Pay 2022	Property Tax Detail	Tax	1st half tax	\$451.11
2021 Pay 2022	Property Tax Detail	Tax	2nd half tax	\$451.11
2020 Pay 2021	Property Tax Detail	Tax	1st half tax	\$453.31
2020 Pay 2021	Property Tax Detail	Tax	2nd half tax	\$453.31
2019 Pay 2020	Property Tax Detail	Tax	1st half tax	\$431.75
2019 Pay 2020	Property Tax Detail	Tax	2nd half tax	\$431.75
2018 Pay 2019	Property Tax Detail	Tax	1st half tax	\$430.29
2018 Pay 2019	Property Tax Detail	Tax	2nd half tax	\$430.29

Total:

Tax Year	Amount
2021 Pay 2022	\$902.22
2020 Pay 2021	\$906.62
2019 Pay 2020	\$863.50
2018 Pay 2019	\$860.58

Treasurer's Tax Bill

Tax Bill

Tax Details

Get a copy of your tax bill and tax distribution. Will direct user to the Treasurer website.

Payments

Detail:

Tax Year	Payment Date	Paid By	Amount
2021 Pay 2022	2/9/2022	CORELOGIC	\$451.11
2020 Pay 2021	7/6/2021	ACHCORELOGIC	\$453.31
2020 Pay 2021	2/5/2021	ACH CORELOGIC	\$453.31
2019 Pay 2020	7/6/2020	ACHCORELOGIC2	\$431.75
2019 Pay 2020	2/6/2020	CORELOGIC	\$431.75
2018 Pay 2019	6/26/2019	corelogic	\$430.29
2018 Pay 2019	2/7/2019	corelogic36	\$430.29

Total:

Tax Year	Amount
2021 Pay 2022	\$451.11
2020 Pay 2021	\$906.62
2019 Pay 2020	\$863.50
2018 Pay 2019	\$860.58

Sketches

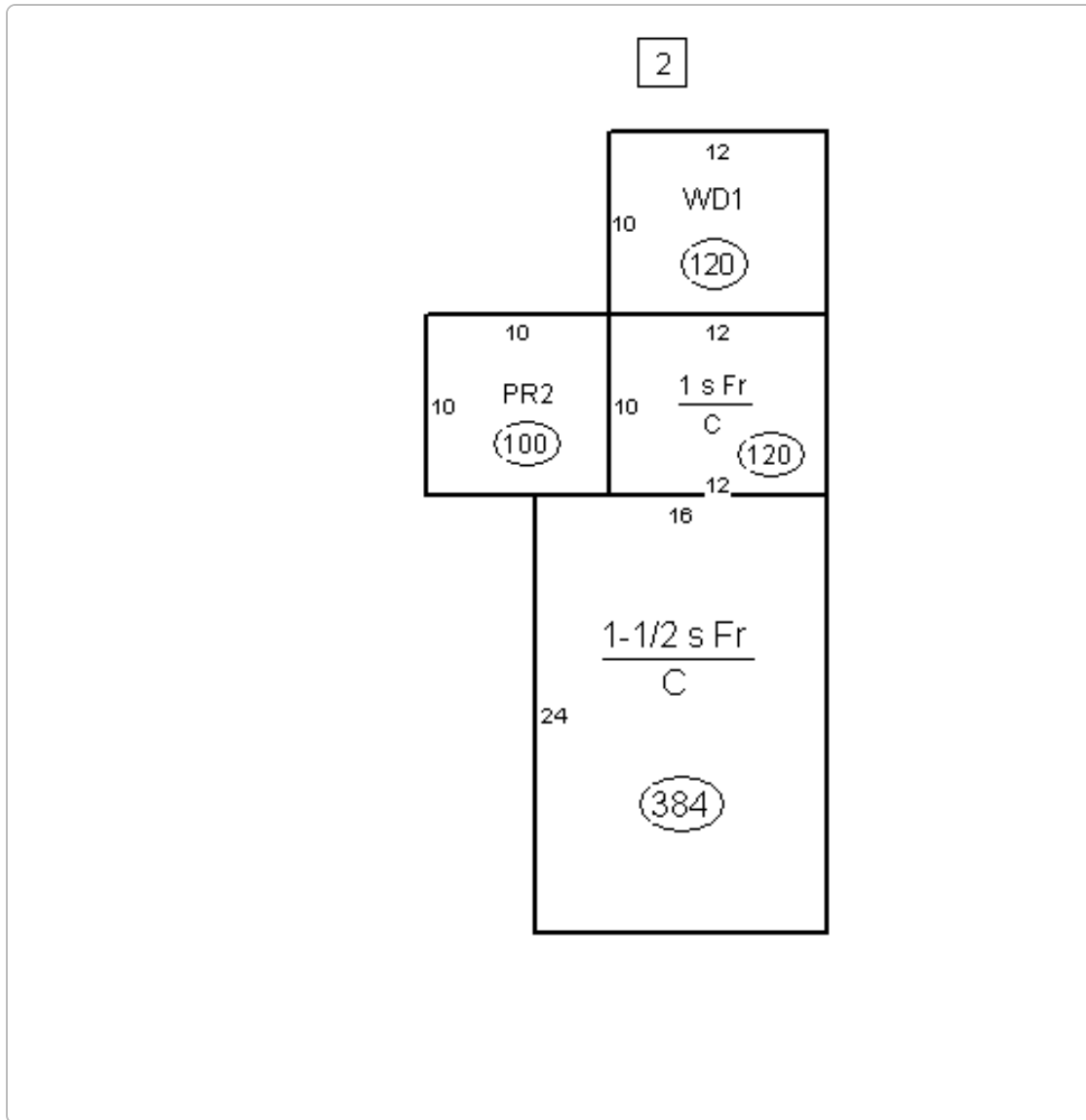

Map



No data available for the following modules: Ag Soil, Buildings.

The information provided by Wood County is provided 'as is' and for reference only. The user expressly agrees that the use of Wood County's web site is at the user's sole risk. Wood County does not warrant that the service will be uninterrupted or error free. Any information published on this server could contain technical inaccuracies or typographical errors. Changes may be made periodically to the tax laws, administrative rules, tax releases and similar materials;

[User Privacy Policy](#)
[GDPR Privacy Notice](#)

[Last Data Upload: 3/18/2022, 3:55:29 AM](#)

Developed by
 Schneider
GEOSPATIAL

Version 2.3.180