

Property Record Card (Fairfield County, Ohio)

Parcel: 0040077400 Card: 1 of 1

Owner NUTTER ALLEN SR
Address 317 BLUE VALLEY RD SE
Land Use (511) R - SINGLE FAMILY, O-9.999 AC
Class RESIDENTIAL
Legal Description R 18 T 14 S 31 SW

MAP



SKETCH

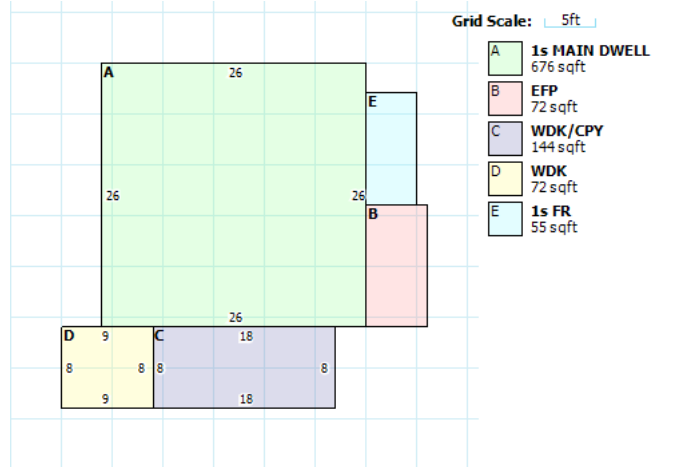

RESIDENTIAL

Building Style	RANCH	FullBaths	1
Sq.Ft.	731	Half Baths	0
Year Built	1967	Basement	FULL
Stories	1	Basement Area	0
Exterial Wall	ALUMINUM/VINYL	Rec Room Area	0
Rooms	4	Heat Fuel Type	ELECTRIC
Bedrooms	2	Heat/Cool	CENTRAL HEAT / AIR CONDITION
Family Rooms	0	Attic	NONE
Fireplace Openings(Stacks)	1(1)	Trim	0

LAND

Desc.	Front	Depth	Acreage	SqFt	Value
HOMESITE	0	0	0.21	N/A	\$13,610

VALUATION

	Appraised	Assessed
Land Value	\$13,610	\$4,760
Building Value	\$44,130	\$15,450
Total Value	\$57,740	\$20,210
CAUV Value	\$0	
Taxable Value	\$20,210	

PERMITS

IMPROVEMENTS

SALES

Date	Buyer	Seller	Price	Validity
11/29/1994	NUTTER ALLEN SR	ZWICKER WALTER L	\$39,550.00	1 - MULTI-PARCEL
10/28/1991	ZWICKER WALTER L	SMITH STEVEN P	\$37,800.00	1 - MULTI-PARCEL
9/1/1986			\$34,500.00	1 - MULTI-PARCEL

DWELLING COMPUTATIONS

Base Price	92,340	% Good	40
Plumbing		Market Adj.	
Basement	0	Functional	
Heating	3,240	Economic	
Attic	0	% Complete	
Other Features	6,900	C&D Factor	
		Adj. Factor	1
Subtotal	115,880	Additions	13,400
Ground Floor Area	676	Dwelling Value	44,130
Total Living Area	731		

Building Notes

OUTBUILDING DATA

Type	YrBlt	EffYr	Size	Area	Gr	Qty	ModCd	PH	FV	%Comp	Value
------	-------	-------	------	------	----	-----	-------	----	----	-------	-------