

1454 EASTVIEW DR

51-08298.000



- General Info
- Tax
- History
- Distribution
- Levy
- Tax Estimator

**Property Information**

Parcel ID	51-08298.000	Property Address:	
Owner Name	BROWN DIANE M &/OR LOIS J ROUSH	1454 EASTVIEW DR	
Owner Address	1454 EASTVIEW SALEM OH 44460	Tax Payer Address:	
Tax District	51 SALEM CITY	CORELOGIC	
School District	1508 SALEM CSD	1 FIRST AMERICAN WAY	
Neighborhood	11611 SALEM CITY	WESTLAKE TX 76262	
Use Code	510 One Family Dwelling	USA	
Acres	.00000		
Description			
63 SUN VIEW 2''' 100' ANNEX FROM 5001878 TOD DESIGNATION CLIFTON D ROUSH 12/16			

		Current Value		Recent Transfer	
Board of Revision	N	Mkt Land Value	\$28,100	Account Number	51-0028B.081000
Homestead/Disability	N	CAUV	\$0	# Parcels	1
2.5% Reduction	Y	Mkt Impr Value	\$78,000	Deed Type	FD-FIDUCIARY DEED
Divided Property	N	Total	\$106,100	Amount	\$111,511
New Construction	N	Current Tax		Sale Date	12/12/2016
Foreclosure	N	Annual Tax *	\$1,542.69	Conveyance	1900
Other Assessments	Y	Paid **	\$1,542.69	Deed #	
Front Ft.	0	Delq	\$0.00		

<< Previous Card      Card 1 of 1      Next Card >>

**Dwelling Information**

Sq Ft Finished	1056	Room Count	5	Fireplace(s)	0
1st Floor Area	1056	Story Height	1	Year Built	1959
Upper Floor Area	0	# Bedrooms	2	Year Remodeled	2000



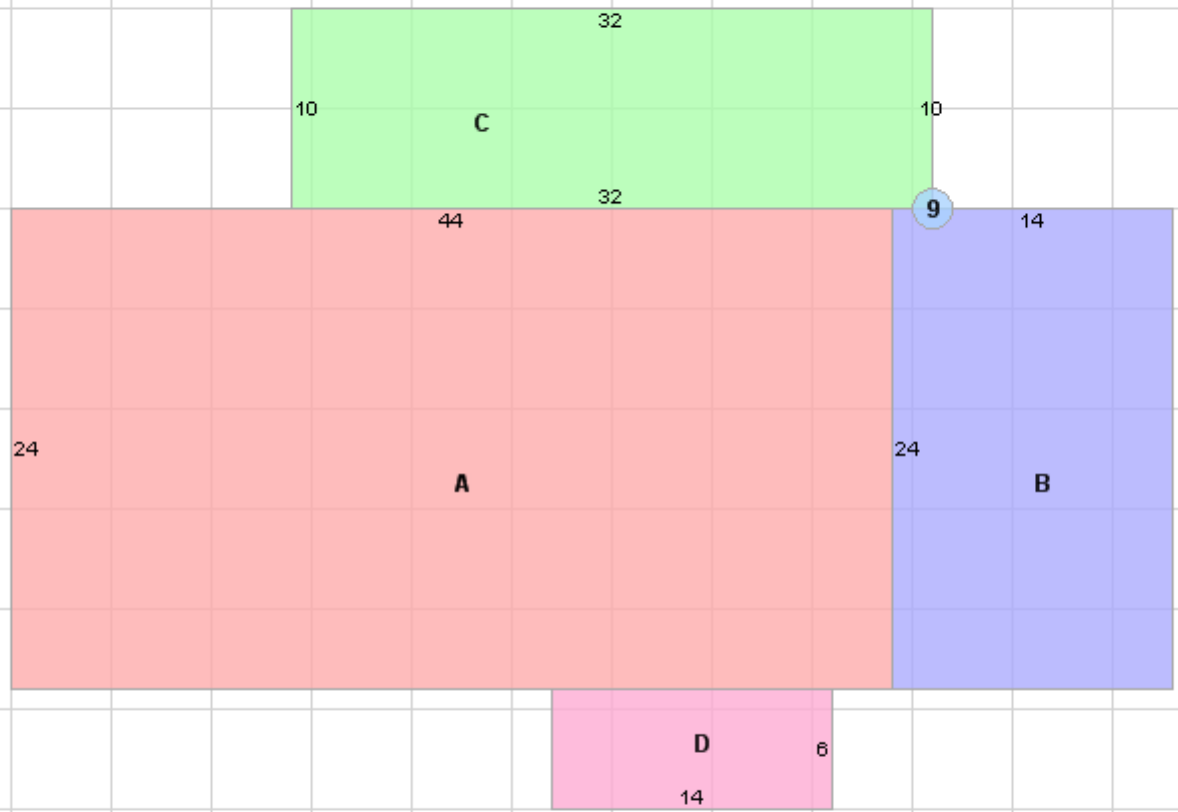

0.062s

Scale: 5 ft

ID

Label

Area

Perimeter

Dimension

ID	Label	Area	Perimeter	Dimension
A	$\frac{1 \text{ s Fr}}{B}$	1056	136	N/A
B	FG	336	76	N/A
C	EFP	320	84	N/A
D	BRDK	84	40	N/A
g		0	0	