

Ottawa County, Ohio - Property Record Card

Parcel: 0211773623819000 Card: 1

Owner THEIBERT JOSEPH L
Address 519 E ELEVENTH
Land Use (510) R - SINGLE FAMILY DWELLING, PLATTED LOT
Class RESIDENTIAL
Legal Description LOT 56 ANNA SLOAN SMITH
Tax Mailing Name THEIBERT JOSEPH L LENDER#77777
Tax Mailing Address 519 E 11TH ST, PORT CLINTON OH 43452-2024

MAP



SKETCH

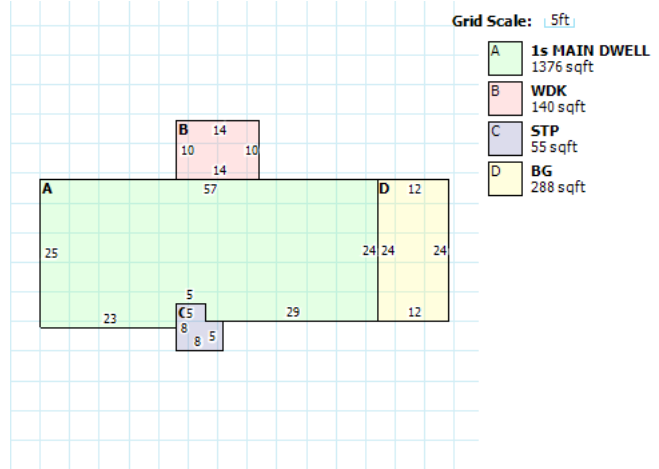

RESIDENTIAL

Building Style		FullBaths	1
Sq.Ft.	1376	Half Baths	1
Year Built	1959	Basement	FULL
Stories	1	Basement Area	0
Exterial Wall	BRICK	Rec Room Area	0
Rooms	6	Heat Fuel Type	GAS
Bedrooms	3	Heat/Cool	CENTRAL AIR CONDITION
Family Rooms	0	Attic	NONE
Fireplace Openings(Stacks)	1(1)	Trim	0

LAND

Code	Frontage	Depth	Acreage	SqFt	Value
1	82	165	N/A	N/A	\$27,410.0

VALUATION

	Appraised	Assessed
Land Value	\$27,410.00	\$9,590.00
Building Value	\$88,300.00	\$30,910.00
Total Value	\$115,710.00	\$40,500.00
CAUV Value	\$0.00	
Taxable Value	\$40,500.00	

PERMITS

IMPROVEMENTS

SALES

Date	Buyer	Seller	Price	Validity
8/6/2020	THEIBERT JOSEPH L	THEIBERT JOSEPH L &	\$0.00	UNVALIDATED
6/10/2004	THEIBERT JOSEPH L &	MONEY GAILE L	\$109,000.00	VALID SALE
1/16/2004	MONEY GAILE L	TEWERS CAROL L	\$0.00	UNVALIDATED
11/22/2002	TEWERS CAROL L	TEWERS CAROL L	\$0.00	UNVALIDATED
8/9/1996	TEWERS CAROL L	TEWERS HAROLD & CAROL J S&T	\$0.00	UNVALIDATED