

Summary

Parcel Number 0270411606001
Location Address 500 N TRIMBLE RD
 MANSFIELD 44906
Legal Description 15168 N CT PT 2.697 ACRES
 (Note: Not to be used on legal documents.)
Property Class C - COMMERCIAL
Land Use (410) C - MOTELS AND TOURIST CABINS
Neighborhood 02704C01
Tax District 02704
Acres 0
Sec/Twp/Rng --
Township MANSFIELD
School District MANSFIELD CITY SD
Municipality MANSFIELD
Topo LEVEL
Utilities ALL PUBLIC
Roads PAVED
Traffic HEAVY



027-04-116-06-001 06/01/2016

[View Map](#)

Owners

Owner
[MANSFIELD HOTEL LLC AN OHIO LIMITED](#)
 LIABILITY COMPANY
Mailing Address
 MANSFIELD HOTEL LLC
 14713 FLAGLER CT
 CENTREVILLE VA 20120

Treasurer Code DELQ. CONTRACTS

Valuation

Assessed Year	2020	2019	2018
Land Value	\$90,560.00	\$90,560.00	\$90,560.00
Building Value	\$687,760.00	\$687,760.00	\$687,760.00
Total Value (Assessed 35%)	\$778,320.00	\$778,320.00	\$778,320.00
Land Value	\$258,750.00	\$258,750.00	\$258,750.00
Building Value	\$1,965,040.00	\$1,965,040.00	\$1,965,040.00
CAUV Value	\$0.00	\$0.00	\$0.00
Total Value (Appraised 100%)	\$2,223,790.00	\$2,223,790.00	\$2,223,790.00

Taxes Due

Tax Year (click for detail)	1st Half Due	2nd Half Due	Delinquent	Total Due
<input type="checkbox"/> 2020	\$35,078.64	\$31,889.67	\$9,115.53	\$76,083.84
<input type="checkbox"/> 2018	\$0.00	\$0.00	\$0.00	\$0.00
<input type="checkbox"/> 2016	\$0.00	\$0.00	\$0.00	\$0.00
<input type="checkbox"/> 2015	\$0.00	\$0.00	\$0.00	\$0.00
<input type="checkbox"/> 2014	\$0.00	\$0.00	\$0.00	\$0.00
<input type="checkbox"/> 2013	\$0.00	\$0.00	\$0.00	\$0.00
<input type="checkbox"/> 2012	\$0.00	\$0.00	\$0.00	\$0.00
<input type="checkbox"/> 2011	\$0.00	\$0.00	\$0.00	\$0.00
<input type="checkbox"/> 2010	\$0.00	\$0.00	\$0.00	\$0.00

Land

Descr	P	LN	CD	Acres	Frontage	Depth	Base Size	Base Rate	Sq ft.	Incr / Decr	Land-Val
Primary Site	S	1	1	2.970	0	0	40,000.00	4	129,373	4 / 4	258,750

Total Acres:
 2.9700
Total Land-Value:
 258,750

Commercial Improvement Information

Card 1
Building No 1
Structure HTL/MTL LO
Year Built 1987
Effective Year 0
Grade C

Interior/Exterior Information

Card 1

Line	Sect	From	To	Sec	Occupancy	Occ Descr	Class	Yr Built	Eff Year	Size	Area	Perim	Height	Use Type	Phy Cond	UT	Base RCN	Feat RCN	Base Value	Pct Good	Pct Comp	Adj Value
1	1	01	01		0			1987	0		4220	224	12	MULT-USE OFC	2	4	252,060	8,467	260,530	56	0	145,900
2	2	01	01		0			1987	0		26135	1058	10	HOTEL	2	4	1,510,600	0	1,510,600	56	0	845,940
3	2	02	02		0			1987	0		26135	1058	10	HOTEL	2	4	1,479,500	0	1,479,500	56	0	828,520
4	3	01	01		0			1987	0		3600	260	12	MULTI SALES	2	4	163,620	0	163,620	45	0	73,630

Other Buildings & Yard Improvements

Card 1

Descr	Full Description	Type	Quantity	Year	Size	Area	Grade	Mods	Cond	F	MD%	Value
COMM POOL	COMMERCIAL SWIMMING POOL	SC1	1	1987	20 x 40	800	C-AVERAGE		A	A	0	18,680
ASPH PAVE	ASPHALT OR BLACKTOP PAVING	C11	1	1987		70,000	C-AVERAGE		A	A	51	52,370

Other Features

Card 1

Ln	Code	Descr	Meas 1	Meas 2	Stops	IU	Value
1	CP5	CANOPY ONLY	1080	1	0	1	8,467

Sales

Date	Book	Page	Grantor	Grantee	Price	Instr Type	Sale Validity	Qualified
5/23/2014			MANSFIELD MOTEL LTD	MANSFIELD HOTEL LLC AN OHIO LIMITED	\$2,550,000	WD	SALE INVOLVING MULTIPLE PARCELS	Unqualified
10/3/1996			MANSFIELD MOTEL	MANSFIELD MOTEL LTD	\$0		NOT VALIDATED	Unqualified

Recent Sales in Area

Sale date range:

From:

05/26/2018

To:

05/26/2021

Sales by Neighborhood

1500

Feet

Sales by Distance

Pay Property Taxes

Pay Property Tax

Photos



027-04-116-06-001 06/01/2016



027-04-116-06-001 06/01/2016



027-04-116-06-001 06/01/2016



027-04-116-06-001 05/13/2013



027-04-116-06-001 05/13/2013



027-04-116-06-001 05/13/2013

Sketches

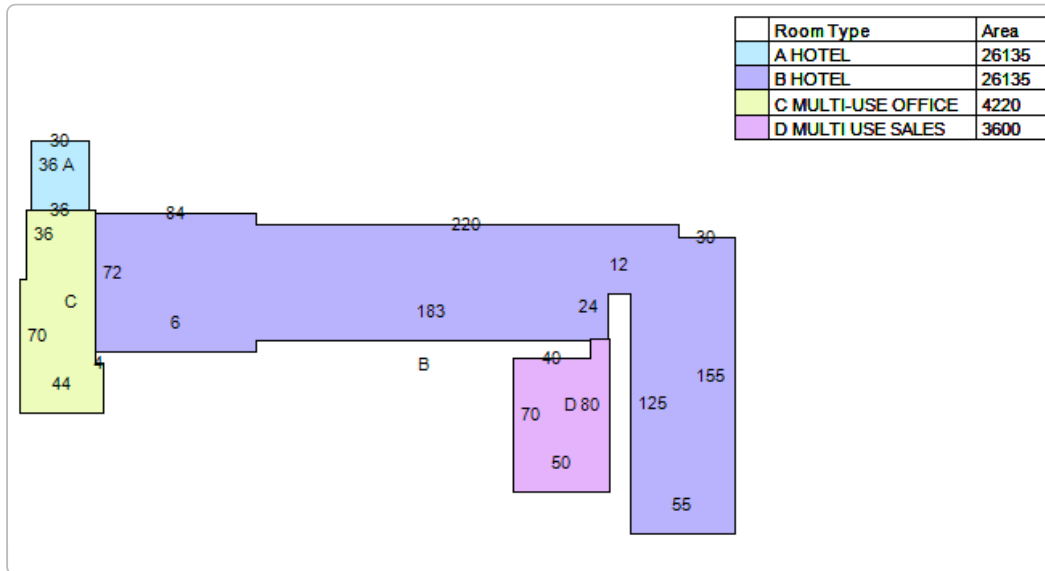

No data available for the following modules: Residential Improvement Information, Other Dwelling Features, Additions, Permits.

The information displayed on this map is taken from public records, and is intended to be used as a reference. Map information is believed to be accurate, but accuracy is not guaranteed. Richland County makes no warranties, express or implied, concerning the accuracy, completeness, or reliability of this information, and assumes no liability or any other legal responsibility for the information contained on this map. The map does not represent the official survey of the land.

[User Privacy Policy](#)
[GDPR Privacy Notice](#)

Last Data Upload: 5/26/2021, 7:37:25 AM

Developed by
 Schneider
 GEOSPATIAL

Version 2.3.122