

Gallia County, Ohio - Property Record Card

Parcel: 00100602600 Card: 1

Owner HAGER PAUL D & GERALDINE -SURV
Address 173 KELLEY DR
Land Use (510) R - SINGLE FAMILY DWELLING, PLATTED LOT
Class RESIDENTIAL
Legal Description L 26 COUNTRY AIR ESTATES 130.70'X165'X170.13'X 213' V272 P227

MAP



SKETCH

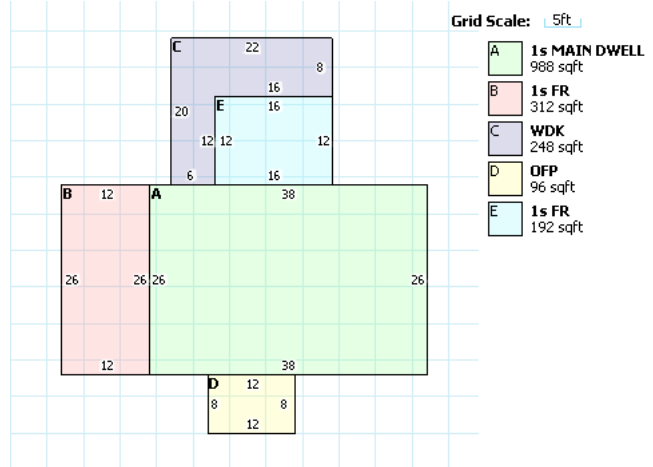

RESIDENTIAL

Building Style	RANCH	FullBaths	1
Sq.Ft.	1492	Half Baths	0
Year Built	1972	Basement	CRAWL
Stories	1	Basement Area	0
Exterial Wall	ALUMINUM/VINYL	Rec Room Area	0
Rooms	6	Heat Fuel Type	ELECTRIC
Bedrooms	3	Heat/Cool	HEAT PUMP
Family Rooms	1	Attic	NONE
Fireplace Openings(Stacks)	0(0)	Trim	0

LAND

Code	Frontage	Depth	Acreage	SqFt	Value
1	130	189	N/A	N/A	\$15,350.0

TENTATIVE 2011 VALUATION

	Appraised	Assessed
Land Value	\$15,350.00	\$5,370.00
Building Value	\$60,440.00	\$21,150.00
Total Value	\$75,790.00	\$26,520.00
CAUV Value		\$0.00
Taxable Value		\$26,520.00

PERMITS

IMPROVEMENTS

SALES

Date	Buyer	Seller	Price	Validity
12/23/199	HAGER PAUL D &	SPAUN ROBERT J &	\$42,443.00	6
12/1/1991			\$42,442.00	6
5/1/1988			\$41,900.00	0 VALID