

PROFILE

Parcel:	323015B119P	Land Use Code:	510
Alternate ID:		LUC Description:	RESIDENTIAL
Address:	2812 CAMPBELL LN	District:	32
Owner	GULLETT ANDREW F & BRYAR L	NBHD:	03014R32
Mailing	2812 CAMPBELL LANE	Tax District:	TATE TWP / BETHEL LSD
		Land Acres:	4.265

BETHEL OH 45106

Description:

PENDING CCPH ASSESSMENT (09/11/2018)

VALUE SUMMARY

Appraised Land:	32000	Assessed Land:	11200
Appraised Building:	112400	Assessed Building:	39340
Total:	144400	Assessed Total:	50540

PRIMARY RESIDENTIAL CARD

Card:	1	Basement:	FULL	Fireplace Pref.:	
Stories:	1	Square Feet:	1434	Basement Gar.:	0
Construction:	FRAME	HT/AC:	CENTRAL A/C	Fireplace OP/ST:	1
Style:	RANCH (Post 1940)	Fuel:	GAS	Grade:	C
Year Built:	1984	Attic:	NONE	Cond (CDU):	AV
Year Remod.:		Fin Basement:		% Complete:	
Total Rooms:	5	Rec Room:		Family Room:	0
Bedrooms:	3	Half Bath:	0		
Full Bath:	2				

COMMERCIAL CARD

Year Built:		Gross Flr. Area:	
Eff. Yr. Built:			
Units:			

SALES HISTORY

Date	Book-Page	Seller	Buyer	Amount
26-AUG-2009	2199--1990	BURGESS MARY E TR	GULLETT ANDREW F & BRYAR L	99,000
20-JAN-2005	1847--1174	VOGELGESANG MARY E	BURGESS MARY E TR	
06-FEB-2004	1740--1620	VOGELGESANG MARY E	VOGELGESANG MARY E	

MAP



PHOTO



323015B119P 12/19/2018

SKETCH

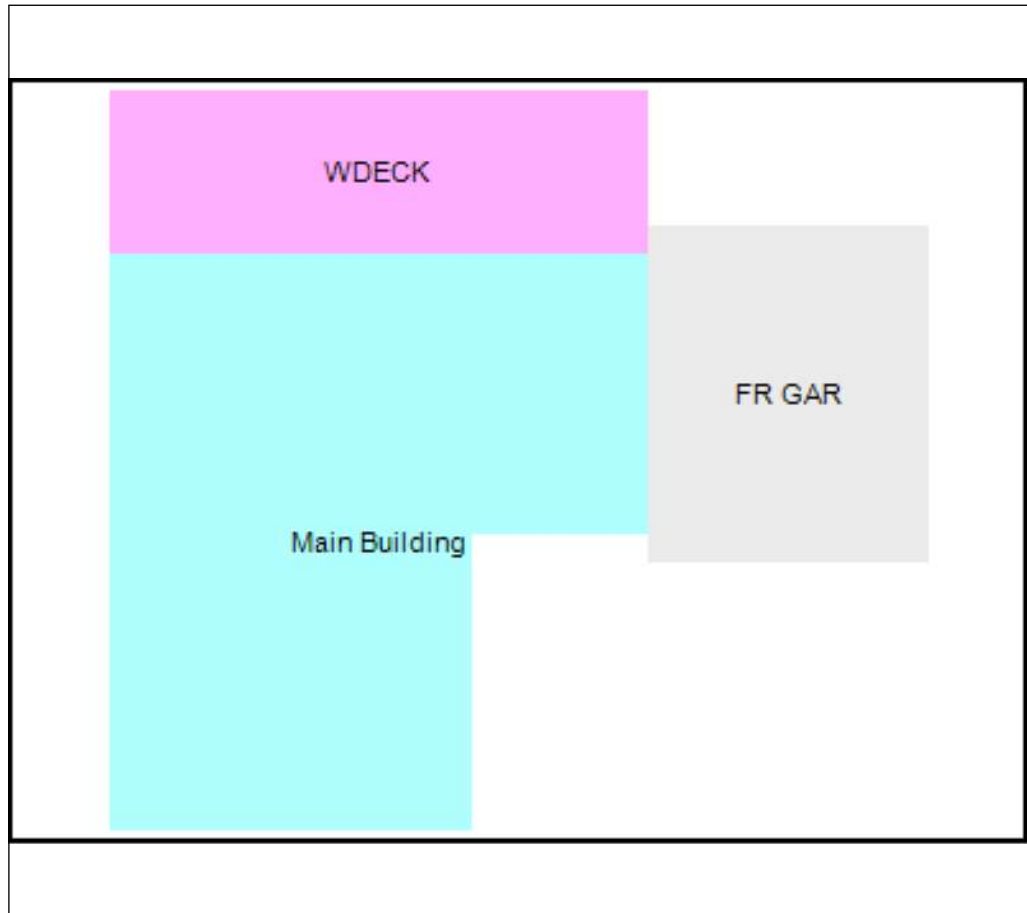

Sketch Legend

- 0 Main Building 1434 Sq. Ft.
- 1 WDECK - 31:WDDCK WOOD DECKS 480 Sq. Ft.
- 2 FR GAR - 13:FR GR FRAME GARAGE 525 Sq. Ft.