

**Owner** WHITE SHIRLEY A.  
**Address** 13711 SAYBROOK AVE  
 GARFIELD HEIGHTS, OH. 44105  
**Land Use** (5100) R - 1-FAMILY PLATTED LOT  
**Legal Description** 478 CRANLD#3 0653 ALL  
**Neighborhood Code** 09210

**SKETCH**

**MAP VIEW**

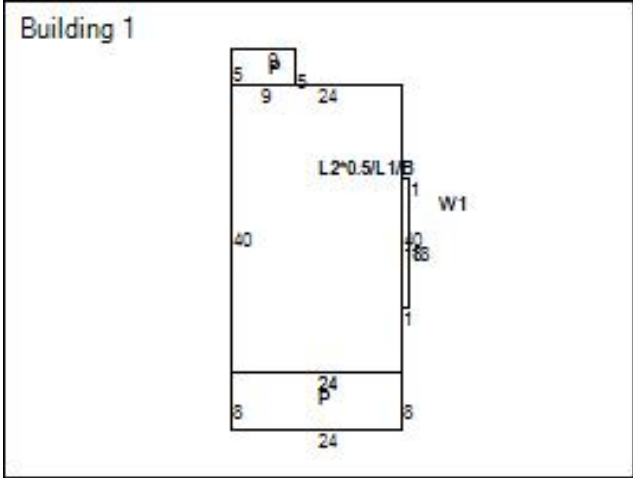

Map Image

**BUILDING INFORMATION**

Building Record Number	1	Occupancy	1-FAMILY	Story Height	1.5
Style	CAPE COD	Year Built	1929	Exterior Walls	ALUM/VINYL
Condition	AVERAGE	Construction Quality	C / AVERAGE	Roof Type	GABLE
Roof Material	ASPH-SHINGLE	Heat Type	FORCED-AIR	Air Conditioning	NONE
Attic Type	NONE	Basement Type	BASEMENT	Basement Square Feet	960
Basement Finished	N/A	Rooms	7	Bedrooms	4
Bathrooms (Full/Half)	1/0	Garage Type	DETACHED	Garage Capacity	2
Year Garage Built	2003	Garage Size	480	Living Area Basement	
Living Area 1	978	Living Area 2	480	Living Area Upper	
Living Area Total	1,458	Floor Location		Party Wall	

**LAND**

**VALUATION**

Code	Frontage	Depth	Acreage	Sq Ft
PRM	40	120	0.11	4,800

2019 Values	Taxable Market Value	Exempt Market Value	Abated Market Value	Assessed Taxable Value
Land Value	\$9,200	\$0	\$0	\$3,220
Building Value	\$45,100	\$0	\$0	\$15,790
Total Value	\$54,300	\$0	\$0	\$19,010
Land Use	5100			SINGLE FAMILY DWELLING

**PERMITS**

**IMPROVEMENTS**

Tax Year	Reason	Tax Change	Exempt Change	Percent Complete	Reinspect	Notes
2004	10 - Razing	(\$500)	\$	100%	No	GARAGE RAZED 100% COMP 1-1- 2004
2004	30 - New Construction	\$6,200	\$	100%	No	GARAGE REPLCMNT100% COMP 1-1- 2004

Type	Description	Size	Height Depth
------	-------------	------	--------------

**SALES**

Date	Buyer	Seller	Price
4/9/1992	White Shirley A.	White James Irvin	\$0
1/1/1975	White James Irvin		\$0

**Taxes**

2019 Taxes	Charges	Payments	Balance Due
Tax Balance Summary	\$4,600.17	\$93.00	\$4,507.17