



# Mike Kovack

Medina County Auditor

## Parcel Information

---

|                              |   |
|------------------------------|---|
| <b>Parcel Number</b>         | 003-18B-28-118                                    |
| <b>Owner Name</b>            | JANOWSKI JOHN & RHONDA M                          |
| <b>Address</b>               | 3126 PAXTON DR                                    |
| <b>City, State, Zip Code</b> | BRUNSWICK, OH 44212                               |
| <b>Property Class</b>        | 510 Property Class Codes                          |
| <b>Acreage</b>               | 0.290000  |
| <b>Legal Description</b>     | LOT 28 SL 51 WH ASHTON WOODS ESTAES PH 2 .2925 AC |

## Value

---

|                       |         |
|-----------------------|---------|
| <b>Land Value</b>     | 50,000  |
| <b>CAUV Value</b>     | 0       |
| <b>Building Value</b> | 178,120 |
| <b>Total Value</b>    | 228,120 |

## Taxable Value

---

|                               |        |
|-------------------------------|--------|
| <b>Taxable Land Value</b>     | 17,500 |
| <b>Taxable CAUV Value</b>     | 0      |
| <b>Taxable Building Value</b> | 62,340 |
| <b>Taxable Total Value</b>    | 79,840 |

## Dwelling Information

---

|                           |                  |
|---------------------------|------------------|
| <b>Card Number</b>        | 001              |
| <b>Year Built</b>         | 1998             |
| <b>Story Height</b>       | 2.00000          |
| <b>Extension Walls</b>    | Siding-Wide      |
| <b>Fireplace Openings</b> | 1                |
| <b>Heating</b>            | Central Warm Air |
| <b>Central Air</b>        | Yes              |
| <b>Full Baths</b>         | 2                |
| <b>Half Baths</b>         | 1                |
| <b>Bedrooms</b>           | 4                |

### Dwelling Information

|                                |               |
|--------------------------------|---------------|
| <b>Attic</b>                   | None          |
| <b>Attic Area</b>              | 0             |
| <b>Second Floor Area</b>       | 1293          |
| <b>Upper Floor Area</b>        | 0             |
| <b>First Floor Area</b>        | 1269          |
| <b>Basement</b>                | Full Basement |
| <b>Basement Area</b>           | 1256          |
| <b>Garage Area</b>             | 754           |
| <b>Open Masonry Porch Area</b> | 48            |
| <b>Wood Deck Area</b>          | 462           |

### Dwelling Sketch - Card Number 001

3

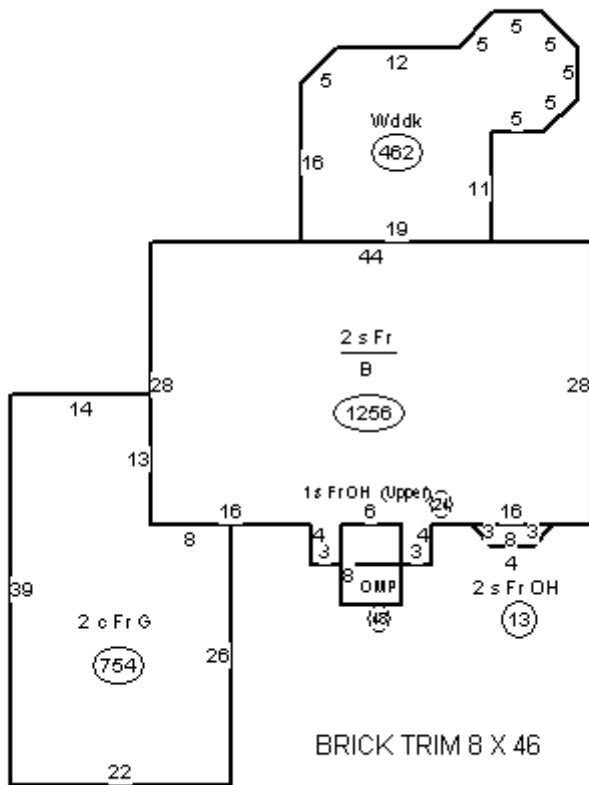

**Other Improvements**

---

| <b>Card Number</b> | <b>Key</b> | <b>Improvement</b>               | <b>Width</b> | <b>Length</b> | <b>Area</b> | <b>Year Built</b> |
|--------------------|------------|----------------------------------|--------------|---------------|-------------|-------------------|
| 001                | 03         | Residential Shed -<br>Small Util | 8            | 12            | 96          | 2004              |