

Property Record Card - Alan Harold, Stark County Auditor

Generated 10/3/2019 11:38:34 AM

Subject Property	
Parcel	7504458
Owner	BROWNLEE FERRELL M
Address	6381 UNION AVE NE ALLIANCE OH 44601-8139
Mailing Address Line 1	BROWNLEE FERRELL M
Mailing Address Line 2	6381 UNION AVE NE
Mailing Address Line 3	ALLIANCE OH 44601
Legal Description	14 PSE 5.21A
Last Inspected	03/22/2018
Property Class	RESIDENTIAL
DTE Classification	510 - 1-FAMILY DWELLING
Tax District	00720 WASHINGTON TWP - MARLINGTON LSD
School District	7608 MARLINGTON LSD
Township	WASHINGTON TOWNSHIP
City	UNINCORPORATED
Neighborhood	075-02-01-01
Map Routing Number	75 014SE 01 1400

Allotments	
Allotment	Lot
No Allotment Information Available	

Valuation Details						
Year	Appraised Land Value	Assessed Land Value	Appraised Building Value	Assessed Building Value	Appraised Total Value	Assessed Total Value
2018	\$62,800	\$21,990	\$87,800	\$30,740	\$150,600	\$52,730
2017	\$56,300	\$19,710	\$77,600	\$27,170	\$133,900	\$46,880
2016	\$56,300	\$19,710	\$77,600	\$27,170	\$133,900	\$46,880
2015	\$56,300	\$19,710	\$77,600	\$27,170	\$133,900	\$46,880
2014	\$52,300	\$18,310	\$72,000	\$25,210	\$124,300	\$43,520
2013	\$52,300	\$18,310	\$72,000	\$25,210	\$124,300	\$43,520
2012	\$52,300	\$18,310	\$72,000	\$25,210	\$124,300	\$43,520
2011	\$44,300	\$15,510	\$107,900	\$37,780	\$152,200	\$53,290
2010	\$44,300	\$15,510	\$107,900	\$37,780	\$152,200	\$53,290
2009	\$44,300	\$15,510	\$107,900	\$37,780	\$152,200	\$53,290
2008	\$44,200		\$112,600		\$156,800	\$54,880

Land Details								
Description	Acreage	Frontage	Depth	Area (sqft)	Method	Rate	Adj %	Value
ROADWAY	0.12				AC	\$.00	0	\$0
WASTE	0.50				AC	\$2,200.00	0	\$1,000
TILLABLE	3.59				AC	\$12,700.00	0	\$40,500
HOUSE LOT	1.00				AC	\$20,000.00	0	\$21,300

Sales Details						
Date	Work Order Number	Work Order Year	Number Of Parcels	Arms Length	Sale Price	Taxable Value
10/30/2001	13715	2001	0	NO	\$0	\$34,270

Details for Primary Building 7781751					
Building Type	15 - BUNGALOW	Construction Type	1 - WOOD FRAME	Full Baths	1
Year Built	1890	Quality Basement Finish	0 - NONE	Half Baths	0
Number Of Stories	1.50	Percent Complete	100	Basement	1 - FULL
Condition	3 - AVERAGE	Heat Type	GAS	Number Of Fireplaces	1
Living Area	1608	Central Air	YES	Family Room	NO
Quality Grade	100	Number Of Bedrooms	3	Primary Value	\$59,500

Details for Improvement 6364119					
Building Type	920 - PERSONAL PROPERTY BLDG	Adjustment Percent	0	Year Built	0
Number Of Stories	0	Value	0	Reason	-
Frontage	8.00	Common Walls	0	Condition	NOT AVAILABLE
Depth	8	Construction Type	NOT AVAILABLE	Grade	0
Area (sqft)	64	Height	0	Value	0

Details for Improvement 6364118					
Building Type	920 - PERSONAL PROPERTY BLDG	Adjustment Percent	0	Year Built	0
Number Of Stories	0	Value	0	Reason	-
Frontage	8.00	Common Walls	0	Condition	NOT AVAILABLE
Depth	12	Construction Type	NOT AVAILABLE	Grade	0
Area (sqft)	96	Height	0	Value	0

Details for Improvement 6364117					
Building Type	140 - GARAGE	Adjustment Percent	0	Year Built	2003
Number Of Stories	1.0	Value	9,400	Reason	-
Frontage	40.00	Common Walls	1	Condition	GOOD
Depth	32	Construction Type	POLE	Grade	80
Area (sqft)	1,280	Height	NONE	Value	9,400

Details for Improvement 6364115					
Building Type	120 - CARPORT	Adjustment Percent	0	Year Built	2007
Number Of Stories	1.0	Value	4,400	Reason	-
Frontage	14.00	Common Walls	1	Condition	GOOD
Depth	70	Construction Type	POLE	Grade	100
Area (sqft)	980	Height	NONE	Value	4,400

Details for Improvement 6364116					
Building Type	102 - BARN, FLAT	Adjustment Percent	0	Year Built	1986
Number Of Stories	1.5	Value	10,200	Reason	-
Frontage	40.00	Common Walls	1	Condition	AVERAGE
Depth	40	Construction Type	WOOD FRAME	Grade	100
Area (sqft)	1,600	Height	0	Value	10,200

Details for Improvement 6364114					
Building Type	100 - BARN, BANK	Adjustment Percent	0	Year Built	1920
Number Of Stories	1.5	Value	4,300	Reason	-
Frontage	30.00	Common Walls	0	Condition	AVERAGE
Depth	30	Construction Type	WOOD FRAME	Grade	100
Area (sqft)	900	Height	0	Value	4,300



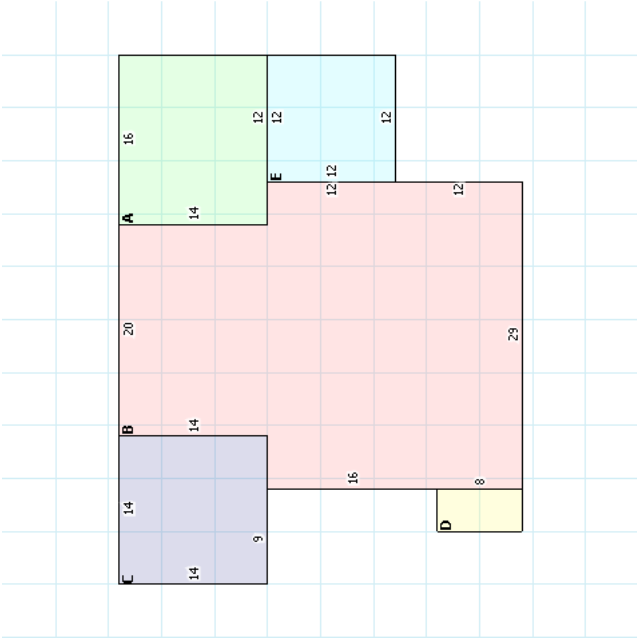

7504458 Building ID 7781751