

Wood County, Ohio - Property Record Card, Page 1
 Parcel: G27-309-250301019000

GENERAL PARCEL INFORMATION

Owner GIBSON DONALD E
 Property Address 2422 MAPLE ST
 Mailing Address PO BOX 54
 HOYTVILLE OH 43529
 Land Use 510 - SINGLE FAMILY DWLG
 Neighborhood 02901
 School District MCCOMB LSD
 Total Acres 0.4649
 Legal Description EPT NW SW S OF CH LOT

VALUATION

	Appraised	Assessed
Land Value	\$9,900.00	\$3,470.00
Improvements Value	\$26,700.00	\$9,350.00
CAUV Value	\$0.00	\$0.00
Taxable Value	\$12,820.00	

MAP



LAND

Land Type	Acres	Depth	Frontage	Depth Factor	Value
L1 - Regular Lot	0.4649	157	129	102	9870

SALES

Date	Buyer	Seller	Price
3/4/2015	GIBSON DONALD E	GIBSON BRAD A	\$0.00
12/18/2012	GIBSON BRAD A	GIBSON DONALD E	\$0.00
1/5/2012	GIBSON DONALD E	GIBSON LESA	\$0.00
6/28/2002	GIBSON LESA	BEAR EDWARD JR & KARIE	\$16,000.00
12/2/1997	BEAR EDWARD JR & KARIE	GIBSON DONALD E	\$41,500.00
6/12/1991	GIBSON DONALD E		\$8,000.00

AGRICULTURAL

Land Type	Land Usage	Soil Type	Acres	Value

TAX

	1st Half	2nd Half
Charge:	\$391.52	\$391.52
Credit:	(\$100.05)	(\$100.05)
Rollback:	(\$24.27)	(\$24.27)
Reduction:	\$0.00	\$0.00
Homestead:	\$0.00	\$0.00
Sales Credit:	\$0.00	\$0.00
CAUV Recoupment:	\$0.00	\$0.00
Special Assessments:	\$108.52	\$98.63
Penalties/Adjustments:	\$0.00	\$0.00
Delinquencies:	\$668.80	
Net Owed:		\$1,437.07
Net Paid:		\$0.00
Net Due:		\$1,437.07

PAYMENTS

Payment Date	Prior Paid	First Half Paid	Second Half
5/4/2018	\$0.10	\$0.00	\$0.00
5/4/2018	\$0.00	\$0.34	\$0.00
5/4/2018	\$53.56	\$0.00	\$0.00
5/4/2018	\$0.00	\$0.07	\$0.00
5/4/2018	\$0.00	\$10.29	\$0.00
5/4/2018	\$10.71	\$0.00	\$0.00
5/4/2018	\$0.09	\$0.00	\$0.00
5/4/2018	\$0.00	\$0.01	\$0.00
5/4/2018	\$61.29	\$0.00	\$0.00
5/4/2018	\$0.00	\$6.74	\$0.00
5/4/2018	\$395.30	\$0.00	\$0.00

Wood County, Ohio - Property Record Card, Page 2

Parcel: G27-309-250301019000

Card: 1

GENERAL PARCEL INFORMATION

Owner: GIBSON DONALD E
 Property Address: 2422 MAPLE ST
 Mailing Address: PO BOX 54
 HOYTVILLE OH 43529
 Land Use: 510 - SINGLE FAMILY DWLG
 Neighborhood: 02901
 School District: MCCOMB LSD
 Total Acres: 0.4649
 Legal Description: EPT NW SW S OF CH LOT

RESIDENTIAL

Building Style: CONVENTIONAL
 Year Built: 1900
 Stories: 1.5
 Finished Area: 1064
 First Floor Area: 844
 Half Floor Area: 220
 Upper Floor Area: 0
 Rooms: 5
 Bedrooms: 2
 Family Rooms: 0
 Full Baths: 1
 Half Baths: 0
 Basement: CRAWL
 Finished Basement Area: 0
 Heating: BASE
 Cooling: NONE
 Exterior Wall: FRAME/SIDING
 Attic: NONE
 Number of Fireplace Openings: 0
 Number of Fireplace Stacks: 0

COMMERCIAL

SKETCH

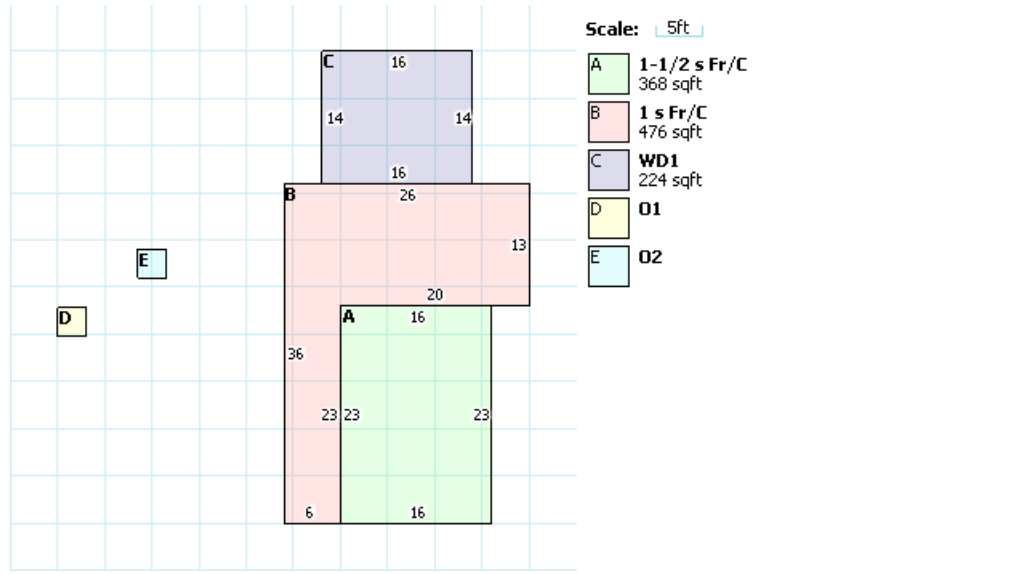

IMPROVEMENTS

Description	Year Built	Dimensions	Area	Value
Shed - No Value - X	1990	12x12	144	\$0.00
Garage Frame - 1	1973	24x20	480	\$1,030.00

ADDITIONS

Description	Area	Year Built	Value
WD1 - Wood Deck	224	0	\$3,080.00



E WALNUT ST



S MAPLE ST



100 feet

AccuGlobe
Map Engine