

# Jackson County, Ohio - Property Record Card

Parcel: M240230026200 Card: 1

Owner VANOVER DAVIS E  
Address 301 S NEW YORK AVE  
Land Use (510) R - SINGLE FAMILY DWELLING, PLATTED LOT  
Class RESIDENTIAL  
Legal Description AUSTIN LOT #27

## MAP



## SKETCH

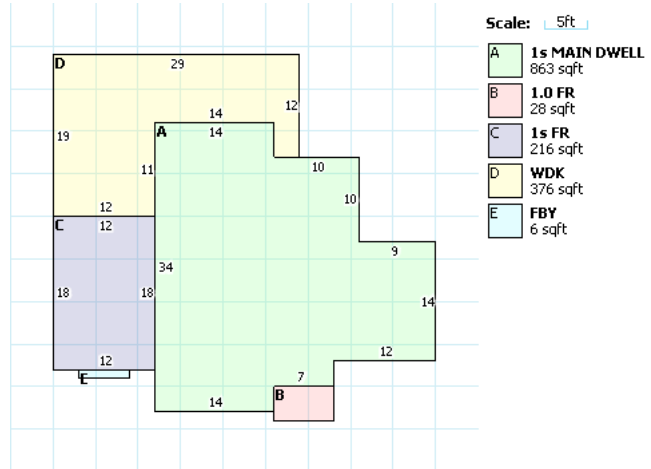

## RESIDENTIAL

Building Style	OTHER	FullBaths	1
Sq.Ft.	1085	Half Baths	0
Year Built	1945	Basement	PART
Stories	1	Basement Area	0
Exterior Wall	ALUMINUM/VINYL	Rec Room Area	0
Rooms	5	Heat Fuel Type	GAS
Bedrooms	2	Heat/Cool	CENTRAL AIR CONDITION
Family Rooms	1	Attic	NONE
Fireplace Openings(Stacks)	0(0)	Trim	0

## LAND

Code	Frontage	Depth	Acreage	SqFt	Value
1	60	60	N/A	N/A	\$7,560.00

## VALUATION

	Appraised	Assessed
Land Value	\$7,560.00	\$2,650.00
Building Value	\$52,370.00	\$18,330.00
Total Value	\$59,930.00	\$20,980.00
CAUV Value	\$0.00	
Taxable Value	\$20,980.00	

## PERMITS

## IMPROVEMENTS

Card	Description	Year Built	Dimensions	Value
1	RG1 - FRAME	1993	16x21	\$4,250.00

## SALES

Date	Buyer	Seller	Price	Validity
3/21/2011	VANOVER DAVIS E	EYNON JILLIAN N &	\$88,000.00	1 MULTI PARCEL
7/2/2004	EYNON JILLIAN N &	GOODSON CHARLES M & KRYSTAL G	\$98,000.00	1 MULTI PARCEL
10/17/200	GOODSON CHARLES M & KRYSTAL G	WILSON THORTON R	\$95,000.00	1 MULTI PARCEL

# Data For Parcel M240230026200

## Tax Data

**Parcel:** M240230026200  
**Owner:** VANOVER DAVIS E  
**Address:** 301 S NEW YORK AVE



[+] Map this property.

**Change Tax Year:** 2018 ▾

## Property Tax

	Tax Year 2018 Payable 2019	
	First Half	Second Half
<b>Gross Charge:</b>	\$498.80	\$498.80
<b>Reduction Factor:</b>	(\$26.96)	(\$26.96)
<b>10% Rollback:</b>	(\$41.79)	(\$41.79)
<b>2.5% Homesite Rollback:</b>	\$0.00	\$0.00
<b>Homestead Reduction:</b>	\$0.00	\$0.00
<b>Special Assessments:</b>	\$0.00	\$0.00
<b>CAUV Recoupment:</b>	\$0.00	\$0.00
<b>Penalties And Adjustments:</b>	\$43.01	\$0.00
<b>Subtotals:</b>	\$473.06	\$430.05
<b>Prior Charges:</b>	\$458.03	
<b>Full Year Total:</b>	\$1,361.14	
<b>Payments:</b>	\$0.00	
<b>Half Year Due:</b>	\$931.09	
<b>Full Year Due:</b>	\$1,361.14	

## Special Assessments

No data found for this parcel.

## Payments

Date	Amount
3/5/2018	(\$410.93)

GIS parcel shapefile last updated 4/25/2019 5:19:36 AM.

The CAMA data presented on this website is current as of 4/19/2019 7:04:21 PM.

# Data For Parcel M240230027402

## Tax Data

**Parcel:** M240230027402  
**Owner:** VANOVER DAVIS E  
**Address:** 0 NEW YORK AVE & 3RD ST



[+] Map this property.

**Change Tax Year:** 2018 ▾

## Property Tax

	Tax Year 2018 Payable 2019	
	First Half	Second Half
<b>Gross Charge:</b>	\$31.39	\$31.39
<b>Reduction Factor:</b>	(\$1.70)	(\$1.70)
<b>10% Rollback:</b>	(\$2.63)	(\$2.63)
<b>2.5% Homesite Rollback:</b>	\$0.00	\$0.00
<b>Homestead Reduction:</b>	\$0.00	\$0.00
<b>Special Assessments:</b>	\$0.00	\$0.00
<b>CAUV Recoupment:</b>	\$0.00	\$0.00
<b>Penalties And Adjustments:</b>	\$2.71	\$0.00
<b>Subtotals:</b>	\$29.77	\$27.06
<b>Prior Charges:</b>	\$28.83	
<b>Full Year Total:</b>	\$85.66	
<b>Payments:</b>	\$0.00	
<b>Half Year Due:</b>	\$58.60	
<b>Full Year Due:</b>	\$85.66	

## Special Assessments

No data found for this parcel.

## Payments

Date	Amount
3/5/2018	(\$25.86)

GIS parcel shapefile last updated 4/25/2019 5:19:36 AM.

The CAMA data presented on this website is current as of 4/19/2019 7:04:21 PM.

# Data For Parcel M240230027502

## Tax Data

**Parcel:** M240230027502  
**Owner:** VANOVER DAVIS E  
**Address:** 0 PENN AVE



[+] Map this property.

**Change Tax Year:** 2018 ▾

## Property Tax

	Tax Year 2018 Payable 2019	
	First Half	Second Half
<b>Gross Charge:</b>	\$27.84	\$27.84
<b>Reduction Factor:</b>	(\$1.52)	(\$1.52)
<b>10% Rollback:</b>	(\$2.33)	(\$2.33)
<b>2.5% Homesite Rollback:</b>	\$0.00	\$0.00
<b>Homestead Reduction:</b>	\$0.00	\$0.00
<b>Special Assessments:</b>	\$0.00	\$0.00
<b>CAUV Recoupment:</b>	\$0.00	\$0.00
<b>Penalties And Adjustments:</b>	\$2.40	\$0.00
<b>Subtotals:</b>	\$26.39	\$23.99
<b>Prior Charges:</b>	\$25.54	
<b>Full Year Total:</b>	\$75.92	
<b>Payments:</b>	\$0.00	
<b>Half Year Due:</b>	\$51.93	
<b>Full Year Due:</b>	\$75.92	

## Special Assessments

No data found for this parcel.

## Payments

Date	Amount
3/5/2018	(\$22.91)

GIS parcel shapefile last updated 4/25/2019 5:19:36 AM.

The CAMA data presented on this website is current as of 4/19/2019 7:04:21 PM.