

Jackson County, Ohio - Property Record Card

Parcel: M240060001000 Card: 1

Owner EMMERT JAMES C
Address 415 N PENN AVE
Land Use (510) R - SINGLE FAMILY DWELLING, PLATTED LOT
Class RESIDENTIAL
Legal Description ORIGINAL 17-18 N1/2

MAP



SKETCH

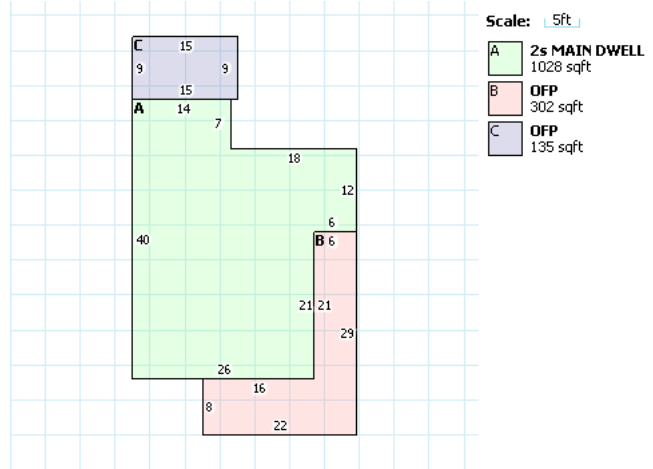

RESIDENTIAL

Building Style	OTHER	FullBaths	1
Sq.Ft.	2056	Half Baths	1
Year Built	1900	Basement	PART
Stories	2	Basement Area	0
Exterial Wall	ALUMINUM/VINYL	Rec Room Area	0
Rooms	10	Heat Fuel Type	GAS
Bedrooms	3	Heat/Cool	CENTRAL
Family Rooms	0	Attic	NONE
Fireplace Openings(Stacks)	0(0)	Trim	0

LAND

Code	Frontage	Depth	Acreage	SqFt	Value
1	92	120	N/A	N/A	\$13,680.0

VALUATION

	Appraised	Assessed
Land Value	\$13,680.00	\$4,790.00
Building Value	\$45,420.00	\$15,900.00
Total Value	\$59,100.00	\$20,690.00
CAUV Value	\$0.00	
Taxable Value	\$20,690.00	

PERMITS

IMPROVEMENTS

Card	Description	Year Built	Dimensions	Value
1	RG1 - FRAME	1960	24x24	\$1,700.00

SALES

Date	Buyer	Seller	Price	Validity
11/1/2010	EMMERT JAMES C	JACKSON PAMELA M &	\$50,000.00	0 VALID
10/20/199	JACKSON PAMELA M &		\$38,000.00	0 VALID
10/20/199	JACKSON PAMELA M &	RUPERT PAUL J	\$38,000.00	0 VALID

Data For Parcel M240060001000

Tax Data

Parcel:
 Owner:
 Address:



[+] Map this property.

Change Tax Year: ↕

Property Tax

	Tax Year 2018 Payable 2019	
	First Half	Second Half
Gross Charge:	\$491.93	\$491.93
Reduction Factor:	(\$26.62)	(\$26.62)
10% Rollback:	(\$41.21)	(\$41.21)
2.5% Homesite Rollback:	(\$10.30)	(\$10.30)
Homestead Reduction:	\$0.00	\$0.00
Special Assessments:	\$0.00	\$0.00
CAUV Recoupment:	\$0.00	\$0.00
Penalties And Adjustments:	\$41.38	\$0.00
Subtotals:	\$455.18	\$413.80
Prior Charges:	\$4,409.88	
Full Year Total:	\$5,278.86	
Payments:	\$0.00	
Half Year Due:	\$4,865.06	
Full Year Due:	\$5,278.86	

Special Assessments

No data found for this parcel.

Payments

No data found for this parcel.

GIS parcel shapefile last updated 4/24/2019 5:19:22 AM.

The CAMA data presented on this website is current as of 4/19/2019 7:04:21 PM.