

Lawrence County, Ohio - Property Record Card
 Parcel: 14-047-1600.000
 Card: 1

GENERAL PARCEL INFORMATION

Owner PRESTON MICHAEL AND DEANNA
 Property Address 801 CO RD 6
 Mailing Address 801 CO. RD. 6
 Ironton OH 45638
 Map Number
 Routing Number 14-00200-109000
 Land Use 510 - SINGLE FAMILY RESIDENCE
 Legal Description 17-03-32 PT. N 1/2 SW
 0000.70A

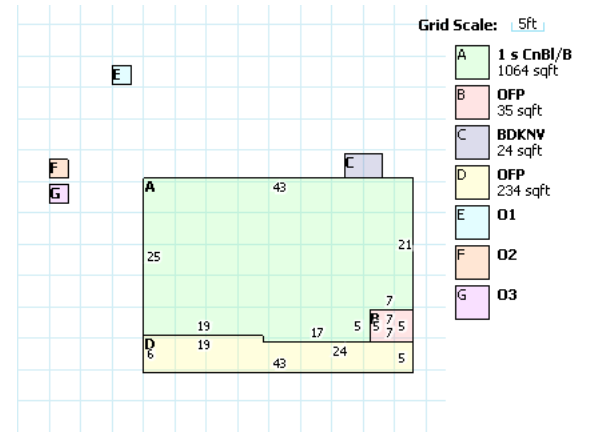

VALUATION

	Appraised	Assessed
Land Value	\$8,470.00	\$2,960.00
Improvements Value	\$49,290.00	\$17,250.00
CAUV Value	\$0.00	\$0.00
Taxable Value		\$20,210.00

RESIDENTIAL

Building Style	BUNGALOW	Full Baths	1
Year Built	1957	Half Baths	0
Stories	1	Basement	FULL BASEMENT
Finished Area	1064	Finished Basement Area	0
First Floor Area	1064	Heating	CENTRAL WARM AIR
Half Floor Area	0	Cooling	NONE
Upper Floor Area	0	Exterior Wall	CONCRETE BLOCK
Rooms	5	Attic	NONE
Bedrooms	2	Number of Fireplace Openings	0
Family Rooms	0	Number of Fireplace Stacks	0

LAND

Land Type	Acreage	Depth	Frontage	Depth	Value
HS - Homesite	0.7	0	0	100	8470

ADDITIONS

Description	Area	Year Built	Value
OFF - Opn Fr Porch	234	0	\$4,180.00
OFF - Opn Fr Porch	35	0	\$620.00
BDKNV - Br Deck NV	24	0	\$0.00

IMPROVEMENTS

Description	Year Built	Dimension	Area	Value
920 Personal	1985	12x8	96	\$0.00
161 Lean To -	1965	20x10	200	\$80.00
Det Fr Garage -	1958	20x14	280	\$970.00

AGRICULTURAL

Land Type	Land Usage	Soil Type	Acres	Value
-----------	------------	-----------	-------	-------

SALES

Date	Buyer	Seller	Price
4/25/2014	PRESTON MICHAEL AND	PRESTON KENNETH R	50000
8/11/1992	PRESTON KENNETH R	CLAY, CHARLES E ETAL	20363
8/6/1992	CLAY, CHARLES E ETAL	CLAY, BILLIE J. JR	0

COMMERCIAL

Grid Scale: 5ft

- A** 1 s CnBI/B
1064 sqft
- B** OFP
35 sqft
- C** BDKNV
24 sqft
- D** OFP
234 sqft
- E** O1
- F** O2
- G** O3

