

Parcel ID: 82-38024

ANITA LOPEZ - LUCAS COUNTY AUDITOR

RESIDENTIAL/AGRICULTURAL

Owner: FLORIANA DONNA J (TRUSTEE)
5320 SILVERTOWN DR

Card 1 of 1
Assr #: 45088008

Market Area: 1906R
DTE #: 00290 - SYLVANIA CITY - SYLVANIA CSI

Tax Year: 2018
LUC: 510 - 1FAM-PLAT

GENERAL INFORMATION

Topo: Spec Use: 510-1 Family-Plat
Street: 1 - Paved Traffic: 6-Resside
Utilities: 22 - City Water / City Sewer Corner Lot: Yes
Legal: COOPER PLACE LOT 39 EXC E 12 FT

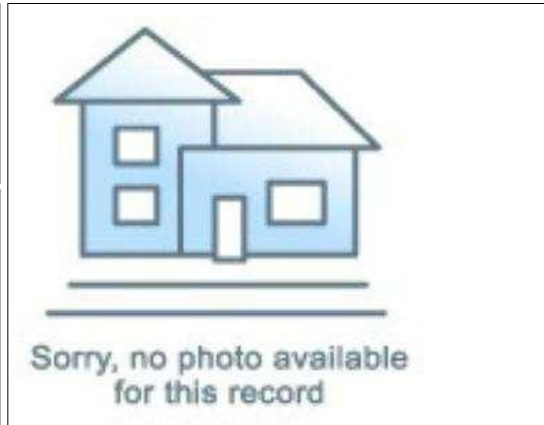

ADMINISTRATIVE

| DATE | SOURCE | ENTRY | ADMIN | DATA ENTRY | REVIEWER |
|----------|---------|----------|------------------------|------------|----------|
| 06/22/01 | 1-Owner | 3-Atdoor | 237-Final Value Review | 920 | 70 |

LAND INFORMATION

| TYPE | CODE | FRONT | DEPTH | SQFT | AC | INFL1 | INFL2 |
|------|---------------------|-------|-------|--------|-------|--------|--------|
| 1 | 01-Residential Land | 63 | 168 | 10,600 | .2433 | 1-None | 1-None |

PERMITS

| DATE | TAXYR | PERMIT # | PURPOSE | STATUS | % COMP |
|----------|-------|----------|-------------------|----------------|--------|
| 06/16/00 | 2001 | 20001003 | RES ALT - Res Alt | C - Closd Prmt | 100 |
| 08/13/99 | 2000 | 9901169H | AC - A/C | C - Closd Prmt | 100 |

Total SF: 10,600 Total AC: .2433

SALES/TRANSFER HISTORY

| DATE | CONV # | # OF PARCELS | DEED | VALIDITY | TYPE | PRICE |
|----------|----------|--------------|------|------------|---------------------|-------|
| 04/29/11 | 11202257 | 3 | AF | 8 - Unrevd | 2 - Land & Building | |
| 09/15/06 | 06206255 | 2 | QC | 8 - Unrevd | 2 - Land & Building | |

CONDO COMPLEX

| COMPLEX # | COMPLEX NAME | YR DECLARED | # BLDGS | # UNITS |
|-----------|--------------|-------------|---------|---------|
|-----------|--------------|-------------|---------|---------|

VALUE HISTORY

| 2018 | | 2017 | | 2016 | | 2015 | | 2014 | | 2013 | | 2012 | |
|-------|-----------|-------|-----------|-------|-----------|-------|-----------|-------|----------|-------|----------|-------|----------|
| CLASS | R | CLASS | R | CLASS | R | CLASS | R | CLASS | R | CLASS | R | CLASS | R |
| 100% | L 25,700 | 100% | L 27,000 | 100% | L 27,000 | 100% | L 27,000 | 100% | L 26,000 | 100% | L 26,000 | 100% | L 26,000 |
| | B 85,700 | | B 76,800 | | B 76,800 | | B 76,800 | | B 73,800 | | B 73,800 | | B 73,800 |
| | T 111,400 | | T 103,800 | | T 103,800 | | T 103,800 | | T 99,800 | | T 99,800 | | T 99,800 |
| 35% | L 9,000 | 35% | L 9,450 | 35% | L 9,450 | 35% | L 9,450 | 35% | L 9,100 | 35% | L 9,100 | 35% | L 9,100 |
| | B 30,000 | | B 26,880 | | B 26,880 | | B 26,880 | | B 25,830 | | B 25,830 | | B 25,830 |
| | T 39,000 | | T 36,330 | | T 36,330 | | T 36,330 | | T 34,930 | | T 34,930 | | T 34,930 |

Parcel ID: 82-38024

ANITA LOPEZ - LUCAS COUNTY AUDITOR

RESIDENTIAL/AGRICULTURAL

Owner: FLORIANA DONNA J (TRUSTEE)
5320 SILVERTOWN DR

Card 1 of 1
Assr #: 45088008

Market Area: 1906R
DTE #: 00290 - SYLVANIA CITY - SYLVANIA CSI

Tax Year: 2018
LUC: 510 - 1FAM-PLAT

DWELLING INFORMATION

Occupancy: 2 - Onfam Style: 17 - Other - Standard Cdu
Main SH: 2 - One Story With Attic Max SH: 5 - One And One Half Story
Attic: 5 - Finished Grade: 15 - C-
Basement: 2 - Crawl Condition: AV - Av
Construction: 7 - Part Brick TLA: 2196
Fin Basement: 0 Year Built: 1960 Eff Yr:
Pct Complete: 100 Remodel Year: 1999 Type: 3 - Heat

CONDO INFORMATION

Complex #: Condo Type:
Unit #: Level:
View:

INTERIOR CHARACTERISTICS

Bedrooms: 3 Full Baths: 1
Total Rooms: 6 Half Baths: 1
HVAC: C - Forced Air Heat W/C Additional Fixtures: 0
WB Fire Places: 0
Gas Fire Places:
Stacks: 0

DWELLING CALCULATIONS

Effective Year: Adjusted Base: 68320 Dwelling RCN: 101025
% Good: Plumbing: 0 Total RCN: 101025
% Good Override: Basement: 0 RCN/SF: 46.00
C & D: Heating: 0 Base RCNLD: 61625
C & D Factor: Attic: 81 Additions RCNLD: 41411
Functional: Other Features: 0 Total RCNLD: 61625
Reason: Dwelling Subtotal: 109810 RCNLD/SF: 28.06
Economic: Base RCN: 101025 Pct Complete: 100
Reason: Local Multiplier: 1 Dwelling Factor: 1.266
Dwelling Value: 78020
Roll Pct: 100 Condo Base Value:
Roll Value: 78020 Condo Adj Value:

OUTBUILDINGS & YARD ITEMS

| LINE | CONDO | CODE | AREA | CONDITION | YEAR BUILT | OBY VALUE |
|------|-------|----------------|------|-----------|------------|-----------|
| 1 | | GR1 - Gardet-R | 880 | 3-Av | 1973 | 7,700 |
| 2 | | SD1 - Shed - R | 64 | 8-Nv | 1975 | |

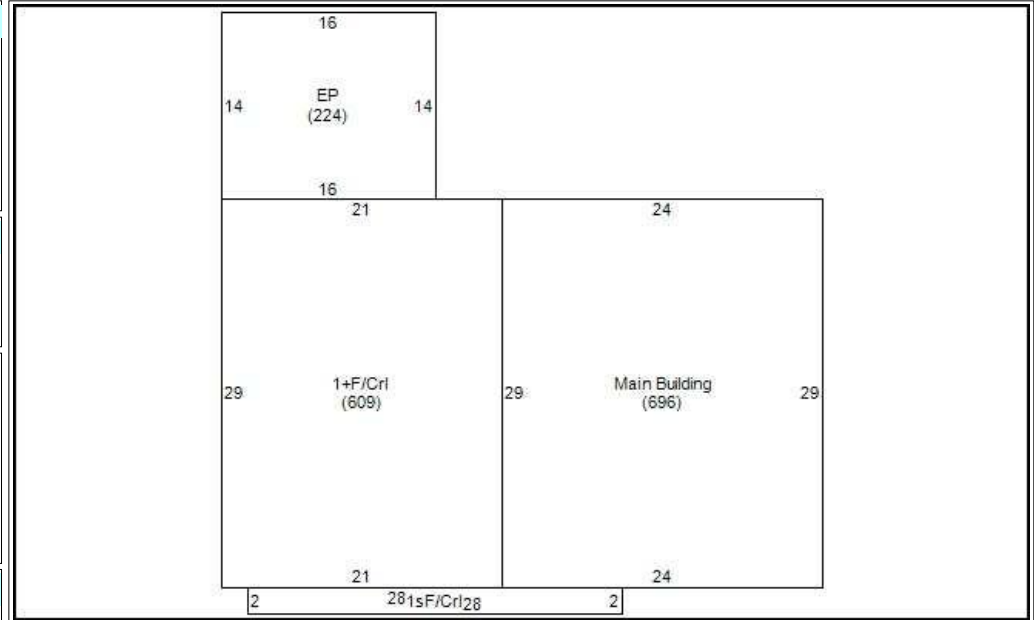

DWELLING ADDITIONS

| LINE | LOWER | FIRST | SECOND | THIRD | AREA | YR BUILT |
|------|--------|--------|--------|-------|------|----------|
| 0 | | | | | 696 | |
| 1 | 51-Crl | 12-1+F | | | 609 | |
| 2 | | 32-EP | | | 224 | |
| 3 | 51-Crl | 11-1sF | | | 56 | |

MEMORANDUM

2001 EP,ADJ TLA LMC 05/01*2000 RPL A/C 2-00 CLS*

Parcel ID: 82-38027

ANITA LOPEZ - LUCAS COUNTY AUDITOR

RESIDENTIAL/AGRICULTURAL

Owner: FLORIANA DONNA J (TRUSTEE)
5318 SILVERTOWN DR

Card 1 of 1
Assr #: 45088007

Market Area: 1906R
DTE #: 00290 - SYLVANIA CITY - SYLVANIA CSI

Tax Year: 2018
LUC: 500 - VAC RES-PLAT

GENERAL INFORMATION

Topo: Spec Use: 500-Vac-Plat
Street: 1 - Paved Traffic: 6-Resside
Utilities: 22 - City Water / City Sewer Corner Lot: No
Legal: COOPER PLACE LOT 40 EXC E 12 FT

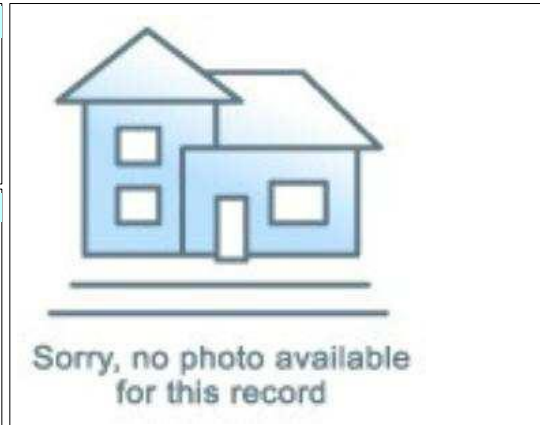

ADMINISTRATIVE

| DATE | SOURCE | ENTRY | ADMIN | DATA ENTRY | REVIEWER |
|----------|-----------|-----------|------------------------|------------|----------|
| 05/22/06 | 4-Vacland | 6-Vacland | 237-Final Value Review | 925 | 193 |

LAND INFORMATION

| TYPE | CODE | FRONT | DEPTH | SQFT | AC | INFL1 | INFL2 |
|------|---------------------|-------|-------|-------|-------|--------|-------------|
| 1 | 01-Residential Land | 50 | 165 | 8,300 | .1905 | 1-None | 10-Restrict |

Total SF: 8,300 Total AC: .1905

PERMITS

| DATE | TAXYR | PERMIT # | PURPOSE | STATUS | % COMP |
|------|-------|----------|---------|--------|--------|
|------|-------|----------|---------|--------|--------|

SALES/TRANSFER HISTORY

| DATE | CONV # | # OF PARCELS | DEED | VALIDITY | TYPE | PRICE |
|----------|----------|--------------|------|------------|----------|-------|
| 04/29/11 | 11202257 | 3 | AF | 8 - Unrevd | 1 - Land | |
| 09/15/06 | 06206255 | 2 | QC | 8 - Unrevd | 1 - Land | |

CONDO COMPLEX

| COMPLEX # | COMPLEX NAME | YR DECLARED | # BLDGS | # UNITS |
|-----------|--------------|-------------|---------|---------|
|-----------|--------------|-------------|---------|---------|

VALUE HISTORY

| 2018 | | 2017 | | 2016 | | 2015 | | 2014 | | 2013 | | 2012 | |
|--------|--------|--------|--------|--------|--------|--------|--------|--------|--------|--------|--------|--------|--------|
| CLASS | R | CLASS | R | CLASS | R | CLASS | R | CLASS | R | CLASS | R | CLASS | R |
| 100% L | 15,700 | 100% L | 11,900 | 100% L | 11,900 | 100% L | 11,900 | 100% L | 11,400 | 100% L | 11,400 | 100% L | 11,400 |
| B | | B | | B | | B | | B | | B | | B | |
| T | 15,700 | T | 11,900 | T | 11,900 | T | 11,900 | T | 11,400 | T | 11,400 | T | 11,400 |
| 35% L | 5,500 | 35% L | 4,170 | 35% L | 4,170 | 35% L | 4,170 | 35% L | 3,990 | 35% L | 3,990 | 35% L | 3,990 |
| B | | B | | B | | B | | B | | B | | B | |
| T | 5,500 | T | 4,170 | T | 4,170 | T | 4,170 | T | 3,990 | T | 3,990 | T | 3,990 |

Parcel ID: 82-38027

ANITA LOPEZ - LUCAS COUNTY AUDITOR

RESIDENTIAL/AGRICULTURAL

Owner: FLORIANA DONNA J (TRUSTEE)
5318 SILVERTOWN DR

Card 1 of 1
Assr #: 45088007

Market Area: 1906R
DTE #: 00290 - SYLVANIA CITY - SYLVANIA CSI

Tax Year: 2018
LUC: 500 - VAC RES-PLAT

DWELLING INFORMATION

| | | |
|----------------------|---------------|---------|
| Occupancy: | Style: | |
| Main SH: | Max SH: | |
| Attic: | Grade: | |
| Basement: | Condition: | |
| Construction: | TLA: | |
| Fin Basement: | Year Built: | Eff Yr: |
| Pct Complete: | Remodel Year: | Type: |

CONDO INFORMATION

| | |
|------------|-------------|
| Complex #: | Condo Type: |
| Unit #: | Level: |
| | View: |

INTERIOR CHARACTERISTICS

| | |
|------------------|----------------------|
| Bedrooms: | Full Baths: |
| Total Rooms: | Half Baths: |
| HVAC: | Additional Fixtures: |
| WB Fire Places: | |
| Gas Fire Places: | |
| Stacks: | |

DWELLING CALCULATIONS

| | | |
|------------------|--------------------|-------------------|
| Effective Year: | Adjusted Base: | Dwelling RCN: |
| % Good: | Plumbing: | Total RCN: |
| % Good Override: | Basement: | RCN/SF: |
| C & D: | Heating: | Base RCNLD: |
| C & D Factor: | Attic: | Additions RCNLD: |
| Functional: | Other Features: | Total RCNLD: |
| Reason: | Dwelling Subtotal: | RCNLD/SF: |
| Economic: | Base RCN: | Pct Complete: |
| Reason: | Local Multiplier: | Dwelling Factor: |
| | | Dwelling Value: |
| Roll Pct: | | Condo Base Value: |
| Roll Value: | | Condo Adj Value: |

OUTBUILDINGS & YARD ITEMS

| <u>LINE</u> | <u>CONDO</u> | <u>CODE</u> | <u>AREA</u> | <u>CONDITION</u> | <u>YEAR BUILT</u> | <u>OBY VALUE</u> |
|-------------|--------------|-------------|-------------|------------------|-------------------|------------------|
|-------------|--------------|-------------|-------------|------------------|-------------------|------------------|

DWELLING ADDITIONS

| <u>LINE</u> | <u>LOWER</u> | <u>FIRST</u> | <u>SECOND</u> | <u>THIRD</u> | <u>AREA</u> | <u>YR BUILT</u> |
|-------------|--------------|--------------|---------------|--------------|-------------|-----------------|
|-------------|--------------|--------------|---------------|--------------|-------------|-----------------|

MEMORANDUM

AREIS Online Report

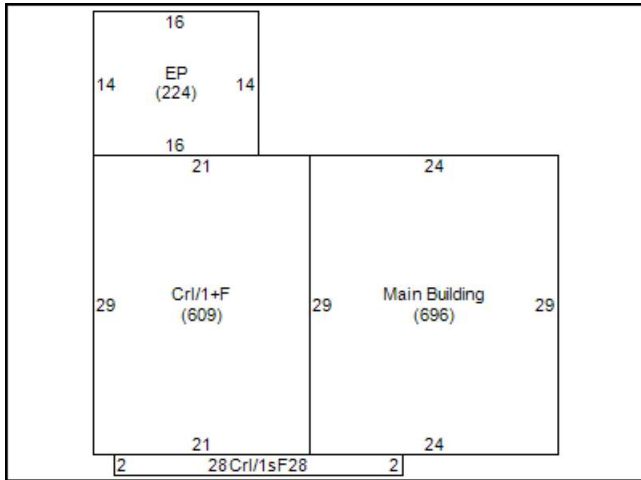

| | | | |
|-------------------|---------------------------------------|------------------|------------------------------|
| Parcel: | 8238024 | Taxing District: | SYLVANIA CITY - SYLVANIA CSD |
| Assessor: | 45088008 | Frontage: | 63 |
| Owner: | FLORIANA DONNA J (TRUSTEE) | Depth: | 168 |
| Property Address: | 5320 SILVERTOWN DR SYLVANIA, OH 43560 | Acres: | 0.2433 |
| | | TLA: | 2196 |
| | | Year Blt: | 1960 |
| | | Wall Type: | PART BRICK |
| | | Class/Landuse: | R / 510 |
| | | Values(100%): | |
| | | Land - | 25,700 |
| | | Bldg - | 85,700 |
| | | Total - | 111,400 |



X



© 2011 Pictometry

04/30/2011

aerial 2



© 2016 Pictometry