

Huron County, Ohio - Property Record Card, Page 1  
Parcel: 010070100240000

GENERAL PARCEL INFORMATION

Owner	CAPIZZI JOSEPH A, CAPIZZI SAMUEL A, PFEIFFENBERGER DENISE M
Property Address	109 ROGER BELLEVUE OH 44811 0
Mailing Address	CAPIZZI JOSEPH A ETAL C/O SAMUEL CAPIZZI 112 BARTHOLOMEW BLVD POWELL OH 43065
Owner Address	510 SINGLE FAMILY DWELLING
Land Use	
Legal Description	

VALUATION

	Appraised	Assessed
Land Value	\$4,760.00	\$1,670.00
Improvements Value	\$66,710.00	\$23,350.00
Total Value	\$71,470.00	\$25,020.00
Taxable Value	\$25,020.00	

SALES

Sale Date	Sale Amount	Buyer	Conveyance	Notes
6/20/2016	\$0.00	JOSEPH A &	445	
1/31/1992	\$0.00	JOSEPH A	69	

LAND

Code	Frontage	Depth	Street Price	Depth Percent	Rate	Total	Value	Acres
F - FRONT	20	147/0	240	9900%	240	\$4,760.00	\$4,760.00	0.0675

MAP



AGRICULTURAL

Code	Soil	Acres	Rate	Appraised	Assessed	CAUV	CAUV	Taxable
------	------	-------	------	-----------	----------	------	------	---------

Huron County, Ohio - Property Record Card, Page 2

Parcel: 010070100240000

Card: 1

GENERAL PARCEL INFORMATION	
Owner	CAPIZZI JOSEPH A, CAPIZZI SAMUEL A, PFEIFFENBERGER DENISE M
Property Address	109 ROGER BELLEVUE OH 44811 0
Mailing Address	CAPIZZI JOSEPH A ETAL C/O SAMUEL CAPIZZI 112 BARTHOLOMEW BLVD POWELL OH 43065
Owner Address	510 SINGLE FAMILY DWELLING
Land Use	
Legal Description	

VALUATION		
	Appraised	Assessed
Land Value	\$4,760.00	\$1,670.00
Improvements Value	\$66,710.00	\$23,350.00
Total Value	\$71,470.00	\$25,020.00
Taxable Value	\$25,020.00	

RESIDENTIAL	
Number Of Stories	1
Year Built	1953
Year Remodelled	1966
Grade	C-
Condition	A
Occupancy	SINGLE FAMILY
Construction	BRICK
RoofType	GABLE
RoofMaterial	SHINGLES
Total Area	1172
Living Area	1172
Finished Basement Area	488
Air Conditioned Area	1172
Unheated Area	0
Total Rooms	8
Total Bedrooms	3
Total Full Baths (Including Base Plumbing)	1
Total Half Baths	0
Extra Plumbing Fixtures	0
Value	\$63,900.00

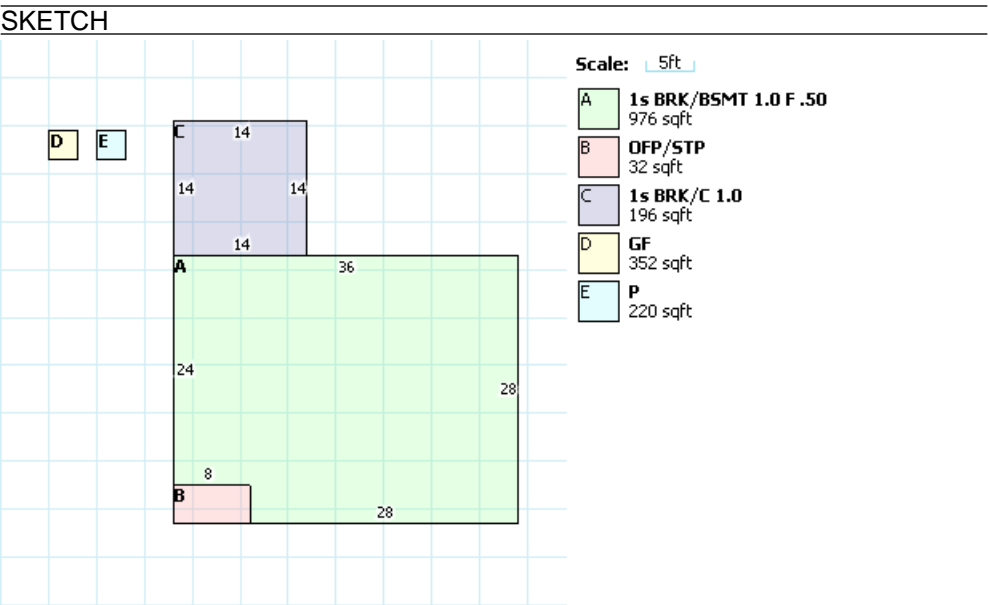

RESIDENTIAL DETAIL							
Floor	Area	Construction	Rooms	Bedrooms	Full Baths	Half Baths	Fireplaces
BSMT	976		3	0	0	0	0
1	1172	BRK	5	3	1	0	1