

# Ottawa County, Ohio - Property Record Card

## Parcel: 0211711023073000 Card: 1

**Owner** WEARS MELISSA  
**Address** 501 JACKSON  
**Land Use** (510) R - SINGLE FAMILY DWELLING, PLATTED LOT  
**Class** RESIDENTIAL  
**Legal Description** BLK 33 LOT 13 W 80 FT ORIGINAL  
**Tax Mailing Name** WEARS MELISSA  
**Tax Mailing Address** 501 JACKSON ST, PORT CLINTON OH 43452-1833

### MAP



### SKETCH

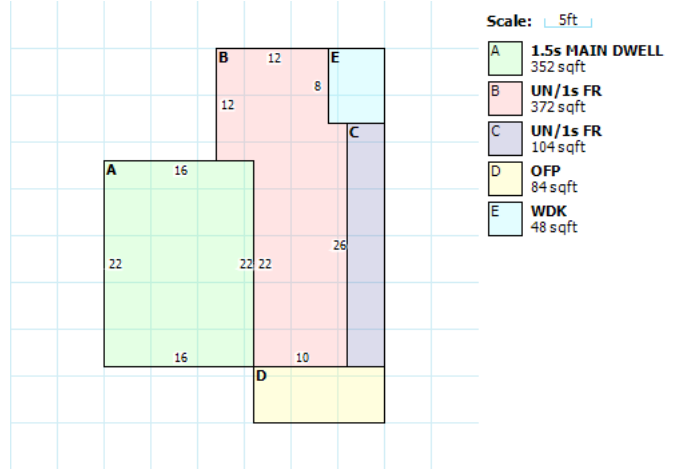

### RESIDENTIAL

Building Style		FullBaths	1
Sq.Ft.	1092	Half Baths	0
Year Built	1900	Basement	FULL
Stories	1.5	Basement Area	0
Exterial Wall	ALUMINUM/VINYL	Rec Room Area	0
Rooms	5	Heat Fuel Type	GAS
Bedrooms	2	Heat/Cool	CENTRAL AIR CONDITION
Family Rooms	0	Attic	NONE
Fireplace Openings(Stacks)	0(0)	Trim	0

### LAND

Code	Frontage	Depth	Acreage	SqFt	Value
1	50	80	N/A	N/A	\$11,880.0

### VALUATION

	Appraised	Assessed
Land Value	\$11,880.00	\$4,160.00
Building Value	\$52,160.00	\$18,260.00
Total Value	\$64,040.00	\$22,420.00
CAUV Value	\$0.00	
Taxable Value	\$22,420.00	

### PERMITS

Number	Date	Purpose	Amount
96R10132	01-MAY-96	DECK PORC	
95R9364	29-AUG-95	ADDN	

### IMPROVEMENTS

Card	Description	Year Built	Dimensions	Value
1	RS1 - FRAME	1981	14x10	\$600.00

### SALES

Date	Buyer	Seller	Price	Validity
9/12/2013	WEARS MELISSA	WEARS DWANE & ANGELA	\$48,800.00	4 RELATED
9/12/2013	WEARS DWANE & ANGELA	WEARS DWANE & ANGELA	\$0.00	
7/14/1999	WEARS DWANE & ANGELA	BALLIN JOYCE	\$40,000.00	4 RELATED
5/26/1995	BOLLIN JOYCE	BRISTLEY SCOTT C	\$34,000.00	0 VALID SALE