

Jackson County, Ohio - Property Record Card

Parcel: M240180002100 Card: 1

Owner KINNISON MICHAEL & NEALY
Address 437 S MINNESOTA AVE
Land Use (510) R - SINGLE FAMILY DWELLING, PLATTED LOT
Class RESIDENTIAL
Legal Description LAURA WELLS 690 000

MAP



SKETCH

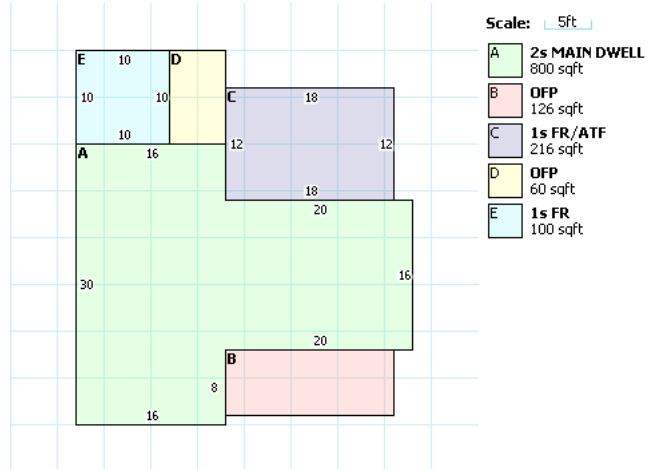

RESIDENTIAL

Building Style	OLD STYLE TWO STORY	FullBaths	1
Sq.Ft.	2002	Half Baths	0
Year Built	1870	Basement	PART
Stories	2	Basement Area	0
Exterial Wall	ALUMINUM/VINYL	Rec Room Area	0
Rooms	7	Heat Fuel Type	GAS
Bedrooms	4	Heat/Cool	CENTRAL
Family Rooms	0	Attic	NONE
Fireplace Openings(Stacks)	1(1)	Trim	0

LAND

Code	Frontage	Depth	Acreage	SqFt	Value
1	30	127	N/A	N/A	\$4,330.00

VALUATION

	Appraised	Assessed
Land Value	\$4,330.00	\$1,520.00
Building Value	\$54,430.00	\$19,050.00
Total Value	\$58,760.00	\$20,570.00
CAUV Value		\$0.00
Taxable Value		\$20,570.00

PERMITS

IMPROVEMENTS

SALES

Date	Buyer	Seller	Price	Validity
7/23/2008	KINNISON MICHAEL &	HOMESALES INC OF DELAWARE	\$30,000.00	5
7/23/2008	HOMESALES INC OF DELAWARE	BATES CHARLOTTE L	\$43,334.00	5

Data For Parcel M240180002100

Tax Data

Parcel:
 Owner:
 Address:



[+] Map this property.

Change Tax Year:

Property Tax

	Tax Year 2017 Payable 2018	
	First Half	Second Half
Gross Charge:	\$473.64	\$473.64
Reduction Factor:	(\$28.99)	(\$28.99)
10% Rollback:	(\$41.76)	(\$41.76)
2.5% Homesite Rollback:	(\$10.43)	(\$10.43)
Homestead Reduction:	\$0.00	\$0.00
Special Assessments:	\$0.00	\$0.00
CAUV Recoupment:	\$0.00	\$0.00
Penalties And Adjustments:	\$0.00	\$0.00
Subtotals:	\$392.46	\$392.46
Prior Charges:		\$3,668.71
Full Year Total:		\$4,453.63
Payments:		\$0.00
Half Year Due:		\$4,061.17
Full Year Due:		\$4,453.63

Special Assessments

No data found for this parcel.

Payments

Date	Amount
7/26/2016	(\$300.00)
4/15/2016	(\$25.00)
2/26/2016	(\$18.75)
11/16/2015	(\$45.00)
9/11/2014	(\$385.95)

GIS parcel shapefile last updated 3/16/2018 5:19:02 AM.

The CAMA data presented on this website is current as of 3/13/2018 10:04:36 PM.

Data For Parcel M240180002200

Base Data

Parcel: M240180002200

Owner: KINNISON MICHAEL & NEALY

Address: 0 S MINNESOTA AVE



[+] Map this property.

Mailing Address

Mailing Name: KINNISON MICHAEL

Address: 218 E SECOND ST

City State Zip: WELLSTON OH 45692-1510

Geographic

City: CITY OF WELLSTON

Township:

School District: WELLSTON SD

Legal

Neighborhood:	00024095	Legal Acres:	0.088
Legal Description:	LAURA WELLS	Land Use:	(500) R - RESIDENTIAL, VACANT LAND, LOT
	689 000	Property Class:	RESIDENTIAL
Map Number:	0018-00-022-00	Range Township Section:	00-00-000

Valuation

	Appraised	Assessed (35%)
Land Value:	\$4,330.00	\$1,520.00
Building Value:	\$0.00	\$0.00
Total Value:	\$4,330.00	\$1,520.00
CAUV Value:	\$0.00	
Taxable Value:	\$1,520.00	

Tax Credits

2.5% Homesite Rollback: NO

Homestead Reduction: NO

Notes

Notes:

GIS parcel shapefile last updated 3/16/2018 5:19:02 AM.

The CAMA data presented on this website is current as of 3/13/2018 10:04:36 PM.

Data For Parcel M240180002200

Tax Data

Parcel:

Owner:

Address:



[+] Map this property.

Change Tax Year:

Property Tax

	Tax Year 2017 Payable 2018	
	First Half	Second Half
Gross Charge:	\$35.00	\$35.00
Reduction Factor:	(\$2.13)	(\$2.13)
10% Rollback:	(\$3.09)	(\$3.09)
2.5% Homesite Rollback:	\$0.00	\$0.00
Homestead Reduction:	\$0.00	\$0.00
Special Assessments:	\$0.00	\$0.00
CAUV Recoupment:	\$0.00	\$0.00
Penalties And Adjustments:	\$0.00	\$0.00
Subtotals:	\$29.78	\$29.78
Prior Charges:		\$60.16
Full Year Total:		\$119.72
Payments:		\$0.00
Half Year Due:		\$89.94
Full Year Due:		\$119.72

Special Assessments

No data found for this parcel.

Payments

No data found for this parcel.

GIS parcel shapefile last updated 3/16/2018 5:19:02 AM.

The CAMA data presented on this website is current as of 3/13/2018 10:04:36 PM.