

# Jackson County, Ohio - Property Record Card

## Parcel: M240200006600 Card: 1

**Owner** OASIS RENTALS LLC  
**Address** 241 S MICHIGAN AVE  
**Land Use** (510) R - SINGLE FAMILY DWELLING, PLATTED LOT  
**Class** RESIDENTIAL  
**Legal Description** LAURA WELLS L146-147

### MAP



### SKETCH

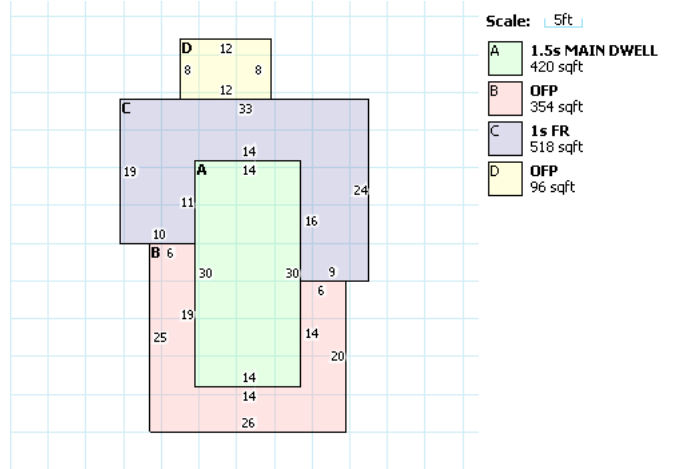

### RESIDENTIAL

Building Style	OTHER	FullBaths	1
Sq.Ft.	1148	Half Baths	0
Year Built	1900	Basement	CRAWL
Stories	1.5	Basement Area	0
Exterior Wall	ALUMINUM/VINYL	Rec Room Area	0
Rooms	7	Heat Fuel Type	GAS
Bedrooms	3	Heat/Cool	CENTRAL AIR CONDITION
Family Rooms	2	Attic	NONE
Fireplace Openings(Stacks)	0(0)	Trim	0

### LAND

Code	Frontage	Depth	Acreage	SqFt	Value
1	45	127	N/A	N/A	\$5,410.00

### VALUATION

	Appraised	Assessed
Land Value	\$5,410.00	\$1,890.00
Building Value	\$35,840.00	\$12,540.00
Total Value	\$41,250.00	\$14,430.00
CAUV Value		\$0.00
Taxable Value		\$14,430.00

### PERMITS

### IMPROVEMENTS

### SALES

Date	Buyer	Seller	Price	Validity
10/8/2008	OASIS RENTALS LLC	HUNTINGTON NATIONAL BANK	\$24,500.00	5
8/20/2008	HUNTINGTON NATIONAL BANK	SECRETARY OF HOUSING &	\$0.00	4 RELATED
6/25/2008	SECRETARY OF HOUSING &	RINEHART CHAD A & ELIZABETH S	\$0.00	5
12/6/2004	RINEHART CHAD A & ELIZABETH S	KELLER CLYDE	\$48,000.00	0 VALID
1/10/2003	KELLER CLYDE	HAMMOND KAREN L	\$41,000.00	0 VALID

# Data For Parcel M240200006600

## Tax Data

Parcel:

Owner:

Address:



[+] Map this property.

Change Tax Year:  ▼

## Property Tax

	Tax Year 2017 Payable 2018	
	First Half	Second Half
<b>Gross Charge:</b>	\$332.27	\$332.27
<b>Reduction Factor:</b>	(\$20.34)	(\$20.34)
<b>10% Rollback:</b>	(\$29.30)	(\$29.30)
<b>2.5% Homesite Rollback:</b>	(\$7.34)	(\$7.34)
<b>Homestead Reduction:</b>	\$0.00	\$0.00
<b>Special Assessments:</b>	\$0.00	\$0.00
<b>CAUV Recoupment:</b>	\$0.00	\$0.00
<b>Penalties And Adjustments:</b>	\$0.00	\$0.00
<b>Subtotals:</b>	\$275.29	\$275.29
<b>Prior Charges:</b>		\$1,735.36
<b>Full Year Total:</b>		\$2,285.94
<b>Payments:</b>		\$0.00
<b>Half Year Due:</b>		\$2,010.65
<b>Full Year Due:</b>		\$2,285.94

## Special Assessments

No data found for this parcel.

## Payments

Date	Amount
2/26/2016	(\$18.75)

GIS parcel shapefile last updated 3/16/2018 5:19:02 AM.

The CAMA data presented on this website is current as of 3/13/2018 10:04:36 PM.