

# Jackson County, Ohio - Property Record Card

Parcel: M240130001200 Card: 1

Owner OASIS RENTALS LLC  
Address 155 HIGH ST  
Land Use (510) R - SINGLE FAMILY DWELLING, PLATTED LOT  
Class RESIDENTIAL  
Legal Description HARRISON 17-18

## MAP



## SKETCH

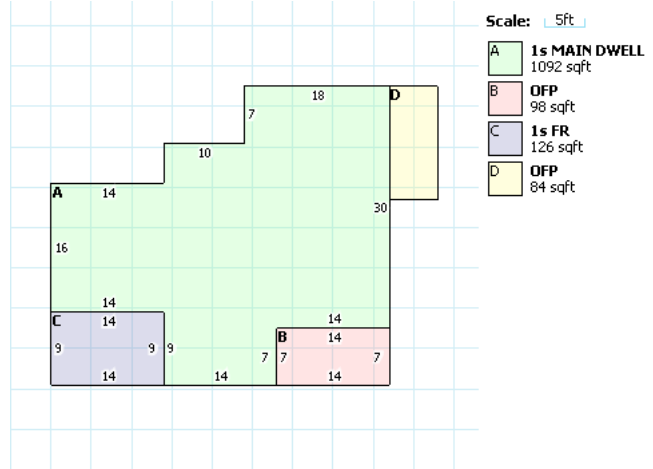

## RESIDENTIAL

Building Style	OTHER	FullBaths	1
Sq.Ft.	1218	Half Baths	0
Year Built	1920	Basement	CRAWL
Stories	1	Basement Area	0
Exterior Wall	ALUMINUM/VINYL	Rec Room Area	0
Rooms	5	Heat Fuel Type	GAS
Bedrooms	2	Heat/Cool	CENTRAL AIR CONDITION
Family Rooms	0	Attic	NONE
Fireplace Openings(Stacks)	0(0)	Trim	0

## LAND

Code	Frontage	Depth	Acreage	SqFt	Value
1	100	145	N/A	N/A	\$15,840.0

## VALUATION

	Appraised	Assessed
Land Value	\$15,840.00	\$5,540.00
Building Value	\$35,420.00	\$12,400.00
Total Value	\$51,260.00	\$17,940.00
CAUV Value	\$0.00	
Taxable Value	\$17,940.00	

## PERMITS

## IMPROVEMENTS

Card	Description	Year Built	Dimensions	Value
1	RS1 - FRAME	2014	10x15	\$1,210.00

## SALES

Date	Buyer	Seller	Price	Validity
1/15/2009	OASIS RENTALS LLC	ALBRECHT RUSSELL W	\$21,000.00	5
10/5/2007	ALBRECHT RUSSELL W	STEWART JOHN R	\$38,000.00	0 VALID
7/30/2001	STEWART JOHN R	MCNEELY GARNET	\$21,000.00	0 VALID

# Data For Parcel M240130001200

## Tax Data

Parcel: M240130001200  
 Owner: OASIS RENTALS LLC  
 Address: 155 HIGH ST



[+] Map this property.

Change Tax Year: 2017 ▼

## Property Tax

Tax Year 2017 Payable 2018		
	First Half	Second Half
Gross Charge:	\$413.07	\$413.07
Reduction Factor:	(\$25.26)	(\$25.26)
10% Rollback:	(\$36.42)	(\$36.42)
2.5% Homesite Rollback:	(\$8.90)	(\$8.90)
Homestead Reduction:	\$0.00	\$0.00
Special Assessments:	\$0.00	\$0.00
CAUV Recoupment:	\$0.00	\$0.00
Penalties And Adjustments:	\$0.00	\$0.00
Subtotals:	\$342.49	\$342.49
Prior Charges:	\$1,364.86	
Full Year Total:	\$2,049.84	
Payments:	\$0.00	
Half Year Due:	\$1,707.35	
Full Year Due:	\$2,049.84	

## Special Assessments

No data found for this parcel.

## Payments

Date	Amount
6/27/2016	(\$150.00)
5/18/2016	(\$150.00)
2/26/2016	(\$18.75)

GIS parcel shapefile last updated 3/16/2018 5:19:02 AM.

The CAMA data presented on this website is current as of 3/13/2018 10:04:36 PM.