

Vinton County, Ohio - Property Record Card, Page 1

Parcel: 0300694000

Map Number:

GENERAL PARCEL INFORMATION

Owner HARRISON ROBERT E
 Property Address 361 WOOLWER AVE HAMDEN OH 45634
 Mailing Address HARRISON ROBERT E
 361 WOOLWEAVER AVE
 HAMDEN OH 45634
 Land Use 510 SINGLE FAMILY DWELLING - PLATTED LOT
 Legal Description LOT 413
 WOOLWEAVER AVE
 School District Vinton County LSD
 Tax District 03 Hamden Corp. - Vinton County LSD

MAP

A map is not available.

VALUATION

	Appraised	Assessed
Land Value	\$6,500.00	\$2,280.00
Improvements Value	\$34,800.00	\$12,180.00
Total Value	\$41,300.00	\$14,460.00
Taxable Value	\$14,460.00	
Net Annual Tax:	\$655.36	
Tot Amt Collected:	\$0.00	

AGRICULTURAL

Code	Soil	Acres	Rate	Appraised	Assessed	CAUV Rate	CAUV Value	Taxable
------	------	-------	------	-----------	----------	-----------	------------	---------

Totals:

LAND

Code	Frontage	Depth	Rate	Total	Value	Acres
L1 - FRONT LOT ENTRY	50	120/0	130	\$6,500.00	\$6,500.00	0

SALES

Sale Date	Sale Amount	Buyer	Conv.	Notes
1/1/1950	\$0.00	HARRISON ROBERT E	0	

COMMENTS

Type	Description
------	-------------

Vinton County, Ohio - Property Record Card, Page 2

Parcel: 0300694000

Map Number:

GENERAL PARCEL INFORMATION

Owner HARRISON ROBERT E
 Property Address 361 WOOLWER AVE HAMDEN OH 45634
 Mailing Address HARRISON ROBERT E
 361 WOOLWEAVER AVE
 HAMDEN OH 45634
 Land Use 510 SINGLE FAMILY DWELLING - PLATTED LOT
 Legal Description LOT 413
 WOOLWEAVER AVE
 School District Vinton County LSD
 Tax District 03 Hamden Corp. - Vinton County LSD

VALUATION

	Appraised	Assessed
Land Value	\$6,500.00	\$2,280.00
Improvements Value	\$34,800.00	\$12,180.00
Total Value	\$41,300.00	\$14,460.00
Taxable Value	\$14,460.00	
Net Annual Tax:	\$655.36	
Tot Amt Collected:	\$0.00	

RESIDENTIAL

Number Of Stories 1
 Year Built 1900
 Year Remodelled
 Grade C-
 Condition A
 Occupancy SINGLE FAMILY
 Construction WOOD
 RoofType SHINGLES
 RoofMaterial
 Total Area
 Living Area 1004
 Finished Basement Area 0
 Air Conditioned Area 0
 Unheated Area 0
 Total Rooms 4
 Total Bedrooms 0
 Total Full Baths (Including Base Plumbing) 1
 Total Half Baths 0
 Extra Plumbing Fixtures 0
 Value \$28,100.00

SKETCH

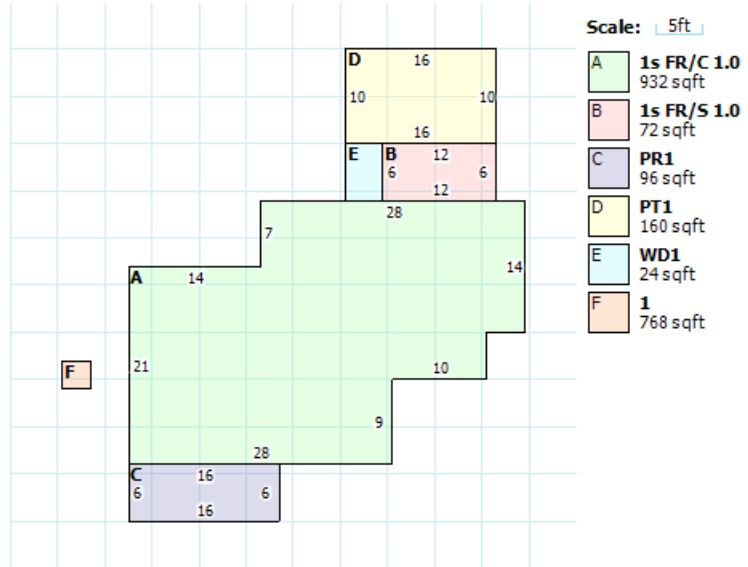

IMPROVEMENTS

Description	Stories	Area	Grade	Year Built	Value
1 GARAGE	.000	768	C	1997	\$6,680

Vinton County, Ohio - Property Record Card, Page 1

Parcel: 0300695000

Map Number:

GENERAL PARCEL INFORMATION

Owner HARRISON ROBERT E
 Property Address 361 WOOLWEAVER AVE HAMDEN OH 45634
 Mailing Address HARRISON ROBERT E
 361 WOOLWEAVER AVE
 HAMDEN OH 45634
 Land Use 500 RESIDENTIAL VACANT LAND - PLATTED LOT
 Legal Description LOT 414
 WOOLWEAVER AVE
 School District Vinton County LSD
 Tax District 03 Hamden Corp. - Vinton County LSD

MAP

A map is not available.

VALUATION

	Appraised	Assessed
Land Value	\$2,000.00	\$700.00
Improvements Value	\$0.00	\$0.00
Total Value	\$2,000.00	\$700.00
Taxable Value	\$700.00	
Net Annual Tax:	\$32.54	
Tot Amt Collected:	\$0.00	

AGRICULTURAL

Code	Soil	Acres	Rate	Appraised	Assessed	CAUV Rate	CAUV Value	Taxable
------	------	-------	------	-----------	----------	-----------	------------	---------

Totals:

LAND

Code	Frontage	Depth	Rate	Total	Value	Acres
ADJ - ADJUSTMENT -	0	0/0	0	\$0.00	\$0.00	0
L1 - FRONT LOT ENTRY	50	120/0	130	\$6,500.00	\$1,950.00	0

SALES

Sale Date	Sale Amount	Buyer	Conv.	Notes
1/1/1950	\$0.00	HARRISON ROBERT E	0	

COMMENTS

Type	Description
------	-------------