

Map Number: 101107104015000

Owner	WISE HARRY E
Property Address	1919 N BLANCHARD ST FINDLAY OH 45840
Mailing Address	WISE HARRY E 18771 TOWNSHIP HWY 23 CAREY OH 43316
Land Use	510 RESIDENTIAL DWELLING PLATTED
Legal Description	GLENWOOD GARDENS SUBDIV LOT 135
School District	FINDLAY CSD
Tax District	21

	Appraised	Assessed
Land Value	\$17,290.00	\$6,050.00
Improvements Value	\$88,940.00	\$31,130.00
Total Value	\$106,230.00	\$37,180.00

Taxable Value	\$37,180.00
Net Annual Tax:	\$1,580.48
Tot Amt Collected:	(\$1,659.50)

600001009716

610000338233

N BLANCHARD ST

128.56

570000218090

1919

570000218080

570000218070

570000218060

65.76

570000217980

570000217970

124

125

98

123.51

570000217700

1 inch = 100 feet

AccuGlobe Map Engine

Code	Soil	Acres	Rate	Appraised	Assessed	CAUV Rate	CAUV Value	Taxable
------	------	-------	------	-----------	----------	-----------	------------	---------

Totals:

Code	Frontage	Depth	Rate	Total	Value	Acres
F - FRONT	65	135/0	280	\$17,290.00	\$17,290.00	0.2014

Sale Date	Sale Amount	Buyer	Conv.	Notes
9/26/2012	\$0.00	WISE HARRY E	835	
4/28/2010	\$72,105.00	WISE HARRY E & WANDA J	471	
1/25/2010	\$0.00	WISE WANDA J ZELLERS	73	
6/12/1986	\$57,500.00	WOOLLEY M ISABELLE	878	
	\$0.00	JOHNSON MICHAEL L &	0	

Type	Description
Back of Card	BRICK TRIM 10LFX2', 11LFX4'H; NV=8X10 SHED, 15 CHG 1360SF 1s BRK TO 1s FR, CHG OBP TO OFF & RMV FIRE PLACE PER MAILER/DESKTOP REVIEW, 3/16/16

Hancock County, Ohio - Property Record Card, Page 2

Parcel: 570000218080

Map Number: 101107104015000

GENERAL PARCEL INFORMATION		
Owner	WISE HARRY E	
Property Address	1919 N BLANCHARD ST FINDLAY OH 45840	
Mailing Address	WISE HARRY E	
	18771 TOWNSHIP HWY 23	
	CAREY OH 43316	
Land Use	510 RESIDENTIAL DWELLING PLATTED	
Legal Description	GLENWOOD GARDENS SUBDIV	
	LOT 135	
School District	FINDLAY CSD	
Tax District	21	

VALUATION		
	Appraised	Assessed
Land Value	\$17,290.00	\$6,050.00
Improvements Value	\$88,940.00	\$31,130.00
Total Value	\$106,230.00	\$37,180.00
Taxable Value	\$37,180.00	
Net Annual Tax:	\$1,580.48	
Tot Amt Collected:	(\$1,659.50)	

RESIDENTIAL		
Number Of Stories	1	
Year Built	1977	
Year Remodelled		
Grade	C	
Condition	A	
Occupancy	SINGLE FAMILY	
Construction	ALUMINUM/VINYL BRICK	
RoofType	GABLE	
RoofMaterial	SHINGLES	
Total Area		
Living Area	1360	
Finished Basement Area	0	
Air Conditioned Area	0	
Unheated Area	0	
Total Rooms	6	
Total Bedrooms	3	
Total Full Baths (Including Base Plumbing)	1	
Total Half Baths	1	
Extra Plumbing Fixtures	0	
Value	\$88,940.00	

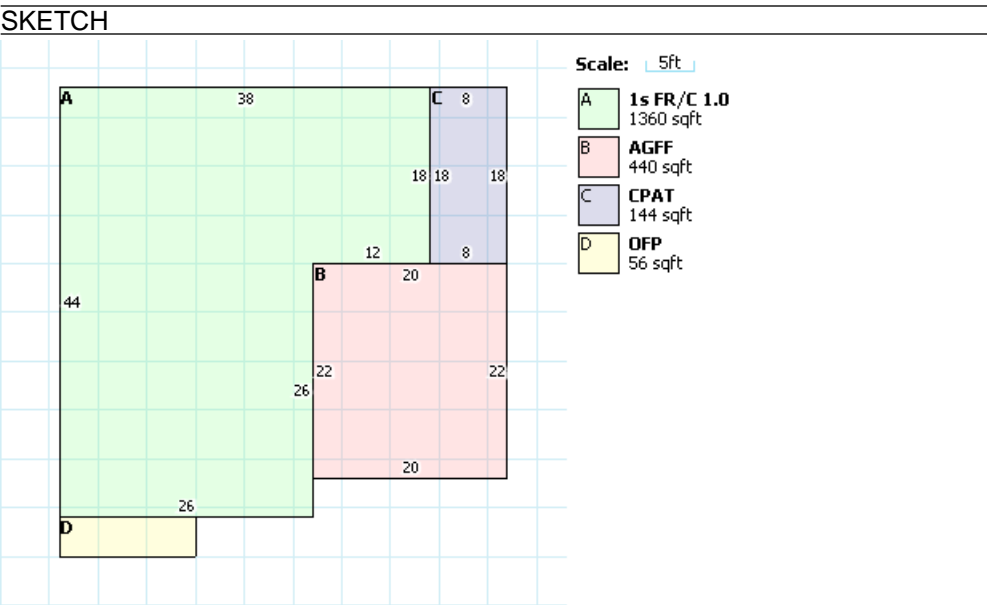

RESIDENTIAL DETAIL							
Floor	Area	Construction	Rooms	Bedrooms	Full Baths	Half Baths	Fireplaces
1	1360	FR	6	3	1	1	0

IMPROVEMENTS						
Description	Stories	Area	Grade	Year Built	Value	