

Lawrence County, Ohio - Property Record Card
 Parcel: 36-104-1700.000
 Card: 1

GENERAL PARCEL INFORMATION

Owner BLEVINS MICHAEL
 Property Address 3018 SO 6TH ST
 Mailing Address 356 SUSAN CT
 IRONTON OH 45638
 Map Number
 Routing Number 36-00100-351000
 Land Use 510 - SINGLE FAMILY RESIDENCE
 Legal Description -00-00 5LOMBARD BLOCK 51
 0000.00A

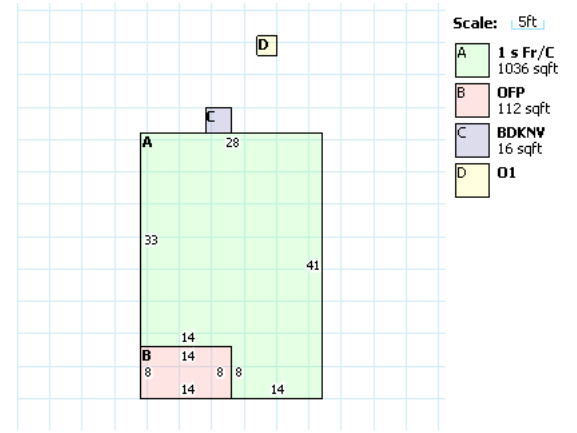

VALUATION

	Appraised	Assessed
Land Value	\$6,460.00	\$2,260.00
Improvements Value	\$38,480.00	\$13,470.00
CAUV Value	\$0.00	\$0.00
Taxable Value		\$15,730.00

RESIDENTIAL

Building Style	SINGLE FAMILY	Full Baths	1
Year Built	1935	Half Baths	0
Stories	1	Basement	FULL CRAWL
Finished Area	1036	Finished Basement Area	0
First Floor Area	1036	Heating	CENTRAL WARM AIR
Half Floor Area	0	Cooling	CENTRAL AC
Upper Floor Area	0	Exterior Wall	FRAME ALUMINUM
Rooms	5	Attic	NONE
Bedrooms	2	Number of Fireplace Openings	0
Family Rooms	0	Number of Fireplace Stacks	0

LAND

Land Type	Acreage	Depth	Frontage	Depth	Value
FR - Front Lot	0.1212	132	40	95	6460

ADDITIONS

Description	Area	Year Built	Value
OFP - Opn Fr Porch	112	0	\$2,000.00
BDKNV - Br Deck NV	16	0	\$0.00

IMPROVEMENTS

Description	Year Built	Dimension	Area	Value
180 Shed - Frame	1994	16x8	128	\$410.00

AGRICULTURAL

Land Type	Land Usage	Soil Type	Acres	Value
-----------	------------	-----------	-------	-------

SALES

Date	Buyer	Seller	Price
2/11/2008	BLEVINS MICHAEL	PRUITT GARY	26500
11/27/2007	PRUITT GARY	JONES CLIFTON &	20000
7/30/2001	JONES CLIFTON &	BROWN, BONNIE BELLE	0
6/2/1993	BROWN, BONNIE BELLE	WELCH, OWEN PAUL &	35000
2/14/1991	WELCH, OWEN PAUL &	CARMON, ROCKY & VICKI	23500

COMMERCIAL

