

# Jackson County, Ohio - Property Record Card

## Parcel: B020010007901 Card: 1

**Owner** ERVIN BRENT & MISSY  
**Address** 0 HARDSCRAPPLE RD  
**Land Use** (512) R - SINGLE FAMILY, 10-19.999 AC  
**Class** RESIDENTIAL  
**Legal Description** SE QT OF NE QT

### MAP



### SKETCH

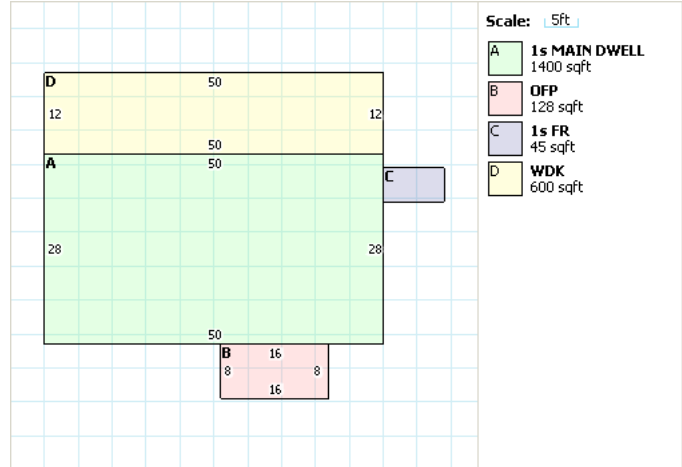

### RESIDENTIAL

Building Style	RANCH	FullBaths	2
Sq.Ft.	1445	Half Baths	0
Year Built	1998	Basement	FULL
Stories	1	Basement Area	0
Exterial Wall	ALUMINUM/VINYL	Rec Room Area	0
Rooms	5	Heat Fuel Type	ELECTRIC
Bedrooms	3	Heat/Cool	HEAT PUMP
Family Rooms	1	Attic	NONE
Fireplace Openings(Stacks)	0(0)	Trim	0

### LAND

Code	Frontage	Depth	Acreage	SqFt	Value
1	0	0	1	N/A	\$11,100.0
8	0	0	9.933	N/A	\$15,890.0

### VALUATION

	Appraised	Assessed
Land Value	\$26,990.00	\$9,450.00
Building Value	\$108,290.00	\$37,900.00
Total Value	\$135,280.00	\$47,350.00
CAUV Value	\$0.00	
Taxable Value	\$47,350.00	

### PERMITS

### IMPROVEMENTS

Card	Description	Year Built	Dimensions	Value
1	RG1 - FRAME	1998	28x40	\$10,840.00

### SALES

# Data For Parcel B020010007901

## Tax Data

Parcel:

Owner:

Address:



[+] Map this property.

Change Tax Year:

## Property Tax

	Tax Year 2017 Payable 2018	
	First Half	Second Half
Gross Charge:	\$0.00	\$0.00
Reduction Factor:	\$0.00	\$0.00
10% Rollback:	\$0.00	\$0.00
2.5% Homesite Rollback:	\$0.00	\$0.00
Homestead Reduction:	\$0.00	\$0.00
Special Assessments:	\$0.00	\$0.00
CAUV Recoupment:	\$0.00	\$0.00
Penalties And Adjustments:	\$0.00	\$0.00
Subtotals:	\$0.00	\$0.00
Prior Charges:		\$2,452.04
Full Year Total:		\$2,452.04
Payments:		\$0.00
Half Year Due:		\$2,452.04
Full Year Due:		\$2,452.04

## Special Assessments

No data found for this parcel.

## Payments

No data found for this parcel.

GIS parcel shapefile last updated 10/10/2017 5:21:44 AM.

CAMA database last updated 10/6/2017 10:03:48 PM.