

**Property Information**

|                                  |   |                       |
|----------------------------------|---|-----------------------|
| Property Number                  | 29-019-0-038.00-0                       | Property Address:     |
| Owner Name                       | CREPS HOWARD J                          | 1245 MEADOW LN        |
| Owner Address                    | 1245 MEADOW LANE<br>YOUNGSTOWN OH 44512 |                       |
| Tax Set                          | 29 BOARDMAN TWP BOARDMAN LSD            |                       |
| School District                  | 5002 BOARDMAN LSD                       |                       |
| Neighborhood                     | 01500 Meadowlane to Sheridan            | Tax Payer Address:    |
| Use Code                         | 510 One Family Dwelling                 | CORELOGIC TAX SERVICE |
| Acres                            | .93900                                  | 3001 HACKBERRY        |
| Description                      |   | IRVING TX 75063       |
| LOT 29 100 X 409 L S LYON PLAT 2 |   | USA                   |

| Assessment Info      |   | Current Value      |            | Recent Transfer |                     |
|----------------------|---|--------------------|------------|-----------------|---------------------|
| Board of Revision    | N | Mkt Land Value     | \$35,020   | Valid Sale      | N                   |
| Homestead/Disability | Y | CAUV               | \$0        | # Parcels       | 1                   |
| Owner Occupied       | Y | Mkt Impr Value     | \$105,680  | Deed Type       | 8E-CERT OF TRANS EX |
| Divided Property     | N | Total              | \$140,700  | Amount          | \$0                 |
| New Construction     | N | <b>Current Tax</b> |            | Sale Date       | 4/24/2000           |
| Foreclosure          | N | Annual Tax *       | \$2,621.80 | Conveyance      | 0                   |
| Other Assessments    | Y | Paid **            | \$1,310.90 | Deed #          | 1877                |
| Front Ft.            | 0 | Delq               | \$0.00     |                 |                     |

<< Previous Card    Card 1 of 1    Next Card >>

**Dwelling Information**

|                   |               |              |      |                |                    |
|-------------------|---------------|--------------|------|----------------|--------------------|
| Sq Ft Finished    | 2026          | Room Count   | 7    | Fireplace(s)   | 1                  |
| 1st Floor Area    | 2026          | Story Height | 1    | Year Built     | 1961               |
| Upper Floor Area  | 0             | # Bedrooms   | 3    | Year Remodeled | 1982               |
| Half Story Area   | 0             | Full Baths   | 1    | Grade          | C+01               |
| Attic Area        | 0             | Half Baths   | 1    | Style          | Convention         |
| Finished Basement | 0             | Heating      | Base | Ext Walls      | Siding w/Masonry 2 |
| Basement Type     | Full Basement | Air Cond     | None |                |                    |

**Land**

| Land Type     | Acres  | Square Ft. | Actual Frontage | Eff. Frontage | Depth     | No Of Units | Value    |
|---------------|--------|------------|-----------------|---------------|-----------|-------------|----------|
| L1Regular Lot | .93890 | 0          | 100.00000       | 100.00000     | 409.00000 | 0           | \$35,020 |

**CAUV Land**

No CAUV Land On This Property

**Card - 1**

**Improvements**

| IMPR Type | Description          | Area      | Length | Width | Year Built |
|-----------|----------------------|-----------|--------|-------|------------|
| Addition  | Garage Brick         | 952 SQ FT |        |       |            |
| Addition  | Porch Frame - Open   | 120 SQ FT |        |       |            |
| Addition  | Porch Masonry - Open | 118 SQ FT |        |       |            |

**Card - 1**

Property Sketch and Photos -- Card 1

### Property Sketch

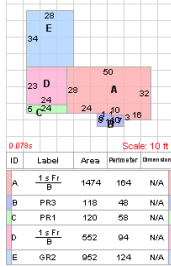

### TaxDetail

|                                |   |           |                   |                   |        |
|--------------------------------|---|-----------|-------------------|-------------------|--------|
| Current Owner(s)               | CREPS HOWARD J  |           |                   |                   |        |
| Billing Address                | CORELOGIC TAX SERVICE<br>3001 HACKBERRY<br><br>IRVING TX 75063<br>USA |           |                   |                   |        |
| Tax District                   | 29 BOARDMAN TWP BOARDMAN LSD  |           |                   |                   |        |
|                                | Full Rate   | 98.650000 | Assessed Value    |                   |        |
|                                | Reduction Factor  | 0.265651  | Land              | \$12,260.00       |        |
|                                | Effective Rate  | 72.443500 | Improvements      | \$36,990.00       |        |
|                                | Certified Delq Year   | 0         | Total             | \$49,250.00       |        |
|                                | Tax Lien Flag   | N         | Tax Due           | Paid to Date      |        |
|                                |   |           | <b>\$2,621.80</b> | <b>\$1,310.90</b> |        |
| <b>Current Tax Year Detail</b> |   |           |                   |                   |        |
| Owner Occupied                 |   | \$42.33   | \$0.00            | \$42.33           | \$0.00 |
| Homestead                      |   | \$279.34  | \$0.00            | \$279.34          | \$0.00 |

### DETAIL OF SPECIAL ASSESSMENT

| 10-911 EMERGENCY 911 |        |        |                 |        |          |        |
|----------------------|--------|--------|-----------------|--------|----------|--------|
| Start Year           | 2004   |        | Expiration Year |        | 9999     |        |
|                      | Prior  |        | 1st Half        |        | 2nd Half |        |
|                      | Chg    | Adj    | Chg             | Adj    | Chg      | Adj    |
| Charge               | \$0.00 | \$0.00 | \$1.48          | \$0.00 | \$1.48   | \$0.00 |
| Pen/Int              | \$0.00 | \$0.00 | \$0.00          | \$0.00 | \$0.00   | \$0.00 |
| Paid                 | \$0.00 |        | \$1.48          |        | \$0.00   |        |
| Owed                 | \$0.00 |        | \$0.00          |        | \$1.48   |        |

| 20-293 MEADOW LN II 29 |        |        |                 |        |          |        |
|------------------------|--------|--------|-----------------|--------|----------|--------|
| Start Year             | 2004   |        | Expiration Year |        | 9999     |        |
|                        | Prior  |        | 1st Half        |        | 2nd Half |        |
|                        | Chg    | Adj    | Chg             | Adj    | Chg      | Adj    |
| Charge                 | \$0.00 | \$0.00 | \$16.49         | \$0.00 | \$16.49  | \$0.00 |
| Pen/Int                | \$0.00 | \$0.00 | \$0.00          | \$0.00 | \$0.00   | \$0.00 |
| Paid                   | \$0.00 |        | \$16.49         |        | \$0.00   |        |
| Owed                   | \$0.00 |        | \$0.00          |        | \$16.49  |        |

### PAYMENT INFORMATION

| Date | Half | Prior | 1st Half | 2nd Half | Receipt# |
|------|------|-------|----------|----------|----------|
|------|------|-------|----------|----------|----------|

|          |      |            |            |            |                         |
|----------|------|------------|------------|------------|-------------------------|
| 03/03/17 | 1-16 | \$0.00     | \$16.49    | \$0.00     | AMC500-03032017-44-1    |
| 03/03/17 | 1-16 | \$0.00     | \$1,292.93 | \$0.00     | AMC500-03032017-44-1    |
| 03/03/17 | 1-16 | \$0.00     | \$1.48     | \$0.00     | AMC500-03032017-44-1    |
| 10/05/16 | 1-16 | \$115.60   | \$0.00     | \$0.00     | AMC500-10052016-176-1   |
| 10/05/16 | 1-16 | \$1,156.01 | \$0.00     | \$0.00     | AMC500-10052016-176-1   |
| 03/04/16 | 1-15 | \$0.00     | \$0.00     | \$111.03   | MJAMAIL-03212016-84-1   |
| 03/04/16 | 1-15 | \$0.00     | \$0.00     | \$1.48     | MJAMAIL-03212016-84-1   |
| 03/04/16 | 1-15 | \$0.00     | \$0.00     | \$16.49    | MJAMAIL-03212016-84-1   |
| 03/04/16 | 1-15 | \$0.00     | \$1.48     | \$0.00     | MJAMAIL-03212016-84-1   |
| 03/04/16 | 1-15 | \$0.00     | \$16.49    | \$0.00     | MJAMAIL-03212016-84-1   |
| 03/04/16 | 1-15 | \$0.00     | \$1,267.04 | \$0.00     | MJAMAIL-03212016-84-1   |
| 08/07/15 | 2-14 | \$0.00     | \$0.00     | \$1,270.72 | MJA100-08142015-39-3    |
| 08/07/15 | 2-14 | \$0.00     | \$0.00     | \$1.48     | MJA100-08142015-39-3    |
| 08/07/15 | 2-14 | \$0.00     | \$0.00     | \$16.49    | MJA100-08142015-39-3    |
| 03/06/15 | 1-14 | \$0.00     | \$1,270.72 | \$0.00     | MJAMAIL-03192015-4-240  |
| 03/06/15 | 1-14 | \$0.00     | \$16.49    | \$0.00     | MJAMAIL-03192015-4-240  |
| 03/06/15 | 1-14 | \$0.00     | \$1.48     | \$0.00     | MJAMAIL-03192015-4-240  |
| 08/08/14 | 2-13 | \$0.00     | \$0.00     | \$16.49    | WAM100-08132014-301-256 |
| 08/08/14 | 2-13 | \$0.00     | \$0.00     | \$1,254.49 | WAM100-08132014-301-256 |
| 08/08/14 | 2-13 | \$0.00     | \$0.00     | \$1.48     | WAM100-08132014-301-256 |
| 03/07/14 | 1-13 | \$0.00     | \$1.48     | \$0.00     | WAM100-03112014-1-249   |
| 03/07/14 | 1-13 | \$0.00     | \$1,254.49 | \$0.00     | WAM100-03112014-1-249   |
| 03/07/14 | 1-13 | \$0.00     | \$16.49    | \$0.00     | WAM100-03112014-1-249   |

#### Transfer History

| Date       | Sale Amount | To                           | Transfer Type | Conveyance | Deed | # Parcels |
|------------|-------------|------------------------------|---------------|------------|------|-----------|
| 04/24/2000 | \$0         | CREPS HOWARD J               | Change Owner  | 0          | 1877 | 1         |
| 11/10/1972 | \$0         | CREPS HOWARD J &<br>DOROTHEA | Change Owner  | 0          |      | 0         |

#### Value History

| Reason                                     | Year | Land     | IMPR      | Total     |
|--|------|----------|-----------|-----------|
| Reappraisal, Update or Annual Equalization | 2011 | \$35,020 | \$105,680 | \$140,700 |
| Reappraisal, Update or Annual Equalization | 2005 | \$35,000 | \$102,900 | \$137,900 |
| Reappraisal, Update or Annual Equalization | 1999 | \$19,400 | \$101,400 | \$120,800 |
| Miscellaneous                              | 1996 | \$17,300 | \$82,300  | \$99,600  |
| Reappraisal, Update or Annual Equalization | 1996 | \$17,300 | \$82,300  | \$99,600  |
| Miscellaneous                              | 1995 | \$15,500 | \$73,500  | \$89,000  |