

Pickaway County, Ohio - Property Record Card

Parcel: M3000090000400 Card: 1

Owner SIX WILLIAM L & BEVERLY M
Address 2850 PINE DR
Land Use (510) R - SINGLE FAMILY DWELLING, PLATTED LOT
Class RESIDENTIAL
Legal Description LT-4 RTS 220226-27 LITTLE WALNUT ACRES SD

MAP



SKETCH

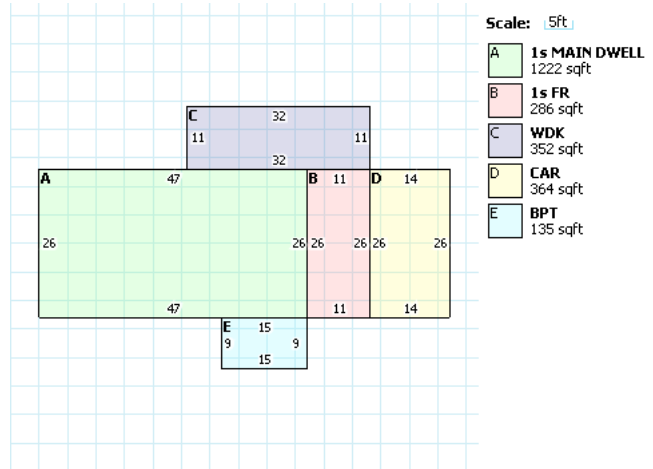

RESIDENTIAL

Building Style	RANCH	FullBaths	1
Sq.Ft.	1508	Half Baths	0
Year Built	1960	Basement	FULL
Stories	1	Basement Area	0
Exterial Wall	ALUMINUM/VINYL	Rec Room Area	0
Rooms	7	Heat Fuel Type	GAS
Bedrooms	3	Heat/Cool	CENTRAL AIR CONDITION
Family Rooms	1	Attic	NONE
Fireplace Openings(Stacks)	1(1)	Trim	0

LAND

Code	Frontage	Depth	Acreage	SqFt	Value
1	115	225	N/A	N/A	\$29,280.0

VALUATION

	Appraised	Assessed
Land Value	\$29,280.00	\$10,250.00
Building Value	\$76,120.00	\$26,640.00
Total Value	\$105,400.00	\$36,890.00
CAUV Value	\$0.00	
Taxable Value	\$36,890.00	

PERMITS

IMPROVEMENTS

Card	Description	Year Built	Dimensions	Value
1	RS1 - FRAME	1959	14x20	\$270.00
1	RS1 - FRAME	1959	9x13	\$110.00

SALES

Date	Buyer	Seller	Price	Validity
2/23/2017	SIX WILLIAM L	SIX WILLIAM L	\$0.00	4 RELATED