

Jackson County, Ohio - Property Record Card

Parcel: M240200001800 Card: 1

Owner OASIS RENTALS LLC
Address 813 S MICHIGAN AVE
Land Use (510) R - SINGLE FAMILY DWELLING, PLATTED LOT
Class RESIDENTIAL
Legal Description LASLEY LOT #4

MAP



SKETCH

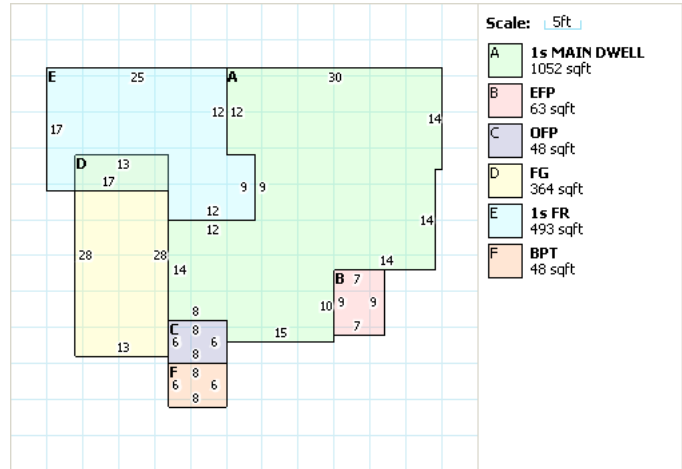

RESIDENTIAL

Building Style	OTHER	FullBaths	1
Sq.Ft.	1545	Half Baths	0
Year Built	1940	Basement	CRAWL
Stories	1	Basement Area	0
Exterior Wall	ALUMINUM/VINYL	Rec Room Area	0
Rooms	6	Heat Fuel Type	GAS
Bedrooms	2	Heat/Cool	CENTRAL AIR CONDITION
Family Rooms	0	Attic	NONE
Fireplace Openings(Stacks)	0(0)	Trimp	0

LAND

Code	Frontage	Depth	Acreage	SqFt	Value
1	61	134	N/A	N/A	\$6,170.00

VALUATION

	Appraised	Assessed
Land Value	\$6,170.00	\$2,160.00
Building Value	\$44,340.00	\$15,520.00
Total Value	\$50,510.00	\$17,680.00
CAUV Value	\$0.00	
Taxable Value	\$17,680.00	

PERMITS

IMPROVEMENTS

SALES

Date	Buyer	Seller	Price	Validity
11/1/2007	OASIS RENTALS LLC	KINNISON MICHAEL A &	\$0.00	1 MULTI PARCEL
4/24/2006	KINNISON MICHAEL A &	OUSLEY BRANCH	\$10,000.00	0 VALID
11/26/200	OUSLEY BRANCH	OUSLEY DEBORAH S	\$34,000.00	1 MULTI PARCEL
4/14/1999	OUSLEY DEBORAH S	DODD TIMYRA	\$30,000.00	1 MULTI PARCEL
2/10/1998	DODD TIMYRA	DODD TIMYRA	\$2,500.00	1 MULTI PARCEL
10/17/199	DODD TIMYRA	RICE THELMA	\$0.00	8 UNVALIDATED