

PARCEL ID 215-06-504
OWNERS NAME VOSNIAK, RONALD J.
ADDRESS 02860 NORTH BAY DR N4
CITY WESTLAKE
ZIP 44145



[Click Here to view a Sketch of the Property](#)

[Field Definitions](#)

Residential Building

BLDG NUMBER	1 of 1	ROOMS	6
OCCUPANCY	1 FAMILY	BEDROOMS	2
STYLE	WU	FULL BATHS	2
QUALITY	C+	HALF BATHS	0
CONDITION	AVG	PLUMB FIXTURES	8
EXTERIOR WALLS	A/V	GARAGE TYPE	DET
BASEMENT TYPE	SLB	GARAGE AGE	1981
ATTIC TYPE	N	GARAGE TYPE	DET
HEAT TYPE	FHA	GARAGE CAPACITY	1
STORY HEIGHT	1	GARAGE AGE	1981
YEAR BUILT	1981	GARAGE SIZE	
EFFECTIVE YEAR BUILT	1986	LIVING AREA BSMT	0
ROOF TYPE		LIVING AREA 1	1137
ROOF MATERIAL		LIVING AREA 2	0
AIR CONDITION	CTL	LIVING AREA UPPER	0
BASEMENT SQFT	0	LIVING AREA TOTAL	1137

FINISHED BASEMENT

Residential Amenities For Building: 1

AMENITY TYPE	OPEN PORCH	AMENITY MEASURE 50
---------------------	------------	---------------------------

Parcel # 21506504
Owner Name VOSNIAK, RONALD J.
Address 2860 NORTH BAY DR, N4, WESTLAKE, 44145

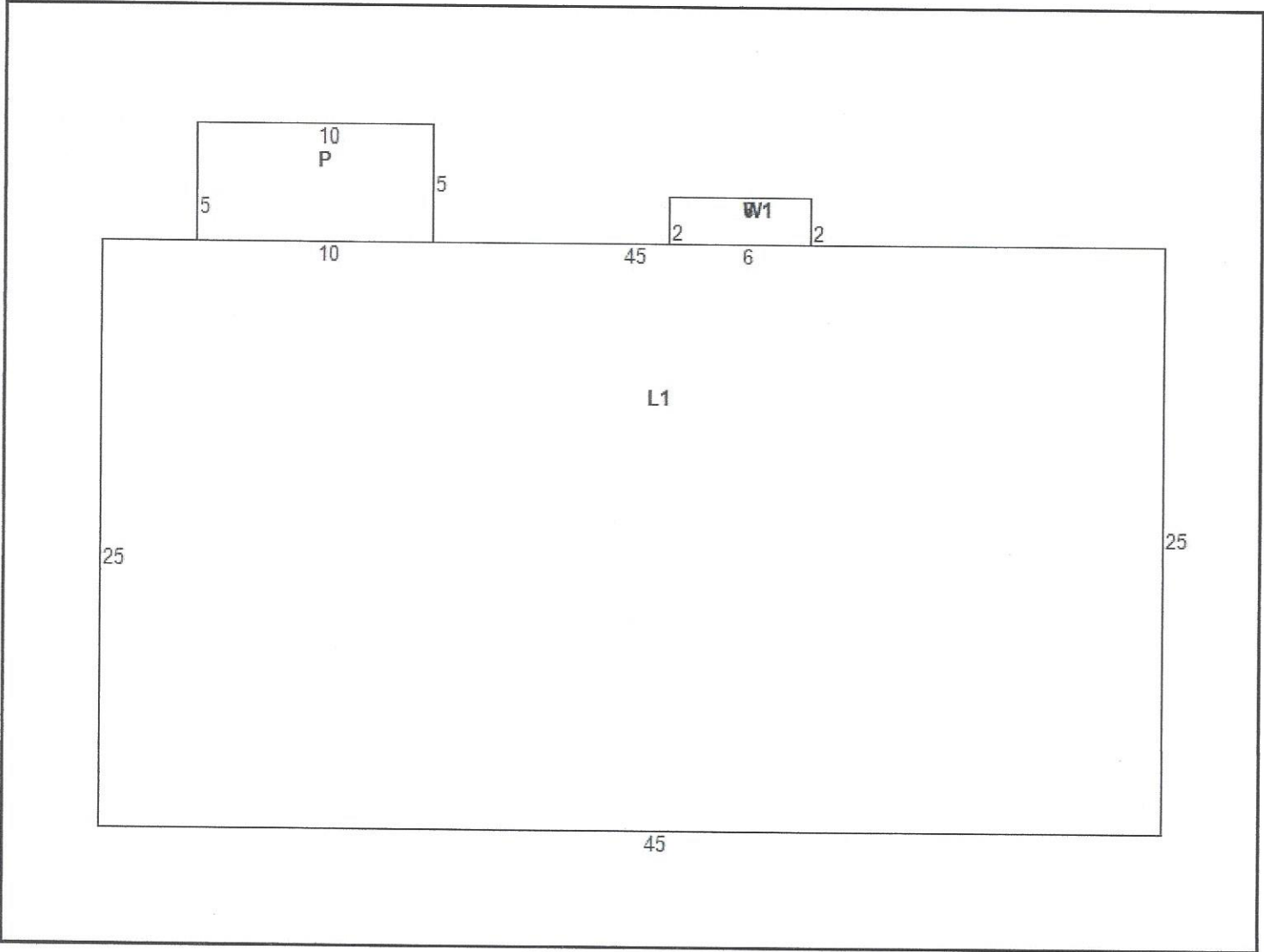

PRIMARY OWNER VOSNIAK, RONALD J.
PROPERTY ADDRESS 2860 N Bay DR, Westlake, OH 44145
TAX MAILING ADDRESS VOSNIAK, RONALD J., 2860 N BAY DR, Unit N-4, WESTLAKE, OH 44145
LEGAL DESCRIPTION 35 GARDENS OF BAY LANDING PH II BLDGS L M N 004N [Field Definitions](#)
PROPERTY CLASS RESIDENTIAL CONDOMINIUM

2016 (pay in 2017) TAXBILL SUMMARY

PARCEL NUMBER 215-06-504 **TAXSET** Westlake **TAX YEAR** 2016 (pay in 2017) ▼

<u>ASSESSED VALUES</u>		<u>MARKET VALUES</u>		<u>FLAGS</u>	
LAND VALUE	2,940.00	LAND VALUE	8,400.00	OWNER OCCUPANCY CREDIT	N
BUILDING VALUE	26,390.00	BUILDING VALUE	75,400.00	HOMESTEAD	N
TOTAL VALUE	29,330.00	TOTAL VALUE	83,800.00	FORECLOSURE	N
HOMESTEAD VALUE	0			CERT. PEND.	N
				CERT. SOLD	Y
				PAYMENT PLAN	N
<u>HALF YEAR CHARGE AMOUNTS</u>		<u>RATES</u>			
GROSS TAX	1,517.09	FULL RATE	103.45		
LESS 920 RED	505.93	920 RED. RATE	.333485		
SUB TOTAL	1,011.16	EFFECTIVE RATE	68.950977	<u>ESCROW</u>	
NON-BUSINESS CREDIT	89.79			ESCROW	N
OWNER OCCUPANCY CREDIT	0.00			PMT. AMOUNT	0.00
HOMESTEAD RED. AMOUNT	0.00			ACCOUNT	
TOTAL ASSESSMENTS	0.00				
HALF YEAR NET TAXES	921.37				

	CHARGES	PAYMENTS	BALANCE DUE
TAX BALANCE SUMMARY:	5,956.69	4,021.81	1,934.88

2016 (pay in 2017) CHARGE AND PAYMENT DETAIL

Tax Information is up to the hour - tell me more.

TAXSET	CHARGE TYPE	CHARGES	PAYMENTS	BALANCE
Westlake	Prior year penalty - 2014	227.35	227.35	0.00
	Prior year penalty - 2015	284.36	284.36	0.00
	Prior year tax - 2015	1,834.56	1,834.56	0.00
	Prior year August interest - 2016	140.96	140.96	0.00
	Prior year interest - 2015	67.76	67.76	0.00

PARCEL ID 215-06-504[Field
Definitions](#)**OWNERS NAME** VOSNIAK, RONALD J.**ADDRESS** 02860 NORTH BAY DR N4**CITY** WESTLAKE**ZIP** 44145**General Information**

OWNER	VOSNIAK, RONALD J.	UNIT NUMBER	N4
CLASS	R	TAX DISTRICT	060
LAND USE	5500	OWNER OCCUPIED	
LAND USE 2		TAX ABATEMENT	
ROAD TYPE	PV	NEIGHBORHOOD	99118
WATER	MUN	TOTAL BUILDINGS	1
GAS	Y		
SEWER	SNS		
ELECTRICITY	Y		

CUYAHOGA COUNTY ASSUMES NO LIABILITY FOR DAMAGES AS A RESULT OF ERRORS, OMISSIONS OR DISCREPANCIES CONTAINED IN THESE PAGES. PROSPECTIVE PURCHASERS SHOULD CONSULT A REAL ESTATE ATTORNEY AND PURCHASE A TITLE INSURANCE POLICY PRIOR TO THE SALE.