

Ross County, Ohio - Property Record Card, Page 1

Parcel: 021207036000

GENERAL PARCEL INFORMATION

Owner MATHEWS, DONALD WILLIAM II & TERESA ANN JTLE
 Property Address 836 SR 138
 Mailing Address 836 ST RT 138 NE
 GREENFIELD OH 45123
 Land Use/Class 511 - SINGLE FAMILY DWELLING ON (ACREAGE 0 TO 9.99)
 Tax District BUCKSKIN - GREENFIELD EVSD
 Legal Description 836 ST RT 138 RES 1.56 12-7-36 0135/2061

VALUATION

	Appraised	Assessed
Land Value	\$9,970.00	\$3,490.00
Improvements Value	\$103,260.00	\$36,140.00
Total Value	\$113,230.00	\$39,630.00
CAUV Value	\$0.00	\$0.00
Taxable Value		\$39,630.00

LAND

Description	Acreage/FrontaEffective	Depth	Depth Factor	Actual Value
HOMESITE	1 0	0	0	8700
LAND	0.56 0	0	0	1270

SALES

Sale Number	Sale Date	Sale Price	Sale Type	Buyer
0000000	4/15/1999	98000		MATHEWS, DONALD

MAP



AGRICULTURAL

Limited to 8 items. For complete list, see the Land tab in the property pages.

Soil Code	Acreage

TAX

Gross Charge	\$1,997.36
Reduction Factor	(\$202.18)
10% Rollback	(\$172.38)
2.5% Homesite Rollback	(\$41.42)
Homestead Reduction	\$0.00
Penalties And Adjustments	\$18.35
Net Annual Tax	\$1,581.38

Ross County, Ohio - Property Record Card, Page 2

Parcel: 021207036000

Card: 0

GENERAL PARCEL INFORMATION

Owner MATHEWS, DONALD WILLIAM II & TERESA ANN JTLE
 Property Address 836 SR 138
 Mailing Address 836 ST RT 138 NE
 GREENFIELD OH 45123
 Land Use/Class 511 - SINGLE FAMILY DWELLING ON (ACREAGE 0 TO 9.99)
 Tax District BUCKSKIN - GREENFIELD EVSD
 Legal Description 836 ST RT 138 RES 1.56 12-7-36 0135/2061

VALUATION

	Appraised	Assessed
Land Value	\$9,970.00	\$3,490.00
Improvements Value	\$103,260.00	\$36,140.00
Total Value	\$113,230.00	\$39,630.00
CAUV Value	\$0.00	\$0.00
Taxable Value	\$39,630.00	

IMPROVEMENTS

Building Type	SHB	Area	Rate	Grade	Year Built	Value
DWELLING	2 FR	1229	0	C	1984	\$100,120.00
GARAGE	MTPL28X40	1120	721	D	1984	\$3,140.00

RESIDENTIAL

Year Built	1984
Number of Stories	2
Total Living Area	2113
Total Rooms:	8
Total Bedrooms	0
Total Baths	1
Total Family Rooms	0

SKETCH

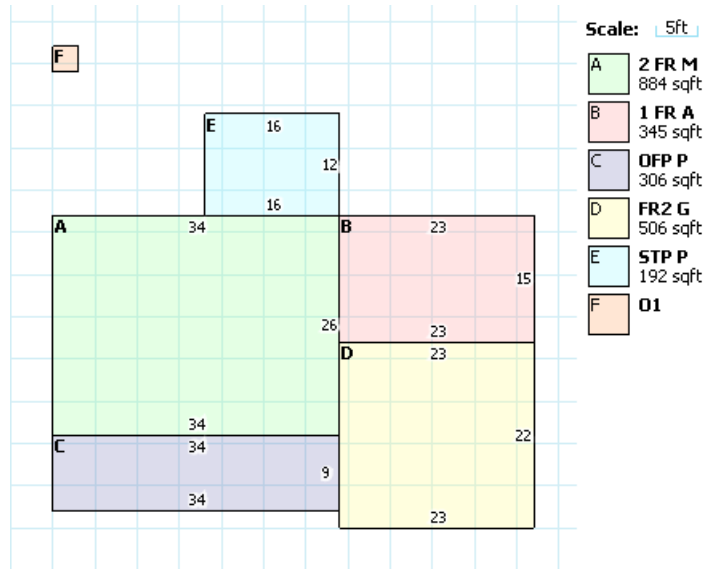

RESIDENTIAL DETAIL

	Basement	First Fl	Partial Upper Fl	Full Upper Fl	Attic
Area (F/Un)	0/0	1229	0	884	0/0
Value	\$0.00	\$125,200.00	\$0.00	\$55,200.00	\$0.00
Plaster/Drywall		D			
Paneling					
Fiberboard					
Unfinished					
Wood Joist	X				
Fire-Resist					
Fire-Proof					
Hardwood					
Pine		X			
Carpet					
Concrete					
Tile/Linoleum					
Rooms	0	4	4	0	0
Bedrooms	0	0	0	0	0
Family Rooms	0	0	0	0	0
Dining Rooms	0	0	0	0	0
Insulation					
Central Air					
Heat Pump					
Central Heat	A				
Plumbing	1	0	0	0	0