

Print -

Property Information		
<b>Property Number</b>	07-00286.000	<b>Property Address:</b> 111 KIRK ST  HOLLOWAY OH  <b>Tax Payer Address:</b> JONES MARY LOUISE 3834 WORCHESTER LN MEDINA OH 44256 USA
<b>Owner Name</b>	JONES MARY LOUISE	
<b>Owner Address</b>	3834 WORCHESTER MEDINA OH 44256	
<b>Tax Set</b>	07 HOLLOWAY CORPORATION	
<b>School District</b>	707 Union LSD 2	
<b>Neighborhood</b>	24000 HOLLOWAY CORP	
<b>Use Code</b>	510 Single family owner occupied	
<b>Acres</b>	.00000	
<b>Description</b>		
INLOT 42 D ADD 40 FT REAR 135 X 21.6		

		Current Value		Recent Transfer	
<b>Board of Revision</b>	N	<b>Mkt Land Value</b>	\$810	<b>Valid Sale</b>	Y
<b>Homestead/Disability</b>	Y	<b>CAUV</b>	\$0	<b># Parcels</b>	1
<b>2.5% Reduction</b>	Y	<b>Mkt Impr Value</b>	\$17,950	<b>Deed Type</b>	0
<b>Divided Property</b>	N	<b>Total</b>	\$18,760	<b>Amount</b>	\$0
<b>New Construction</b>	N	<b>Current Tax</b>		<b>Sale Date</b>	1/1/1987
<b>Foreclosure</b>	N	<b>Annual Tax *</b>	\$50.37	<b>Conveyance/Deed</b>	0
<b>Other Assessments</b>	Y	<b>Paid **</b>	\$0.00	<b>Map #</b>	9
<b>Front Ft.</b>	0	<b>Delq</b>	\$56.42		

<< Previous Card      Card 1 of 1      Next Card >>

Dwelling Information					
<b>Sq Ft Finished</b>	876	<b>Room Count</b>	3	<b>Fireplace(s)</b>	0
<b>1st Floor Area</b>	876	<b>Story Height</b>	1	<b>Year Built</b>	1930
<b>Upper Floor Area</b>	0	<b># Bedrooms</b>	1	<b>Year Remodeled</b>	0
<b>Half Story Area</b>	0	<b>Full Baths</b>	1	<b>Grade</b>	D
<b>Attic Area</b>	0	<b>Half Baths</b>	0	<b>Style</b>	Single Fam
<b>Finished Basement</b>	0	<b>Heating</b>	Forced Air	<b>Ext Walls</b>	Frame - FRAME
<b>Basement Type</b>	Full Basement	<b>Air Cond</b>	Central Air		

Land								
Land Type	Acres	Square Ft.	Actual Frontage	Eff. Frontage	Depth	No Of Units	Adjusted Rate	Value
FRFront Lot [DEPTHC]	0.06	0	20.00	20.00	135.00	0	\$37	\$740

CAUV Land Lines

No CAUV Land On This Parcel

Card - 1

Improvements				
IMPR Type	Description	Area	Year Built	Value
Addition	DECK DECK	708 SQ FT		\$10,100
Addition	STPS STPS	15 SQ FT		\$1,200
Other Improvement	SHED Shed	100	2008	\$2,030

Card - 1

Property Sketch -- Card 1

Property Sketch

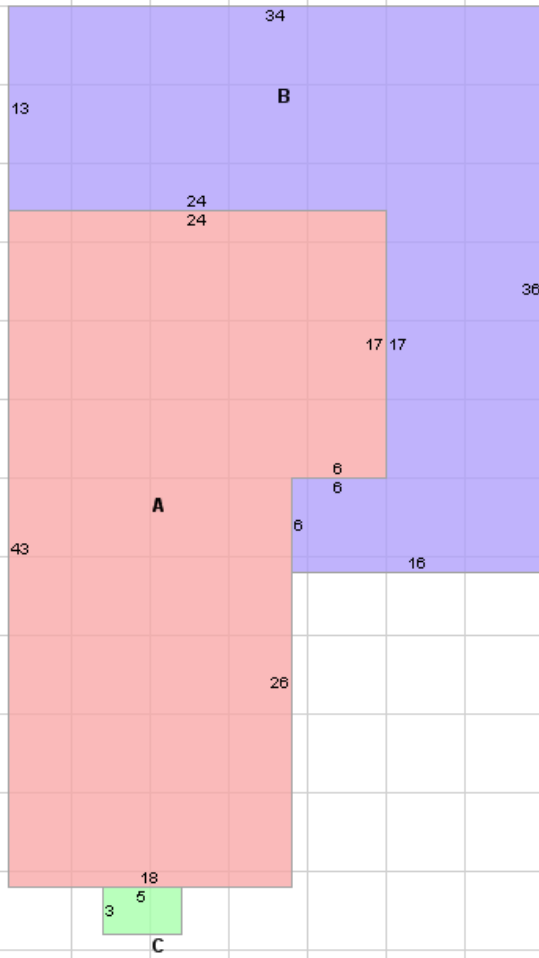

0.062s

Scale: 5 ft

ID	Label	Area	Peri meter	Dimension
A	$\frac{1 \text{ s Fr}}{B}$	876	134	N/A
B	DECK	708	152	N/A
C	STPS	15	16	N/A
6		0	0	

Print Version

## TaxDetail Belmont County Auditor Tax Detail Screen

<b>Current Owner(s)</b>	JONES MARY LOUISE					
<b>Billing Address</b>	JONES MARY LOUISE 3834 WORCHESTER LN  MEDINA OH 44256 USA					
<b>Tax District</b>	07 HOLLOWAY CORPORATION					
	<b>Full Rate</b>	73.950000	<b>Assessed Value</b>			
	<b>Reduction Factor</b>	0.246209	<b>Land</b>	\$280.00		
	<b>Effective Rate</b>	55.742858	<b>Improvements</b>	\$6,280.00		
	<b>Certified Delq Year</b>	0	<b>Total</b>	\$6,560.00		
	<b>Tax Lien Flag</b>	N	<b>Annual Tax Due</b>	<b>Paid to Date</b>		
			<b>\$50.37</b>	<b>\$0.00</b>		
<b>Current Tax Year Detail</b>						
	<b>Prior</b>		<b>1st Half</b>		<b>2nd Half</b>	
	<b>Chg</b>	<b>Adj</b>	<b>Chg</b>	<b>Adj</b>	<b>Chg</b>	<b>Adj</b>
<b>Orig Tax</b>	\$35.56	\$0.00	\$242.56	\$0.00	\$242.56	\$0.00
<b>Reduction</b>			\$59.72	\$0.00	\$59.72	\$0.00
<b>Subtotal</b>	\$35.56		\$182.84		\$182.84	
<b>Rollback</b>			\$16.72	\$0.00	\$16.72	\$0.00
<b>2.5% RB</b>			\$3.70	\$0.00	\$3.70	\$0.00
<b>Homestead</b>			\$143.42	\$0.00	\$143.42	\$0.00
<b>Net Tax Due</b>	\$35.56		\$19.00		\$19.00	
<b>Penalty/Int</b>	\$5.83	\$0.00	\$0.00	\$1.90	\$0.00	\$0.00
<b>Tax Due</b>	\$41.39		\$20.90		\$19.00	
<b>Tax Paid</b>	\$0.00		\$0.00		\$0.00	
<b>Assess. Due</b>	\$15.03		\$10.47		\$0.00	
<b>Assess. Paid</b>	\$0.00		\$0.00		\$0.00	
<b>Total Owed</b>	\$56.42		\$31.37		\$19.00	
<b>Total Paid</b>	\$0.00		\$0.00		\$0.00	
<b>Balance Due</b>	\$56.42		\$87.79		\$106.79	

## SpecialAssessments

DETAIL OF SPECIAL ASSESSMENT						
C970002015 JEFFERSON BELMONT SOLID WASTE						
Start Year	2015		End Year		2015	
	Prior		1st Half		2nd Half	
	Chg	Adj	Chg	Adj	Chg	Adj
<b>Charge</b>	\$0.00	\$0.00	\$9.52	\$0.00	\$0.00	\$0.00
<b>Pen/Int</b>	\$0.00	\$0.00	\$0.00	\$0.95	\$0.00	\$0.00
<b>Paid</b>	\$0.00		\$0.00		\$0.00	
<b>Owed</b>	\$0.00		\$10.47		\$0.00	
C970002014 JEFFERSON BELMONT SOLID WASTE						
Start Year	2014		End Year		2014	
	Prior		1st Half		2nd Half	
	Chg	Adj	Chg	Adj	Chg	Adj
<b>Charge</b>	\$12.92	\$0.00	\$0.00	\$0.00	\$0.00	\$0.00
<b>Pen/Int</b>	\$2.11	\$0.00	\$0.00	\$0.00	\$0.00	\$0.00
<b>Paid</b>	\$0.00		\$0.00		\$0.00	
<b>Owed</b>	\$15.03		\$0.00		\$0.00	

## Payments

PAYMENT INFORMATION					
Date	Half	Prior	1st Half	2nd Half	Receipt#
02/19/14	1-13	\$0.00	\$17.99	\$0.00	tms05-02192014-67-1
02/19/14	1-13	\$0.00	\$0.00	\$17.99	tms05-02192014-67-1
01/29/13	1-12	\$0.00	\$17.62	\$0.00	kjc01-01292013-19-1
01/29/13	1-12	\$0.00	\$0.00	\$17.62	kjc01-01292013-19-1

Transfer History					
Date	Sale Amount	To	Transfer Type	Conveyance	#Parcels
01/01/1987	\$0	JONES MARY LOUISE	Change Owner	0	1

Value History					
Reason	Date	Land	IMPR	Total	
Reappraisal, Update or Annual Equalization	8/28/2012	\$740	\$16,780	\$17,520	
Reappraisal, Update or Annual Equalization	1/1/2006	\$740	\$13,860	\$14,600	
Reappraisal, Update or Annual Equalization	1/1/2006	\$210	\$19,880	\$20,090	
Reappraisal, Update or Annual Equalization	1/1/2000	\$210	\$15,790	\$16,000	
Reappraisal, Update or Annual Equalization	1/1/1997	\$190	\$11,780	\$11,970	
New Construction - Full Value	1/1/1997	\$180	\$11,220	\$11,400	
Reappraisal, Update or Annual Equalization	1/1/1994	\$180	\$10,360	\$10,540	
Reappraisal, Update or Annual Equalization	1/1/1993	\$140	\$10,200	\$10,340	
Reappraisal, Update or Annual Equalization	1/1/1988	\$150	\$10,200	\$10,350	

### Legal Disclaimer

Public information data is furnished by this office, and must be accepted and used by the recipient with the understanding that this office makes no warranties, expressed or implied, concerning the accuracy, completeness, reliability, or suitability of this data. Furthermore, this office assumes no liability whatsoever associated with the use or misuse of such data. Any errors or omissions should be reported for investigation.

Print -

Property Information					
<b>Property Number</b>	07-00287.000		<b>Property Address:</b> 111 KIRK ST  HOLLOWAY OH  <b>Tax Payer Address:</b> JONES MARY LOUISE 3834 WORCHESTER LN MEDINA OH 44256 USA		
<b>Owner Name</b>	JONES MARY LOUISE				
<b>Owner Address</b>	3834 WORCHESTER MEDINA OH 44256				
<b>Tax Set</b>	07 HOLLOWAY CORPORATION				
<b>School District</b>	707 Union LSD 2				
<b>Neighborhood</b>	24000 HOLLOWAY CORP				
<b>Use Code</b>	500 Residential vacant land				
<b>Acres</b>	.00000				
<b>Description</b>					
INLOT 43 D ADD 135 X 40					
		<b>Current Value</b>	<b>Recent Transfer</b>		
<b>Board of Revision</b>	N	<b>Mkt Land Value</b>	\$460	<b>Valid Sale</b>	Y
<b>Homestead/Disability</b>	N	<b>CAUV</b>	\$0	<b># Parcels</b>	1
<b>2.5% Reduction</b>	N	<b>Mkt Impr Value</b>	\$0	<b>Deed Type</b>	0
<b>Divided Property</b>	N	<b>Total</b>	\$460	<b>Amount</b>	\$0
<b>New Construction</b>	N	<b>Current Tax</b>		<b>Sale Date</b>	1/1/1987
<b>Foreclosure</b>	N	<b>Annual Tax *</b>	\$8.51	<b>Conveyance/Deed</b>	0
<b>Other Assessments</b>	N	<b>Paid **</b>	\$0.00	<b>Map #</b>	9
<b>Front Ft.</b>	0	<b>Delq</b>	\$8.77		
<< Previous Card      Card 1 of 0      Next Card >>					

Land								
Land Type	Acres	Square Ft.	Actual Frontage	Eff. Frontage	Depth	No Of Units	Adjusted Rate	Value
FRFront Lot [DEPTHC]	0.12	0	40.00	40.00	135.00	0	\$10	\$420

CAUV Land Lines

No CAUV Land On This Parcel

Card - 1

Improvements				
IMPR Type	Description	Area	Year Built	Value
No Improvements Found				



Card - 1

Property Sketch -- Card 1

Property Sketch



Print Version

**TaxDetail**  
**Belmont County Auditor**  
**Tax Detail Screen**

<b>Current Owner(s)</b>	JONES MARY LOUISE					
<b>Billing Address</b>	JONES MARY LOUISE 3834 WORCHESTER LN  MEDINA OH 44256 USA					
<b>Tax District</b>	07 HOLLOWAY CORPORATION					
	<b>Full Rate</b>	73.950000	<b>Assessed Value</b>			
	<b>Reduction Factor</b>	0.246209	<b>Land</b>	\$160.00		
	<b>Effective Rate</b>	55.742858	<b>Improvements</b>	\$0.00		
	<b>Certified Delq Year</b>	0	<b>Total</b>	\$160.00		
	<b>Tax Lien Flag</b>	N	<b>Annual Tax Due</b>	<b>Paid to Date</b>		
			<b>\$8.51</b>	<b>\$0.00</b>		
<b>Current Tax Year Detail</b>						
	<b>Prior</b>		<b>1st Half</b>		<b>2nd Half</b>	
	<b>Chg</b>	<b>Adj</b>	<b>Chg</b>	<b>Adj</b>	<b>Chg</b>	<b>Adj</b>
<b>Orig Tax</b>	\$7.52	\$0.00	\$5.92	\$0.00	\$5.92	\$0.00
<b>Reduction</b>			\$1.46	\$0.00	\$1.46	\$0.00
<b>Subtotal</b>	\$7.52		\$4.46		\$4.46	
<b>Rollback</b>			\$0.41	\$0.00	\$0.41	\$0.00
<b>2.5% RB</b>			\$0.00	\$0.00	\$0.00	\$0.00
<b>Homestead</b>			\$0.00	\$0.00	\$0.00	\$0.00
<b>Net Tax Due</b>	\$7.52		\$4.05		\$4.05	
<b>Penalty/Int</b>	\$1.25	\$0.00	\$0.00	\$0.41	\$0.00	\$0.00
<b>Tax Due</b>	\$8.77		\$4.46		\$4.05	
<b>Tax Paid</b>	\$0.00		\$0.00		\$0.00	
<b>Assess. Due</b>	\$0.00		\$0.00		\$0.00	
<b>Assess. Paid</b>	\$0.00		\$0.00		\$0.00	
<b>Total Owed</b>	\$8.77		\$4.46		\$4.05	
<b>Total Paid</b>	\$0.00		\$0.00		\$0.00	
<b>Balance Due</b>	\$8.77		\$13.23		\$17.28	

## SpecialAssessments

### DETAIL OF SPECIAL ASSESSMENT

No Special Assessments Found.

## Payments

### PAYMENT INFORMATION

<b>Date</b>	<b>Half</b>	<b>Prior</b>	<b>1st Half</b>	<b>2nd Half</b>	<b>Receipt#</b>
02/19/14	1-13	\$0.00	\$0.00	\$3.81	tms05-02192014-67-2
02/19/14	1-13	\$0.00	\$3.81	\$0.00	tms05-02192014-67-2
01/29/13	1-12	\$0.00	\$0.00	\$3.73	kjc01-01292013-19-2
01/29/13	1-12	\$0.00	\$3.73	\$0.00	kjc01-01292013-19-2

Transfer History					
Date	Sale Amount	To	Transfer Type	Conveyance	#Parcels
01/01/1987	\$0	JONES MARY LOUISE	Change Owner	0	1

Value History					
Reason	Date	Land	IMPR	Total	
Reappraisal, Update or Annual Equalization	8/28/2012	\$420	\$0	\$420	
Reappraisal, Update or Annual Equalization	1/1/2006	\$420	\$0	\$420	
Reappraisal, Update or Annual Equalization	1/1/2000	\$420	\$0	\$420	
Reappraisal, Update or Annual Equalization	1/1/1997	\$380	\$0	\$380	
Reappraisal, Update or Annual Equalization	1/1/1994	\$360	\$0	\$360	
Reappraisal, Update or Annual Equalization	1/1/1993	\$310	\$0	\$310	
Reappraisal, Update or Annual Equalization	1/1/1988	\$310	\$0	\$310	

**Legal Disclaimer**

Public information data is furnished by this office, and must be accepted and used by the recipient with the understanding that this office makes no warranties, expressed or implied, concerning the accuracy, completeness, reliability, or suitability of this data. Furthermore, this office assumes no liability whatsoever associated with the use or misuse of such data. Any errors or omissions should be reported for investigation.