

# Ashtabula County, Ohio - Property Record Card

Parcel: 030300002300 Card: 1

Owner MCFARLAND LARRI AMY  
Address 3225 RIDGEWOOD  
Land Use (510)  
Class RESIDENTIAL  
Legal Description 23 & 24 SUB GDNS  
Range Township Section 0-BU-0

## MAP

## SKETCH

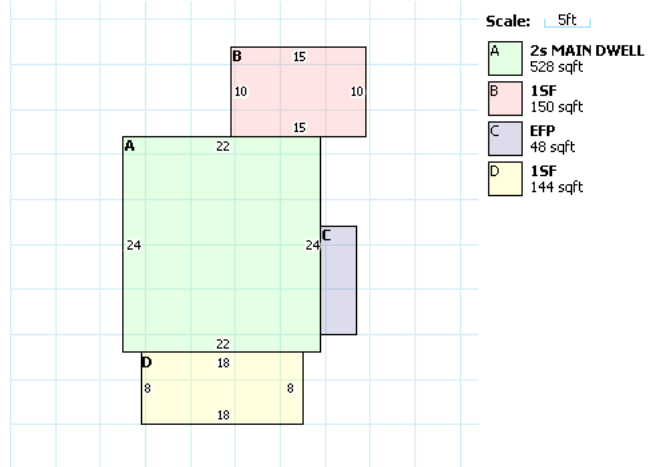

## RESIDENTIAL

Building Style	OLD STYLE	FullBaths	1
Sq.Ft.	1350	Half Baths	1
Year Built	1927	Basement	FULL BASEMENT
Stories	2	Basement Area	0
Exterior Wall	1/6 BR TO FR	Rec Room Area	0
Rooms	5	Heat Fuel Type	
Bedrooms	2	Heat/Cool	HEAT PUMP
Family Rooms	0	Attic	NONE
Fireplace Openings(Stacks)	0(0)	Trim	0

## LAND

Code	Frontage	Depth	Acreage	SqFt	Value
1	57	260	N/A	N/A	\$12,350.00

## VALUATION

	Appraised	Assessed
Land Value	\$12,400.00	\$4,340.00
Building Value	\$55,700.00	\$19,500.00
Total Value	\$68,100.00	\$23,840.00
CAUV Value		\$0.00
Taxable Value		\$23,840.00

## PERMITS

## IMPROVEMENTS

Card	Description	Year Built	Dimensions	Value
1	RG1 - FRAME OR CB	1965	22x22	\$1,900.00
1	RC2 - CANOPY	1965	10x22	\$400.00
1	RG1 - FRAME OR CB	1965	12x22	\$1,600.00
1	RS1 - FRAME UTILITY	1111	0x0	\$0.00

## SALES

Date	Buyer	Seller	Price	Validity
3/30/2001	MCFARLAND LARRI	CLAYTON LORRAINE	\$73,000.00	U NOT VALIDATED