

BRENDA MOSSBARGER

Fayette County Auditor | Fayette County, Ohio



SUMMARY

Deeded Name	DECK LINDA K TRUSTEE	Taxpayer	DECK LINDA K TRUSTEE
Owner	DECK LINDA K TRUSTEE 111 HESS RD WASHINGTON COURT HOUSE OH 43160-8603		111 HESS RD WASHINGTON COURT HOUSE OH 43160-8603
Tax District	190-UNION TWP-MIAMI TRACE LSD	Land Use	510-SINGLE FAMILY DWELLING
		Class	Residential
School District	MIAMI TRACE LSD	Subdivision	
Neighborhood	19000-UNIONTWP	Legal	PLANTATION PLACE 197X553.60
Location	111 HESS RD NE LOT 8		
CD Year		Map Number	Routing Number
Acres	2.5050	Sold	08/21/1995
			Sales Amount 0.00

VALUE

District	190-UNION TWP-MIAMI TRACE LSD	
Land Use	510-SINGLE FAMILY DWELLING	
Enrolled Programs	-Homestead--Owner Occupancy-	
	Appraised	Assessed
Land	51,600	18,060
Improvement	199,300	69,760
Total	250,900	87,820
CAUV	N	0
Homestead	Y	29,000
OOC	Y	250,900
Taxable	250,900	87,820

CURRENT CHARGES

Full Rate	54.320000			
Effective Rate	44.984924			
Qualifying Rate	38.097338			
	Prior	First	Second	Total
Tax	0.00	1,562.07	1,562.07	3,124.14
Special	0.00	0.00	0.00	0.00
Total	0.00	1,562.07	1,562.07	3,124.14
Paid	0.00	1,562.07	0.00	1,562.07
Due	0.00	0.00	1,562.07	1,562.07

TRANSFER HISTORY

Date	Deed Type Volume / Page	Sales Amount Conveyance #	Valid Exempt	# of Properties
08/21/1995	BUYER: DECK LINDA K TRUSTEE SELLER: NOT ON FILE	0.00 1995000821	N	1

LAND

Type	Dimensions	Description	Value
L1-FRONT LOT	197.0000 X 554.0000	Effective - Frontage / Depth	51,600
		Total	51,600

DWELLING

Card 1	Style	1-CONVENTIONAL	Family Rooms	1	Heating	Y
	Stories	1.00	Condition	A-AVERAGE	Cooling	N
	Rec Room Area	0	Year Built	1978	Grade	C
	Finished Basement	0	Year Remodeled		Fireplace Openings	0
	Rooms	7	Full Baths	1	Fireplace Stacks	0
	Bed Rooms	4	Half Baths	1	Living Area	2,246
	Dining Rooms	0	Other Fixtures	0	Total Area	2,246
					Value	180,500

OTHER IMPROVEMENT

Card Type	Year Built	Year Remodeled	Condition	Dimensions	Description	Size	Value
1 01-GARAGE DETACHED	1992		F-FAIR	41 X 26	Length x Width (Optional)	1,066	18,800
					Total		18,800

SKETCH

Card 1

Floor	Floor Area (ft ²)	Living Area (ft ²)
First Floor	2,246	2,246
Total	2,246	2,246

1

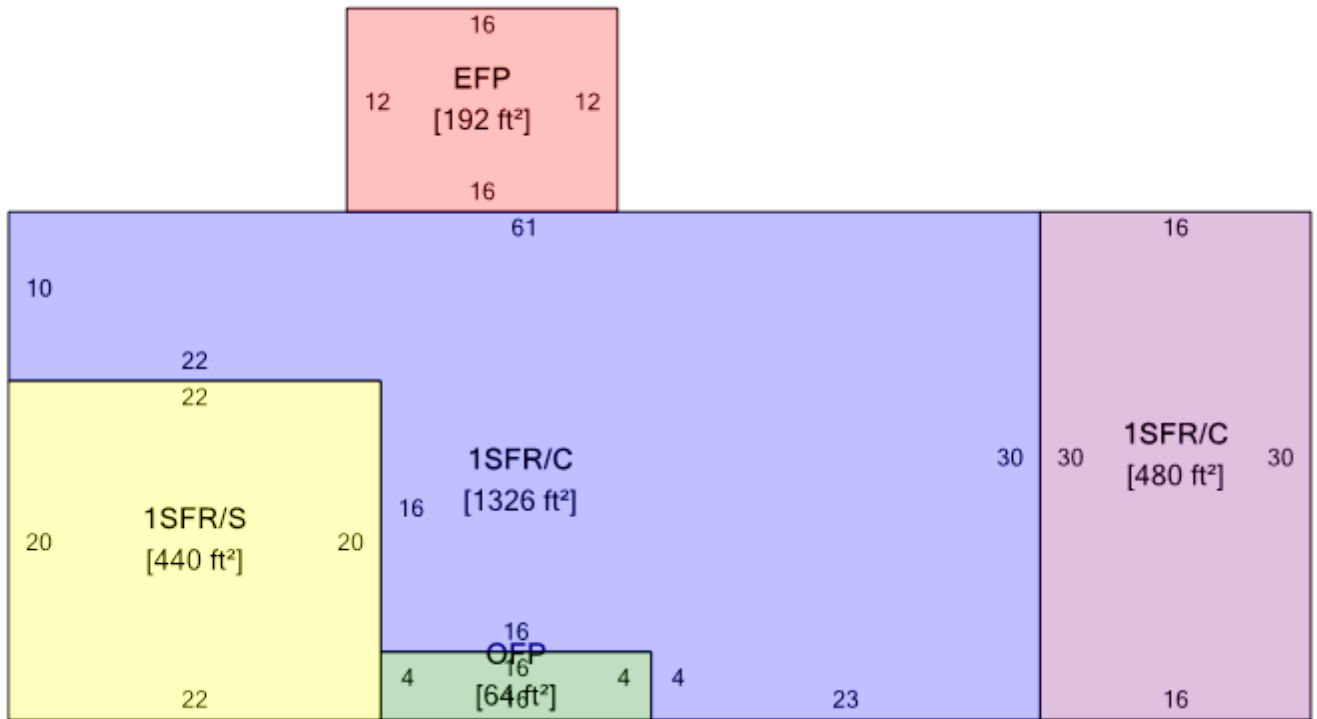

Fayette County Ohio GIS



4/6/2026, 12:48:56 PM

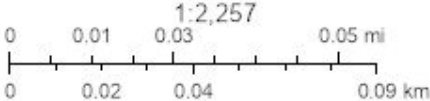

- Political Boundaries
- Tax Parcels
- Detailed Drainage
- Ephemeral Flowline
- Roads
- T
- U

Fayette County Ohio GIS, Microsoft, Vantor