

**Owner** ALIARSE HOLDINGS LLC  
**Address** 3219 EAST OVERLOOK RD  
 CLEVELAND HEIGHTS, OH. 44118  
**Land Use** (5100) R - 1-FAMILY PLATTED LOT  
**Description** 16 EP 192.70 FT E OF LEE RD  
**Neighborhood Code** 12207

### SKETCH

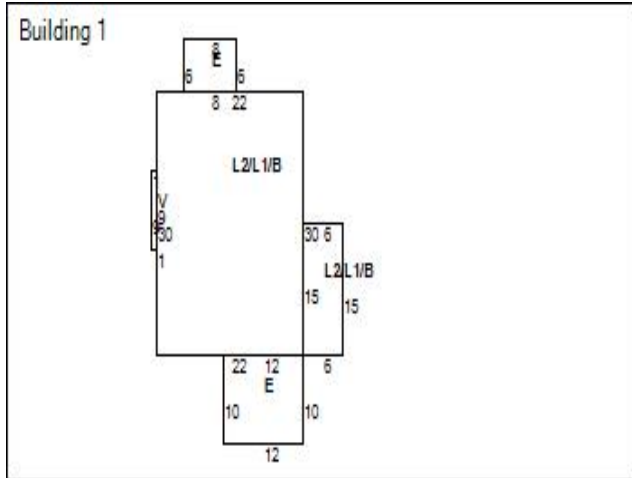

### MAP VIEW

 Map Image

### BUILDING INFORMATION

Building Record Number	1	Occupancy	1-FAMILY	Story Height	2
Style	COLONIAL	Year Built	1920	Exterior Walls	ALUM/VINYL
Condition	AVERAGE	Construction Quality	C / AVERAGE	Roof Type	GABLE
Roof Material	ASPH-SHINGLE	Heat Type	FORCED-AIR	Air Conditioning	NONE
Attic Type	NONE	Basement Type	BASEMENT	Basement Square Feet	750
Basement Finished	No	Rooms	8	Bedrooms	3
Bathrooms (Full/Half)	1/0	Garage Type	DETACHED	Garage Capacity	2
Year Garage Built	2000	Garage Size	400	Living Area Basement	
Living Area 1	759	Living Area 2	759	Living Area Upper	
Living Area Total	1,509	Floor Location		Party Wall	

### LAND

Code	Frontage	Depth	Acreage	Sq Ft
PRM	46	150	0.13	5,750

### IMPROVEMENTS

Type	Description	Size	Height Depth
------	-------------	------	--------------

### SALES

Date	Buyer	Seller	Price
11/3/2023	ALIARSE HOLDINGS LLC	SMILER, JANICE M.	\$111,700
1/16/2009	SMILER, JANICE M.	DEUTSCHE BANK NATIONAL TRUST COMPANY	\$23,625
9/12/2007	DEUTSCHE BANK NATIONAL TRUST COMPANY	4 SEASONS INVESTERS LLC	\$86,667
8/14/2006	4 SEASONS INVESTERS LLC	BURTON, FRANCES	\$0
1/24/2006	BURTON, FRANCES	GESIS, ERIC & INNA	\$170,000
11/10/2005	GESIS, ERIC & INNA	WACHOVIA BANK NA	\$85,000
11/10/2005	WACHOVIA BANK NA	Solsberry, Tyreto	\$80,000
12/31/2001	Solsberry, Tyreto	S.M.J. Growth Corporation	\$109,000
12/20/1999	S.M.J. Growth Corporation	Keybank Natl Assn	\$0
12/7/1999	Keybank Natl Assn	Jones, Josephine M.	\$63,000
6/7/1996	Jones, Josephine M.	Martez Corp	\$79,900
5/7/1996	Martez Corp	Woodard Eleanor E	\$45,000
6/7/1982	Woodard Eleanor E	Woodard Robert	\$0
6/16/1977	Woodard Robert	Roth Arnold A & Phyllis S	\$27,900
1/1/1975	Roth Arnold A & Phyllis S		\$0