



Cuyahoga County, Ohio - Property Summary Report

Parcel: 111-16-097



Owner CARTER, MOSHIA
Address 12702 GRUSS AVE
CLEVELAND, OH. 44108
Land Use (5200) R - 2-FAMILY PLATTED LOT
Description 358 SOUTHERN S/L 273 EP 0272 WP
Neighborhood Code 01114

SKETCH

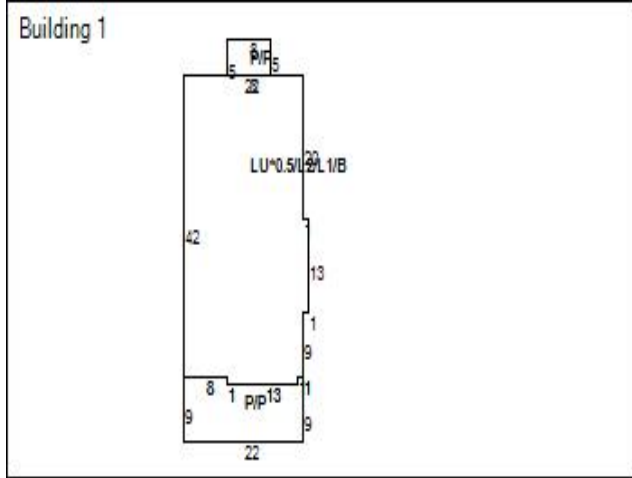

MAP VIEW



CEGIS, CCFO

BUILDING INFORMATION

Building Record Number	1	Occupancy	2-FAMILY	Story Height	2
Style	COLONIAL	Year Built	1917	Exterior Walls	ALUM/VINYL
Condition	FAIR	Construction Quality	C / AVERAGE	Roof Type	GABLE
Roof Material	ASPH-SHINGLE	Heat Type	FORCED-AIR	Air Conditioning	NONE
Attic Type	UNFINISHED	Basement Type	BASEMENT	Basement Square Feet	950
Basement Finished	No	Rooms	10	Bedrooms	4
Bathrooms (Full/Half)	2/0	Garage Type	NONE	Garage Capacity	
Year Garage Built		Garage Size		Living Area Basement	
Living Area 1	950	Living Area 2	950	Living Area Upper	
Living Area Total	1,900	Floor Location		Party Wall	

LAND

Code	Frontage	Depth	Acreage	Sq Ft
PRM	34	100	0.08	3,400

VALUATION

2023 Values	Taxable Market Value	Exempt Market Value	Abated Market Value	Assessed Taxable Value
Land Value	\$4,900	\$0	\$0	\$1,720
Building Value	\$26,700	\$0	\$0	\$9,350
Total Value	\$31,600	\$0	\$0	\$11,070
Land Use	5200			TWO FAMILY DWELLING

PERMITS

Tax Year	Reason	Tax Change	Exempt Change	Percent Complete	Reinspect	Notes
----------	--------	------------	---------------	------------------	-----------	-------

IMPROVEMENTS

Type	Description	Size	Height Depth
------	-------------	------	--------------

SALES

Date	Buyer	Seller	Price
8/2/1994	Carter, Moshia	Carter John	\$0
7/28/1978	Carter John	Adm Veterans Affairs	\$0
3/29/1977	Adm Veterans Affairs	Armistead Nathan	\$0
1/1/1975	Armistead Nathan		\$0

Taxes

2023 Taxes	Charges	Payments	Balance Due
Tax Balance Summary	\$889.83	\$424.00	\$465.83