

Perry County, Ohio - Property Record Card, Page 1

Parcel: 100005190000

Map Number: 00040126900

GENERAL PARCEL INFORMATION

Owner	DENNIS TOMMY L II
Property Address	228 CROWLEY ST OH
Mailing Address	DENNIS TOMMY
	228 CROWLEY ST
	ROSEVILLE OH 43777 1032
Land Use	510 SINGLE FAMILY DWELLING - PLATTED LOT
Legal Description	70 FT FRONTLOT 11
	SEC 00
School District	FRANKLIN LSD
Tax District	10 ROSEVILLE FRANKLIN LSD

VALUATION

	Appraised	Assessed
Land Value	\$13,230.00	\$4,630.00
Improvements Value	\$77,420.00	\$27,100.00
Total Value	\$90,650.00	\$31,730.00
Taxable Value	\$31,730.00	
Net Annual Tax:	\$1,187.52	
Tot Amt Collected:	(\$593.76)	

RESIDENTIAL

Number Of Stories	1
Year Built	1956
Year Remodelled	
Grade	C
Condition	A
Occupancy	SINGLE FAMILY
Construction	
RoofType	
RoofMaterial	
Total Area	1200
Living Area	1200
Finished Basement Area	0
Air Conditioned Area	1200
Unheated Area	0
Total Rooms	4
Total Bedrooms	2
Total Full Baths (Including Base Plumbing)	1
Total Half Baths	0
Extra Plumbing Fixtures	0
Value	\$77,420.00

SKETCH

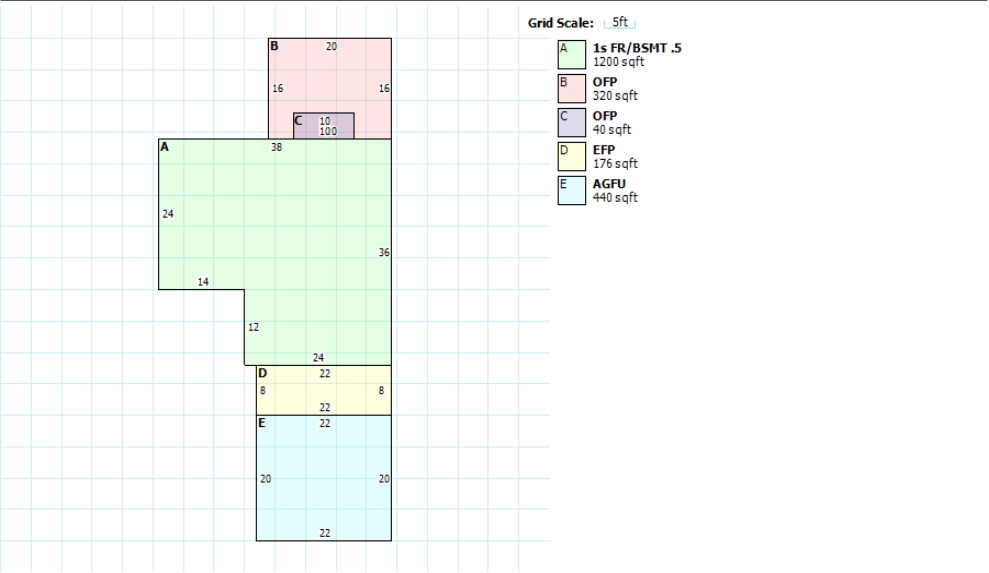

RESIDENTIAL DETAIL

Floor	Area	Construction	Rooms	Bedrooms	Full Baths	Half Baths	Fireplaces
BSMT	600		0	0	0	0	0
1	1200	FR	4	2	1	0	1

IMPROVEMENTS

Description	Stories	Area	Grade	Year Built	Value
-------------	---------	------	-------	------------	-------

Perry County, Ohio - Property Record Card, Page 2

Parcel: 100005190000

Map Number: 00040126900

LAND						
Code	Frontage	Depth	Rate	Total	Value	Acres
F - FRONT	70	120/0	210	\$13,230.00	\$13,230.00	0.1928

AGRICULTURAL								
Code	Soil	Acres	Rate	Appraised	Assessed	CAUV Rate	CAUV Value	Taxable
Totals:								

SALES				
Sale Date	Sale Amount	Buyer	Conv.	Notes
2/23/2007	\$0.00	DENNIS TOMMY L II	0	
10/19/2006	\$0.00	SECRETARY OF HOUSING	0	
1/2/2001	\$82,390.00	FARLEY ERNEST P	8	
2/9/1999	\$0.00	BATES RICHARD D	0	
8/10/1995	\$54,900.00	BATES RICHARD D	520	
11/4/1994	\$0.00	WILLIAMS ERLE T	0	

COMMENTS	
Type	Description