

Summary

Parcel Number 57-02336.000
Map Number 57114159012
Location Address 911 THIRD
Legal Acres 0.0000
Legal Description 10THIRD ST WH 12 WEST 33'
 (Note: Not to be used on legal documents.)
Neighborhood 5755753-SSIDE 1ST-2ND-4TH-NSIDE 5TH
Tax District 55-SANDUSKY CITY
School District SANDUSKY CSD
Homestead Reduction NO
Owner Occupancy Credit YES
Foreclosure NO
Land Use 510-SINGLE FAMILY DWELLING
 (Note: Land Use is for valuation purposes only. Consult the local jurisdiction for zoning and legal use.)

[Download Land Use descriptions](#)

Notes

Map Number: 006
Personal Property District: 22-0320

Owners

Owner Address	Tax Payer Address
MANION MITCHELL J	MANION MITCHELL J
911 THIRD STREET	911 THIRD STREET
SANDUSKY OH 44870	SANDUSKY OH 44870

Land

Land Type	Calculated Acres	Actual Frontage	Effective Frontage	Depth	Depth Factor	Unit Rate	Appraised Value (100%)
F-FRONT LOT [DEPTHA]	0.25152	83	83	132	94%	250	\$19,510
Total	0.2515						\$19,510

Dwellings

Card 1	Heating Central Heat
Number of Stories 1	Cooling Central AC
Style 01-SINGLE FAMILY	Basement FULL
Year Built 1920	Attic 0
Year Remodeled 0	Finished Living Area 1218
Rooms 7	First Floor Area 1218
Bedrooms 3	Upper Floor Area 0
Full Bath 1	Half Floor Area 0
Half Bath 0	Finished Basement Area 0
Family Rooms 0	Total Basement Area 224
Dining Rooms 0	Fireplace Openings 0
Grade C+	Fireplace Stack Count 0
Grade Adjustment 110.00	Value
Condition AV-AVERAGE	

Additions

Card 1

Line	Description	Area	Appraised Value (100%)
1	P-PATIO (ATTCH)	60	\$1,080
2	OFF-OPEN FR PORCH	60	\$1,200
3	WDDK-WOOD DECK	120	\$1,800
4	OFF-OPEN FR PORCH	65	\$1,300
5	OFF-OPEN FR PORCH	300	\$6,000

Improvements

Card 2

Description	Dimensions	Area	Year Built	Appraised Value (100%)
DGARCB-DETACHED GARAGE CONCRETE BLOCK	28 x 26	728	1920	\$5,940
Total				\$5,940

Card 3

Description	Dimensions	Area	Year Built	Appraised Value (100%)
DGARFR-DETCH FR GARAGE	18 x 14	252	1920	\$2,570
Total				\$2,570

Appraised Value

If the value information is unavailable or does not display, it may be due to this being a new parcel and the information will be available in a future year. If you have questions please contact the Erie County Auditor's Office by email at ecao@eriecounty.oh.gov or by phone at (419) 627-7746.

Assessed Year	2023	2022	2021	2020	2019
Land Value	\$19,510	\$19,510	\$19,510	\$19,510	\$19,510
CAUV Value	\$0	\$0	\$0	\$0	\$0
Improvements Value	\$79,030	\$79,030	\$79,030	\$59,580	\$59,580
Total Value (Appraised 100%)	\$98,540	\$98,540	\$98,540	\$79,090	\$79,090

Taxable Value (35% of Appraised Value)

If the value information is unavailable or does not display, it may be due to this being a new parcel and the information will be available in a future year. If you have questions please contact the Erie County Auditor's Office by email at ecao@eriecounty.oh.gov or by phone at (419) 627-7746.

Assessed Year	2023	2022	2021	2020	2019
Land Value	\$6,830	\$6,830	\$6,830	\$6,830	\$6,830
CAUV Value	\$0	\$0	\$0	\$0	\$0
Improvements Value	\$27,660	\$27,660	\$27,660	\$20,850	\$20,850
Total Value (Assessed 35%)	\$34,490	\$34,490	\$34,490	\$27,680	\$27,680

Tax History

Tax Year (click for detail)	Prior Charges	Full Year Total	Payments	Uncollectable	Half Year Due	Full Year Due
2023 Pay 2024	\$0.00	\$1,722.44	\$861.22		\$0.00	\$861.22
2022 Pay 2023	\$0.00	\$1,709.90	\$1,709.90		\$0.00	\$0.00
2021 Pay 2022	\$0.00	\$1,725.78	\$1,725.78		\$0.00	\$0.00

For tax bills and related information, please visit the Erie County Treasurer's website by [clicking here](#)

Payments

Payment Date	Amount Paid
2/14/2024	\$861.22
7/6/2023	\$854.95
2/8/2023	\$854.95
7/13/2022	\$862.89
2/14/2022	\$862.89
7/9/2021	\$753.57
2/8/2021	\$753.57
7/7/2020	\$792.00
2/6/2020	\$792.00
4/26/2019	\$792.85
2/8/2019	\$792.85
7/10/2018	\$736.22
2/15/2018	\$736.22
6/29/2017	\$720.01
2/8/2017	\$720.01
7/1/2016	\$650.04
2/9/2016	\$650.04

Sales

Sale Date	Sale Price	Seller	Buyer	No. of Properties
4/25/2019	\$113,500	RANDLEMAN VON & PENNY S	MANION MITCHELL J	1
12/6/2017	\$0	FERRELL PENNY S	RANDLEMAN VON & PENNY S	1
1/1/1987	\$0	UNKNOWN	FERRELL PENNY S	1

Recent Sales In Area

Sale date range:

From: 04/05/2021

To: 04/05/2024

Sales by Neighborhood

1500

Feet



Sales by Distance

Historical Grand List

[Browse all Erie County Historical Grand List Documents](#)

57-02336.000 (PDF)

Sketches

Note: Sketch items labeled O1 through O9 are **Other Improvements** and more detail about these items can be found under the **Improvements** tab. Click [HERE](#) for Sketch Codes and Descriptions

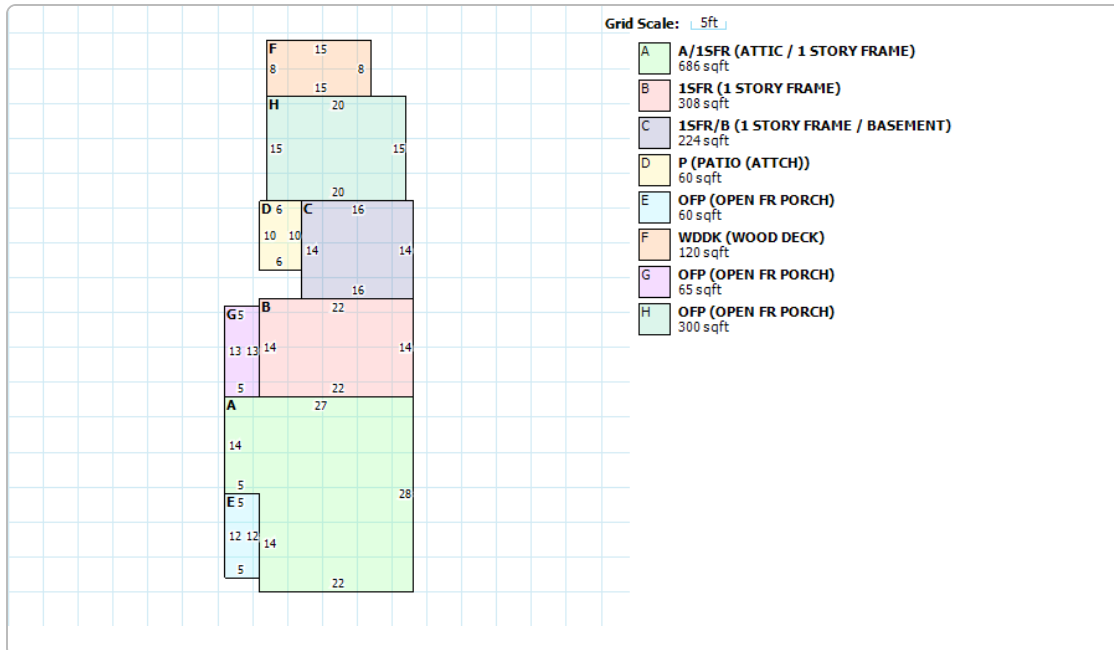

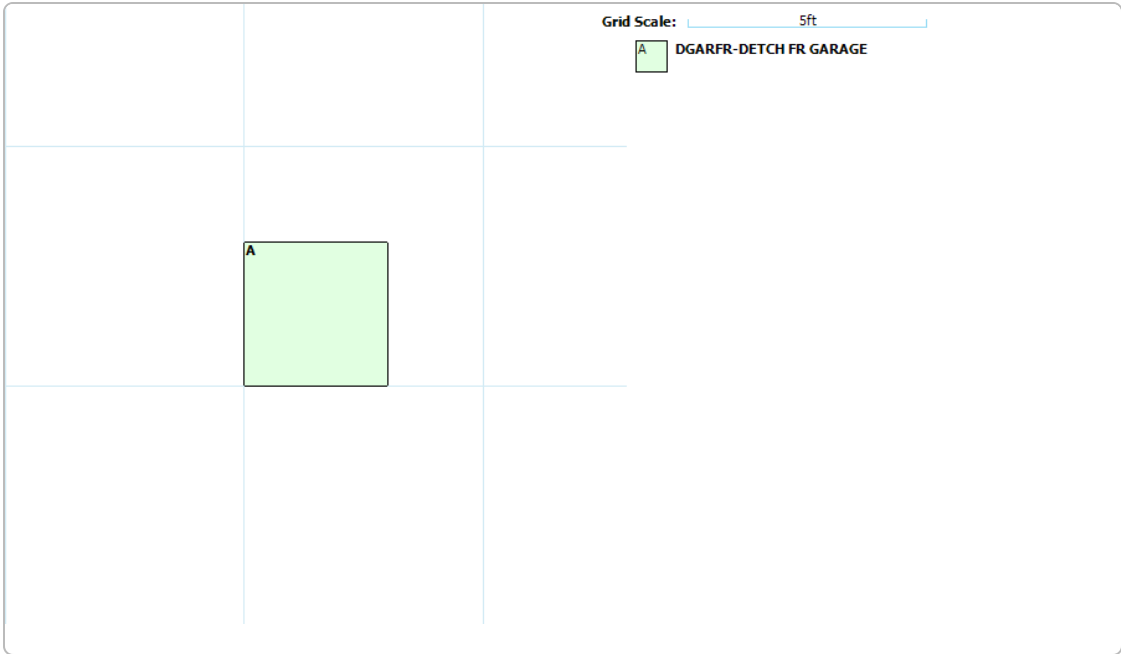
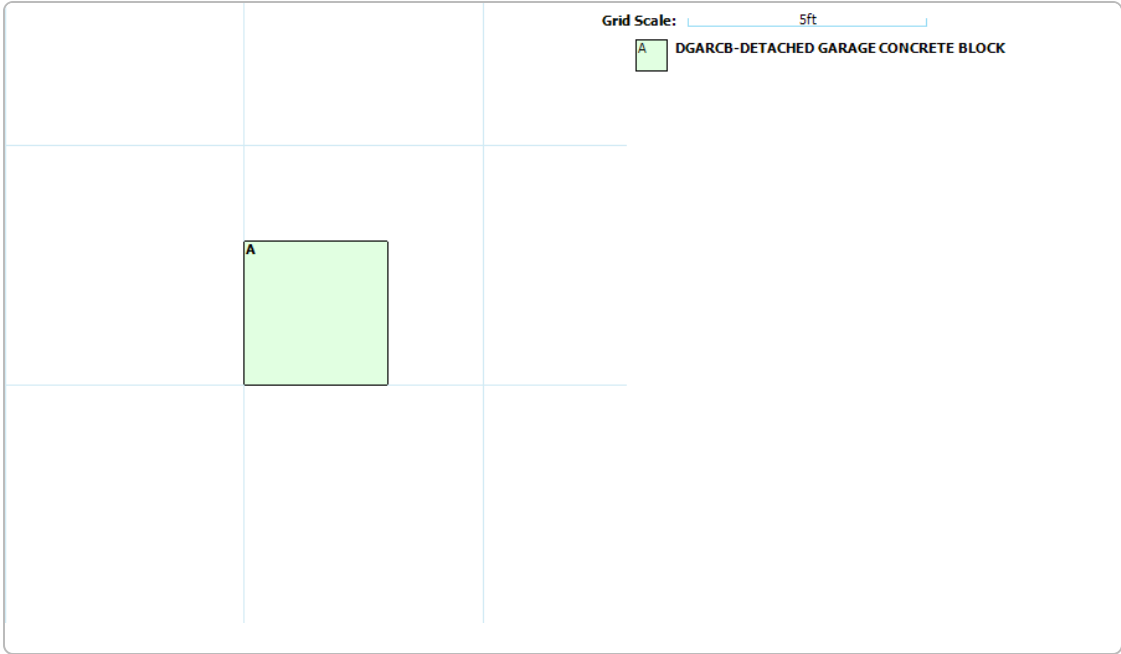

Map



Property Card

Property Card

No data available for the following modules: Buildings, Ag Soil, Special Assessments, Photos.

The information provided by Erie County is provided 'as is' and for reference only. The user expressly agrees that the use of Erie County's web site is at the user's sole risk. Erie County does not warrant that the service will be uninterrupted or error free. Any information published on this server could contain technical inaccuracies or typographical errors. Changes may be made periodically to the tax laws, administrative rules, tax releases and similar materials.
[| User Privacy Policy](#) | [| GDPR Privacy Notice](#)
[Last Data Upload: 4/5/2024, 8:50:24 AM](#)

Contact Us

Developed by
 **Schneider**
GEOSPATIAL