

Richland County, OH

Summary 2024

Parcel Number 0270402613000
Location Address 348 BOWMAN ST
 MANSFIELD 44903
Legal Description 3685 S PT 39 X 160.38
 (Note: Not to be used on legal documents.)
Property Class R - RESIDENTIAL
Land Use (510) R - SINGLE FAMILY DWELLING, PLATTED LOT
Neighborhood 02704009
Tax District 027
Acres 0
Sec/Twp/Rng --
Township MANSFIELD
School District MANSFIELD CITY SD
Municipality MANSFIELD
Topo ABOVE STREET
Utilities ALL PUBLIC
Roads PAVED, SIDEWALK
Traffic LIGHT



027-04-026-13-000 03/31/2021

[View Map](#)

Owners

Owner
 TATE MARY J
Mailing Address
 TATE MARY J
 348 BOWMAN ST
 MANSFIELD OH 44903

Valuation

Assessed Year	2023	2022	2021	2020
Land Value	\$1,390.00	\$1,270.00	\$1,270.00	\$1,270.00
Building Value	\$8,160.00	\$6,110.00	\$6,110.00	\$6,110.00
Total Value (Assessed 35%)	\$9,550.00	\$7,380.00	\$7,380.00	\$7,380.00
Land Value	\$3,980.00	\$3,620.00	\$3,620.00	\$3,620.00
Building Value	\$23,300.00	\$17,460.00	\$17,460.00	\$17,460.00
CAUV Value	\$0.00	\$0.00	\$0.00	\$0.00
Total Value (Appraised 100%)	\$27,280.00	\$21,080.00	\$21,080.00	\$21,080.00

Taxes Due

1st half 2023 taxes are due March 6, 2024.

Tax Year (click for detail)	1st Half Due	2nd Half Due	Delinquent	Total Due
⊕ 2023	\$0.00	\$408.29	\$0.00	\$408.29
⊕ 2022	\$0.00	\$0.00	\$0.00	\$0.00
⊕ 2021	\$0.00	\$0.00	\$0.00	\$0.00
⊕ 2020	\$0.00	\$0.00	\$0.00	\$0.00
⊕ 2019	\$0.00	\$0.00	\$0.00	\$0.00
⊕ 2018	\$0.00	\$0.00	\$0.00	\$0.00

Land

Descr	P	LN	CD	Acres	Frontage	Depth	Base Size	Base Rate	Sq ft.	Incr / Decr	Land-Val
Regular Lot	F	1	1	0.1433	39	160	200.00	99	6,240	49.5 / 99	\$3,980

Total Acres:
 0.1433
Total Land-Value:
 \$3,980

Residential Improvement Information

Card	1	Bathroom Remodeled	2
Stories	1.5	Kitchen Remodeled	2
Exterior Wall	FRAME	Total Rooms	5
Style	OLD STYLE	Bedrooms	2
Square Feet	833	Full Baths	1
Basement	FULL	Half Baths	0
Heating Fuel Type	GAS	Family Rooms	0
Physical Condition		Additional Fixtures	2
Attic	NONE	Total Fixtures	5
Year Built	1890	WBFP Stacks	0
Effective Year	0	Fireplace Openings	0
Year Remodeled	0	Prefab Fireplace	0

Additions

Card 1

Line	Lower	First	Second	Third	Area	Value
0		Main Building			476	0
1		11 - OFP OPEN FRAME PORCH			78	2,800
2		11 - OFP OPEN FRAME PORCH			140	5,000

Other Buildings & Yard Improvements

Card 1

Descr	Full Description	Type	Quantity	Year	Size	Area	Grade	Mods	Cond	F	MD%	Value
DET GARAGE	FRAME OR CB DETACHED GARAGE	RG1	1	1930	20 x 20	400	E -POOR		P		0	\$760

Sales

Date	Book	Page	Grantor	Grantee	Price	Instr Type	Sale Validity	Qualified
8/28/2007			FANNIE MAE	TATE MARY J	\$65,000	GW	VALID SALE	Qualified
7/7/2006			ERNSBERGER AMANDA G	FANNIE MAE	\$6,000	SD	SHERIFF SALE	Unqualified
5/20/2005			ERNSBERGER RICHARD	ERNSBERGER AMANDA G	\$0	QC	RELATED INDIVIDUALS OR CORPORATIONS	Unqualified
4/16/1999	699	584	ERNSERGER RICHARD	ERNSBERGER RICHARD	\$0		EXCESS PERSONAL PROPERTY/NOT ARMS LEN	Unqualified
4/16/1999			BOWMAN CHARLES A	ERNSERGER RICHARD	\$0		EXCESS PERSONAL PROPERTY/NOT ARMS LEN	Unqualified

Recent Sales in Area

Sale date range:

From: To:

Pay Property Taxes

Photos



027-04-026-13-000 03/31/2021



027-04-026-13-000 05/13/2016



027-04-026-13-000 05/15/2013

Sketches

To magnify the Sketch, you may right click on the image to download or to open the image in a new tab. These options will then allow you to zoom in.

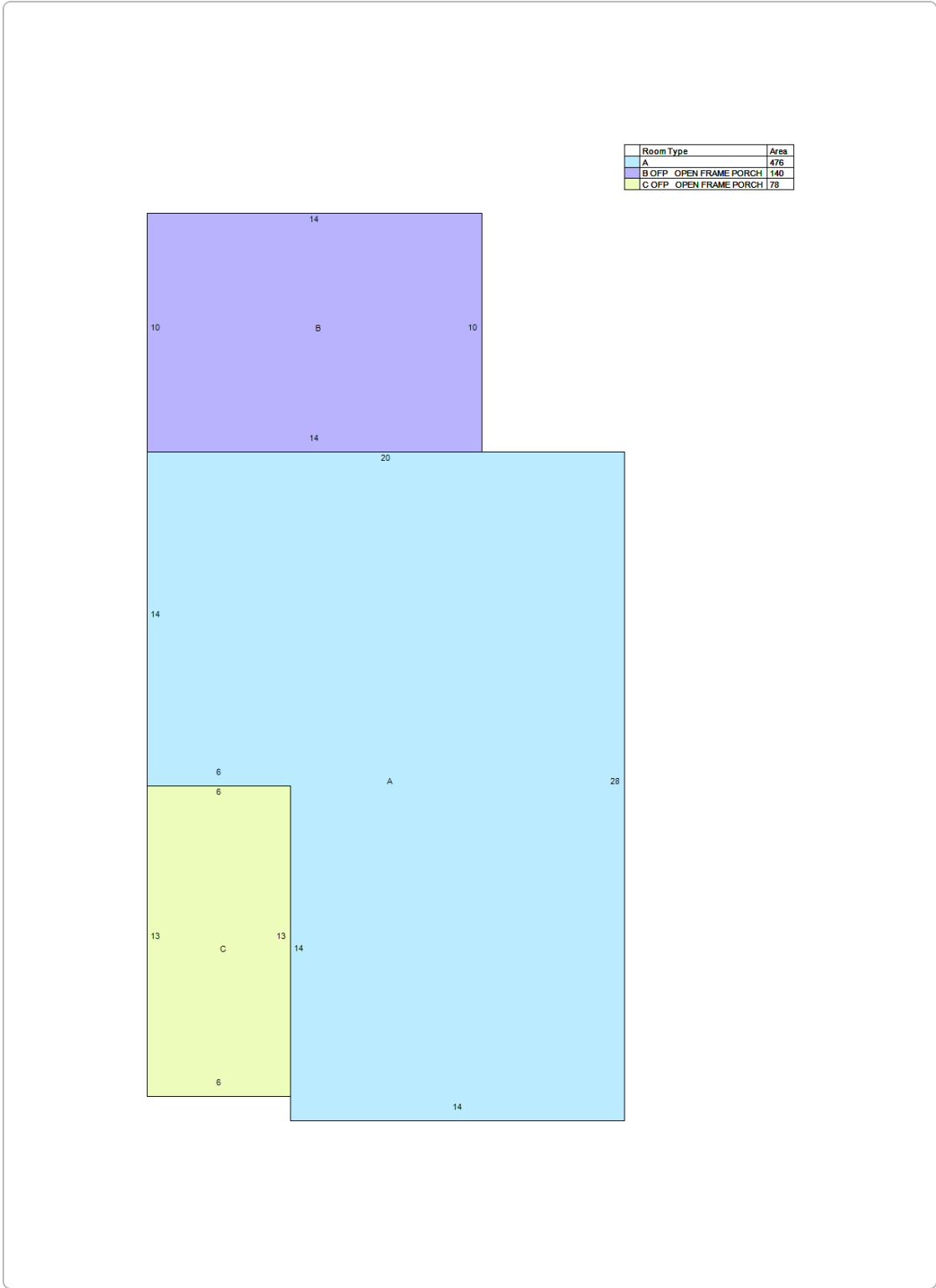

No data available for the following modules: Other Dwelling Features, Commercial Improvement Information, Interior/Exterior Information, Other Features, Permits.

The information displayed on this map is taken from public records, and is intended to be used as a reference. Map information is believed to be accurate, but accuracy is not guaranteed. Richland County makes no warranties, express or implied, concerning the accuracy, completeness, or reliability of this information, and assumes no liability or any other legal responsibility for the information contained on this map. The map does not represent the official survey of the land.

| [User Privacy Policy](#) | [GDPR Privacy Notice](#)
 Last Data Upload: 3/1/2024, 5:06:02 AM

Contact Us

