

Gallia County, Ohio - Property Record Card

Parcel: 00100182601 Card: 1

Owner PARTAIN CAROLYN
Address 2201 BULAVILLE PIKE
Land Use (511) R - SINGLE FAMILY, O-9.999 AC
Class RESIDENTIAL
Legal Description NE PT SE 1/4 V532 P700

MAP



SKETCH

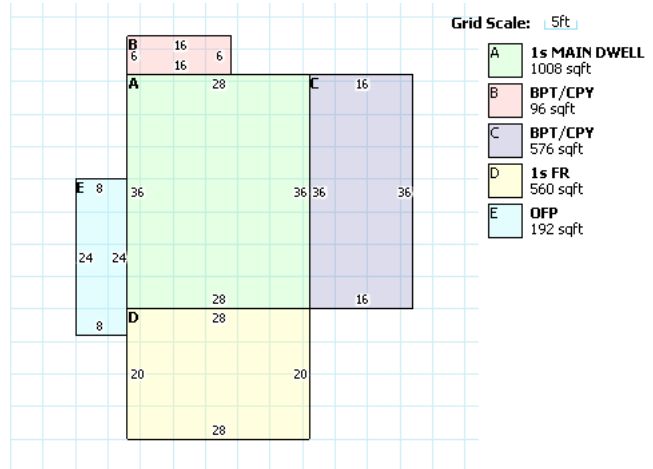

RESIDENTIAL

Building Style	RANCH	FullBaths	2
Sq.Ft.	1568	Half Baths	0
Year Built	1961	Basement	FULL
Stories	1	Basement Area	0
Exterial Wall	ALUMINUM/VINYL	Rec Room Area	800
Rooms	7	Heat Fuel Type	ELECTRIC
Bedrooms	3	Heat/Cool	HEAT PUMP
Family Rooms	1	Attic	NONE
Fireplace Openings(Stacks)	0(0)	Trim	196

LAND

Code	Frontage	Depth	Acreage	SqFt	Value
1	0	0	0.972	N/A	\$14,590.0

TENTATIVE 2011 VALUATION

	Appraised	Assessed
Land Value	\$14,590.00	\$5,110.00
Building Value	\$86,260.00	\$30,190.00
Total Value	\$100,850.00	\$35,300.00
CAUV Value	\$0.00	
Taxable Value	\$35,300.00	

PERMITS

IMPROVEMENTS

SALES

Date	Buyer	Seller	Price	Validity
3/11/2013	PARTAIN CAROLYN		\$69,900.00	5
12/20/201	FEDERAL NATIONAL MORTGAGE	LEWIS TANYA	\$105,145.005	
5/14/2007	LEWIS TANYA		\$109,575.008	UNVALIDATED
11/30/199	SHAW WILLIAM R &		\$69,500.00	0 VALID