

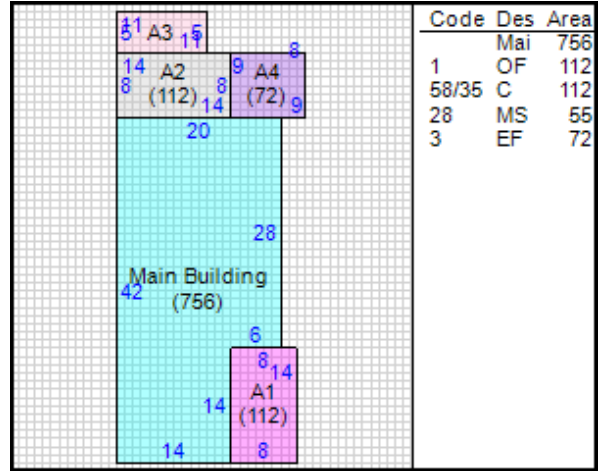

**Clark County GIS -**  
**John S. Federer**  
 (937) 521-1860 -  
 gis@clarkcountyohio.gov

Report generated: Wednesday, June 28, 2023

**Parcel Report**



**Base Data**

**Parcel Number:** 3400700035229007  
**Owner Name:** PETTICREW MELBA  
**Property Address:** 616 N MURRAY ST, SPRINGFIELD 45503  
**Percent Owned %:** 100

**Geographic**

**City:** SPRINGFIELD CORPORATION  
**Township:**  
**School District:** SPRINGFIELD CSD

**Legal**

**Neighborhood:** 340R0029 **Legal Acres:** 0.00  
**Legal Description:** ROGERS FAMILY, PLATTED LOT MID PT  
 1938 1940; **Map Number:** 0035-02  
**Class:** R

**Valuation**

	Appraised	Assessed (35%)
<b>Land Value:</b>	\$5,530.00	\$1,940.00
<b>Building Value:</b>	\$45,980.00	\$16,090.00
<b>Total Value:</b>	\$51,510.00	\$18,030.00
<b>CAUV Value:</b>	\$0.00	
<b>Taxable Value:</b>	\$18,030.00	

**Tax Credits**

**Homestead Exemption:** No  
**2.5% Reduction:** Yes

**Land**

Description	Effective Lot Size	Act. Frontage	Acres	Sq. Foot	Value
REGULAR LOT	40 * 100	40	0.092	4,000	5,530

**Land Totals**

**Effective Total Acres** 0.092  
**Effective Total Square Footage** 4,000  
**Total Value** \$5,530.00

**Valuation**

	<b>Appraised</b>	<b>Assessed (35%)</b>
<b>Land Value:</b>	\$5,530.00	\$1,940.00
<b>Building Value:</b>	\$45,980.00	\$16,090.00
<b>Total Value:</b>	\$51,510.00	\$18,030.00
<b>CAUV Value:</b>	\$0.00	
<b>Taxable Value:</b>	\$18,030.00	

**Sales**

<b>Sale Date</b>	<b>Sale Price</b>	<b>Seller</b>	<b>Buyer</b>	<b>Number of Parcels</b>
06/06/2006	\$46,900.00	BROWN BEVERLY S & RICHARD B	PETTICREW MELBA	
09/21/2004	\$0.00	SMITH ROLLAND H & HELEN MARIE	BROWN BEVERLY S & RICHARD B	

**Property Tax**

Tax Year 2022 Payable 2023.

	<b>First Half</b>	<b>Second Half</b>
<b>Gross Charge:</b>	\$814.70	\$814.70
<b>Reduction Factor:</b>	(\$313.94)	(\$313.94)
<b>Non-Business Credit:</b>	(\$44.59)	(\$44.59)
<b>Owner Occupancy Credit:</b>	(\$11.14)	(\$11.14)
<b>Homestead Reduction:</b>	\$0.00	\$0.00
<b>Net Tax Due:</b>	\$445.03	\$445.03
<b>Special Assessments:</b>	\$0.00	\$0.00
<b>Penalties And Adjustments:</b>	\$0.00	\$0.00
<b>Subtotals:</b>	\$0.00	\$445.03
<b>Interest:</b>	\$0.00	
<b>Prior Charges:</b>	\$0.00	
<b>Full Year Total:</b>	\$890.06	
<b>Payments:</b>	\$445.03	
<b>Half Year Due:</b>	\$0.00	
<b>Full Year Due:</b>	\$445.03	

**Residential**

**Card:** 1

**Style:** Old Style

**Year Remodeled:**

**Number of Bedrooms:** 3

**Number of Half Baths:** 0

**Basement:** Part BSMT

**Heating System Type:** HOT AIR

**Attic:** None

**Grade:** D

**Total Living Area:** 1,624

**Recreation Room Area:**

**Brick/Stone Trim:**

**Fireplace Openings:**

**Percent Complete:**

**Number of Stories:** 2

**Year Built:** 1911

**Total Number of Rooms:** 6

**Number of Full Baths:** 1

**Number of Family Rooms:** 0

**Exterior Wall:** FRAME

**Heat:** CENTRAL HEAT

**Heating Fuel Type:** GAS

**Ground Floor Area:** 868

**Unfinished Area:**

**Finished Basement Area:**

**Fireplace Stacks:**

**PreFab Fireplaces:**

**Photos**



3400700035229007 04/20/2017

**Sketches**

